

Last Saved By: mreed Printed: 12/17/22
 P:\1364 - Clear Creek Welcome Center\WORKS\SITE SHEETS\EB WELCOME CENTER\1364-EB-C200 GRADING PLAN.dwg Date: 01/20/23 4:30:42 pm

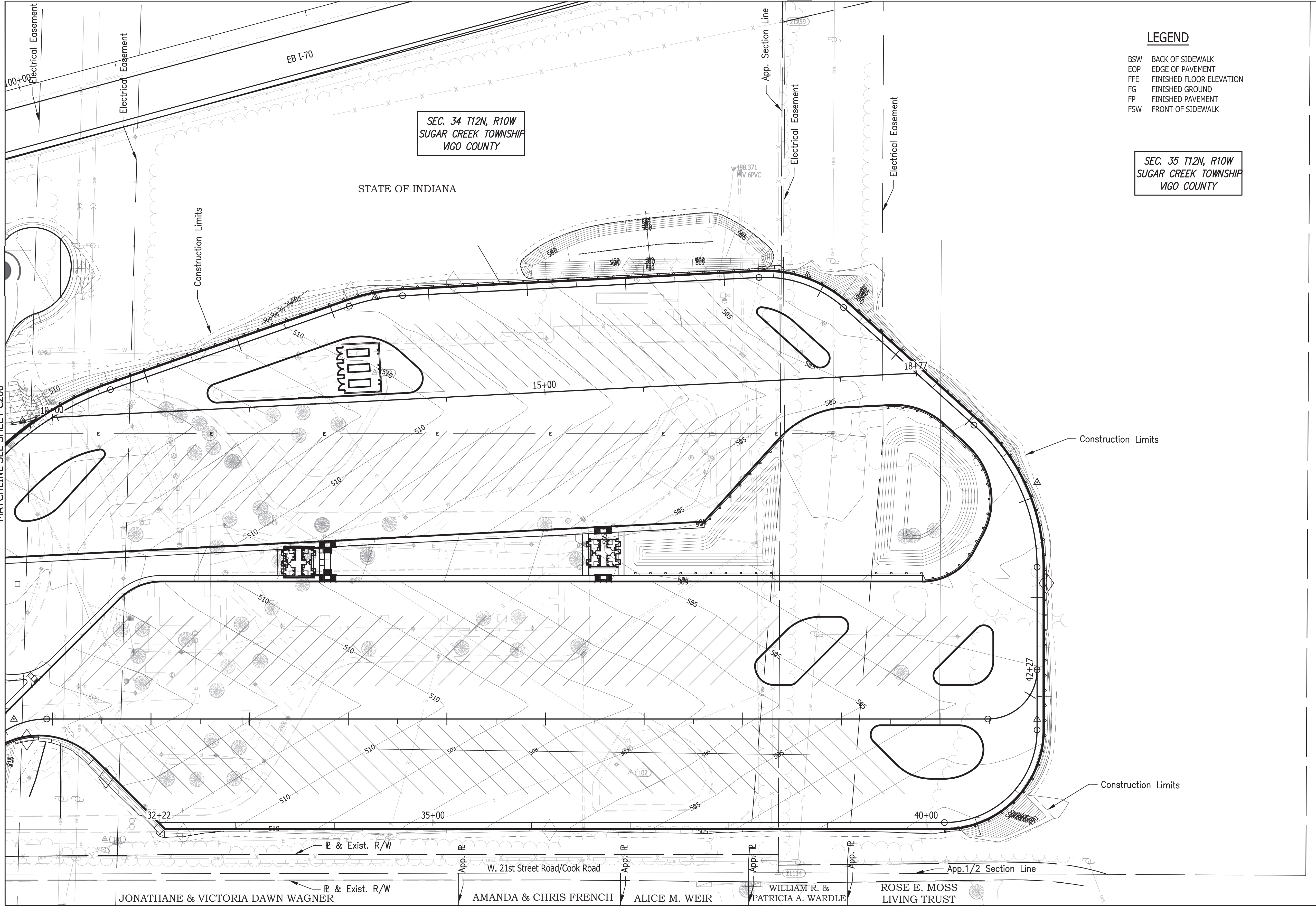

LEGEND

BSW	BACK OF SIDEWALK
EOP	EDGE OF PAVEMENT
FFE	FINISHED FLOOR ELEVATION
FG	FINISHED GROUND
FP	FINISHED PAVEMENT
FSW	FRONT OF SIDEWALK

SEC. 35 T12N, R10W
SUGAR CREEK TOWNSHIP
VIGO COUNTY

SEC. 34 T12N, R10W
SUGAR CREEK TOWNSHIP
VIGO COUNTY

STATE OF INDIANA

MATCHLINE SEE SHEET C200

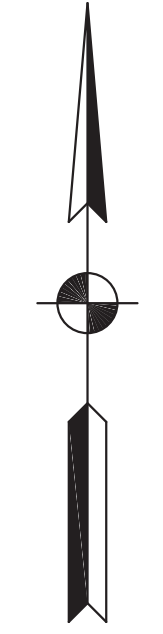
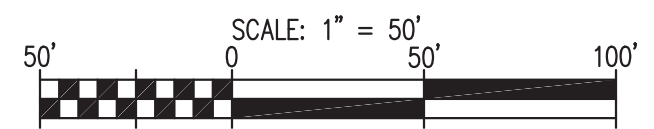

Certified by: Robert Gray

PUBLIC WORKS PROJECT NO. 84003001-22-058-C1
CLEAR CREEK WELCOME CENTER
VIGO COUNTY, INDIANA

STATE OF INDIANA
DEPARTMENT OF ADMINISTRATION
PUBLIC WORKS DIVISION
ROOM 9407, INDIANA GOVERNMENT CENTER SOUTH
402 WEST WASHINGTON STREET
INDIANAPOLIS, INDIANA 46204
317-232-3000

Revisions:	
Project Number:	84003001-22-058-C1
Requisition Number:	
Account Number:	
Designer:	ENG
Drawing Date:	MMMM YYYY
Drafter:	TEC
Drawing Scale:	1"=50'
DAPW Approval:	
Client Approval:	
Reference Number:	1364
Building Reference:	
Drawing Number:	C202
Sheet:	of TBD

Plot Saved By: mreed Printed: 12/17/22
P:\1364 - Clear Creek Welcome Center\WORKS\SITE SHEETS\EB WELCOME CENTER\1364-EB-C200 GRADING PLAN.dwg Date: 01_2022-4:30:52 pm

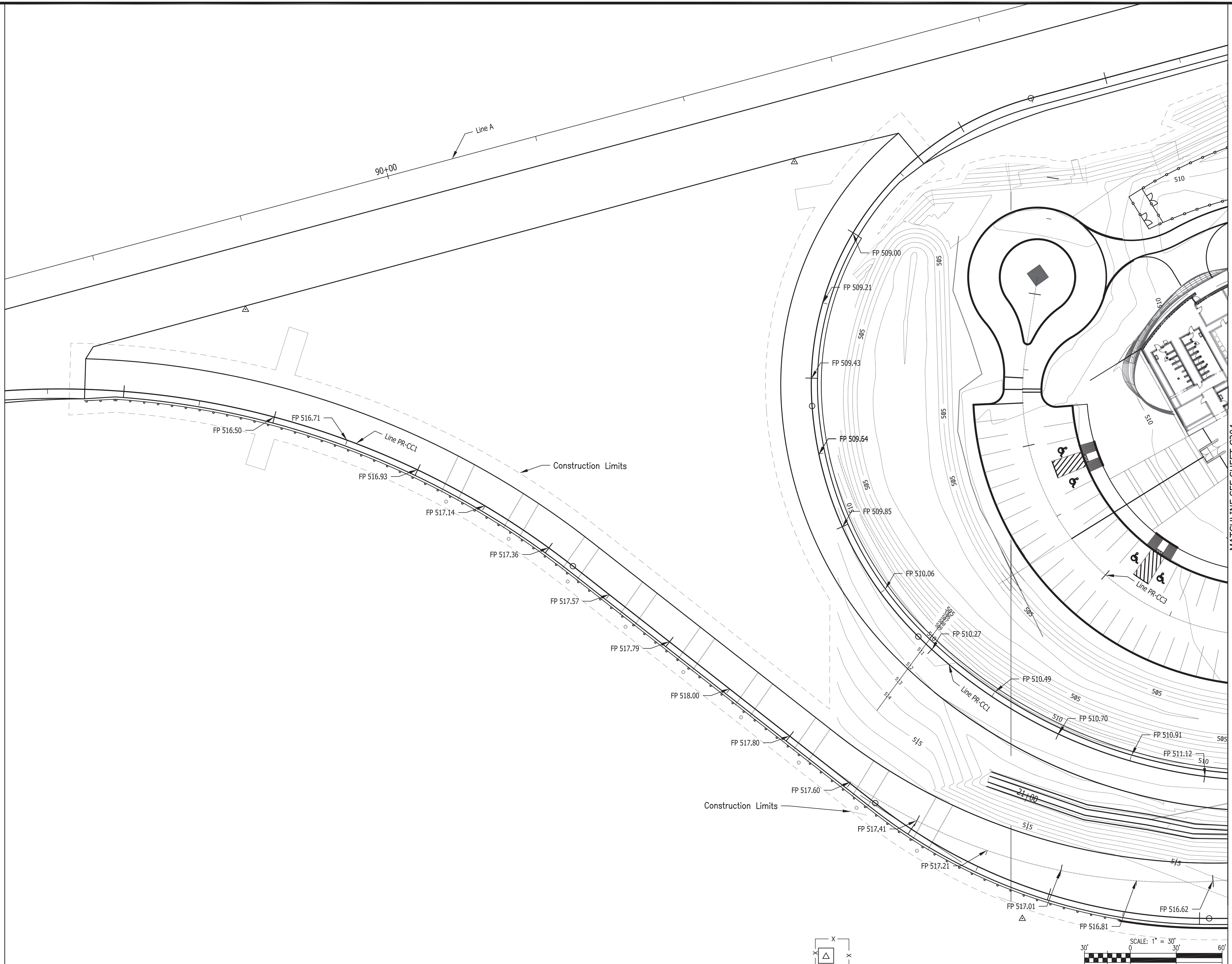

MATCHLINE SEE SHEET C204

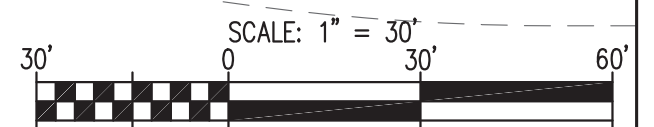

Certified by: Robert Gray

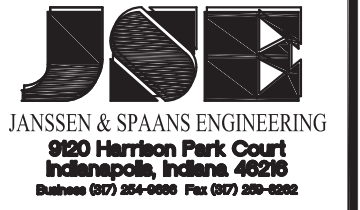

PUBLIC WORKS PROJECT NO. 84003001-22-058-C1
CLEAR CREEK WELCOME CENTER
VIGO COUNTY, INDIANA

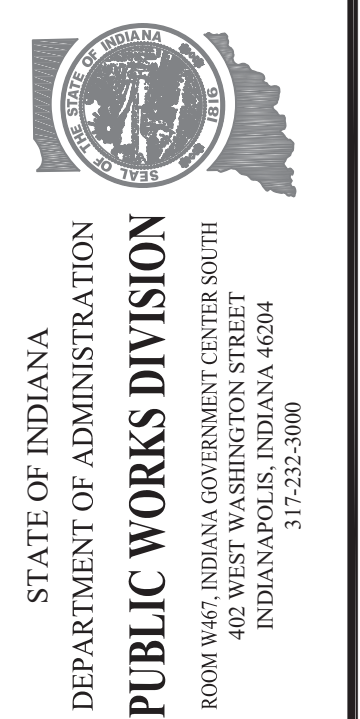

Revisions:	
Project Number:	84003001-22-058-C1
Requisition Number:	
Account Number:	
Designer:	ENG
Drawing Date:	MMMMM YYYY
Drafter:	TEC
Drawing Scale:	1"=50'
DAPW Approval:	
Client Approval:	
Reference Number:	1364
Building Reference:	
Drawing Number:	C203
Sheet:	--- of TBD

Plot Saved By: mreed, Printed: 2/7/22, P:\1364 - Clear Creek Welcome Center\WORKS\SITE SHEETS\1364-EB-C200\DRAWING PUBLISHING Due 01_2022-4:30:57 pm

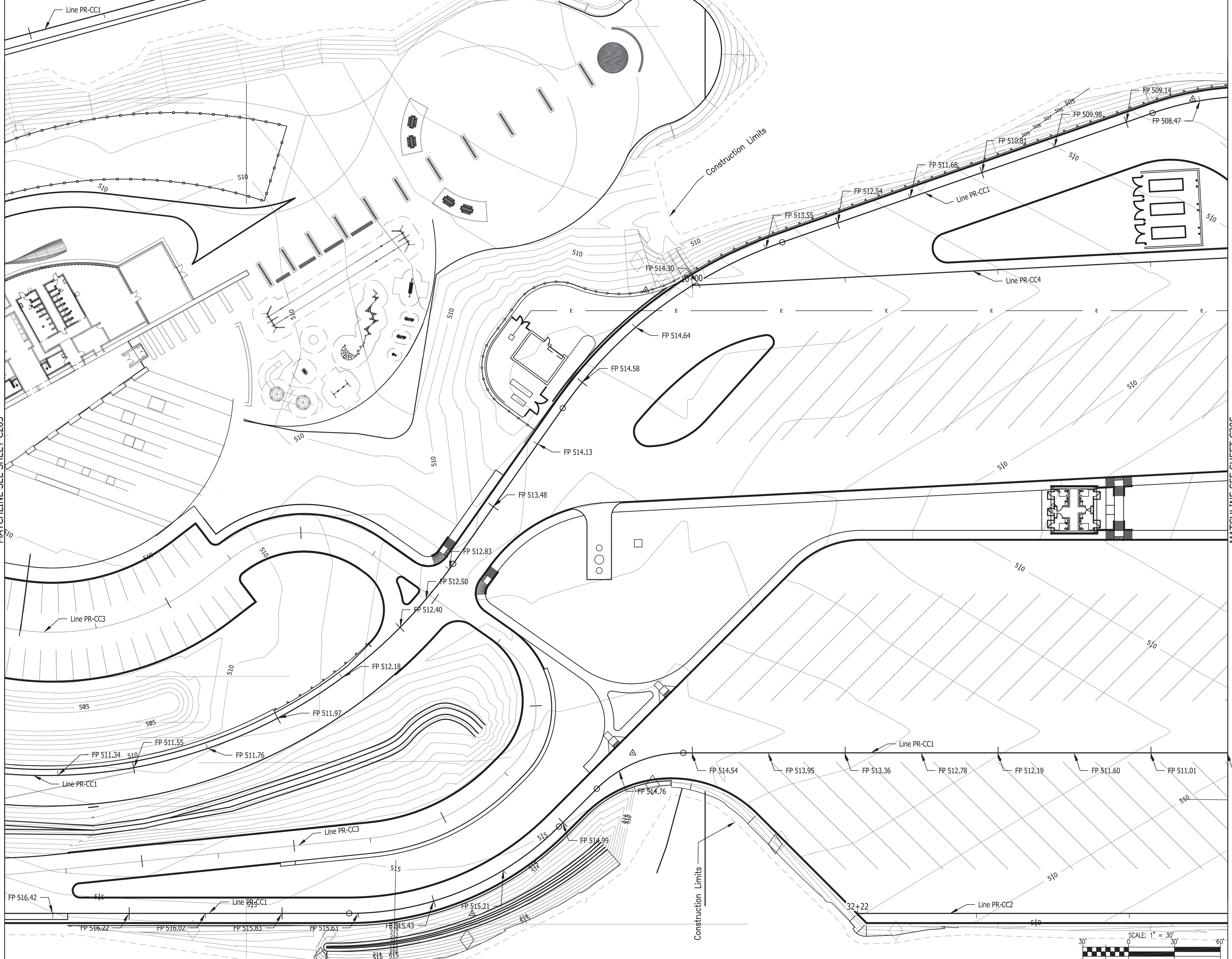

Certified by: Robert Gray

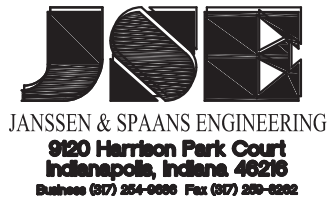

PUBLIC WORKS PROJECT NO. 84003001-22-058-C1
CLEAR CREEK WELCOME CENTER
VIGO COUNTY, INDIANA

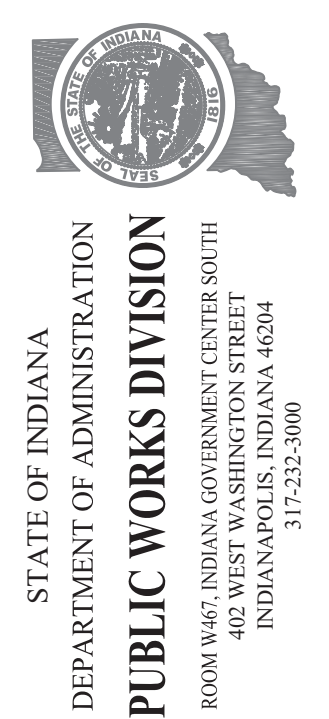

Revisions:	
Project Number:	84003001-22-058-C1
Requisition Number:	
Account Number:	
Designer:	ENG
Drawing Date:	MMMM YYYY
Drafter:	TEC
Drawing Scale:	1"=50'
DAPW Approval:	
Client Approval:	
Reference Number:	1364
Building Reference:	
Drawing Number:	C204
Sheet:	of TBD

Last Saved By: mreed Printed: 2/7/22
 P:\1364 - Clear Creek Welcome Center\WORKS\JOB SHEETS\JOB SHEETS\1364-EB-C200 GRADING PLAN.dwg Date: 01/20/22 4:51:07 pm

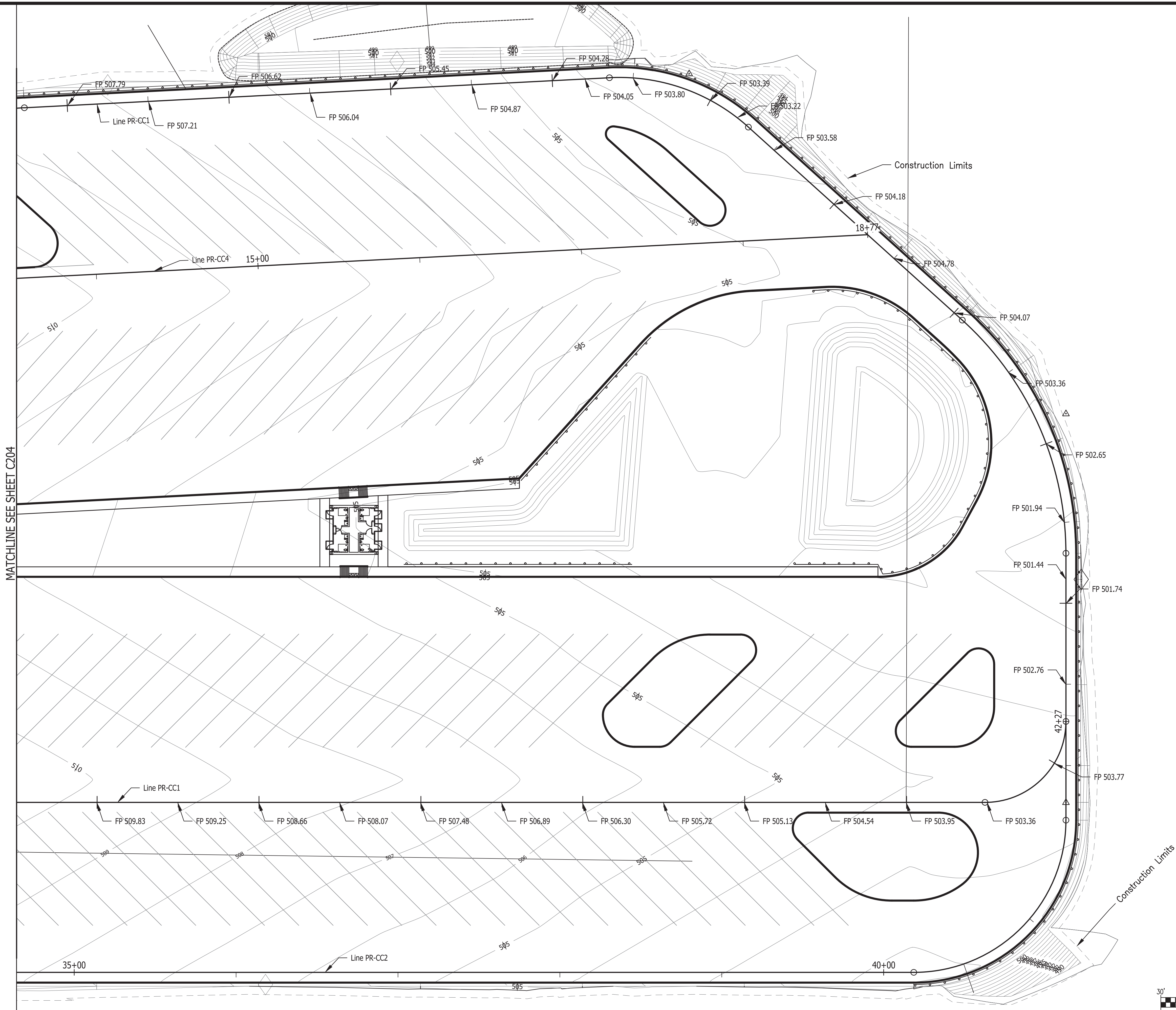

MATCHLINE SEE SHEET C204

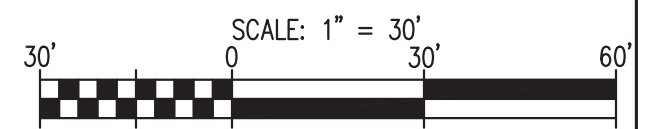
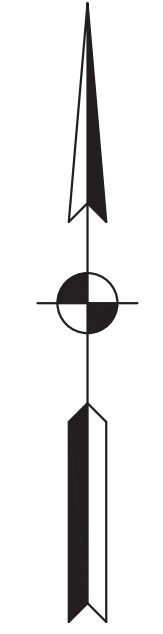

Certified by: Robert Gray

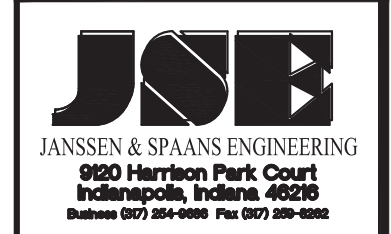

PUBLIC WORKS PROJECT NO. 84003001-22-058-C1
 CLEAR CREEK WELCOME CENTER
 VIGO COUNTY, INDIANA



Revisions:	
Project Number:	84003001-22-058-C1
Requestion Number:	
Account Number:	
Designer:	ENG
Drawing Date:	MMMM YYYY
Drafter:	TEC
Drawing Scale:	1"=50'
DAPW Approval:	
Client Approval:	
Reference Number:	1364
Building Reference:	
Drawing Number:	C205
Sheet:	--- of TBD

Last Saved By: jfingery Printed: 1/23/22
 P:\1364 - Clear Creek Welcome Center\Drawings\Site Sheets\EB SITE SHEETS\EB WELCOME CENTER\1364-EB-C300 DR PLAN.dwg Nov 23, 2022-12:15:04 pm

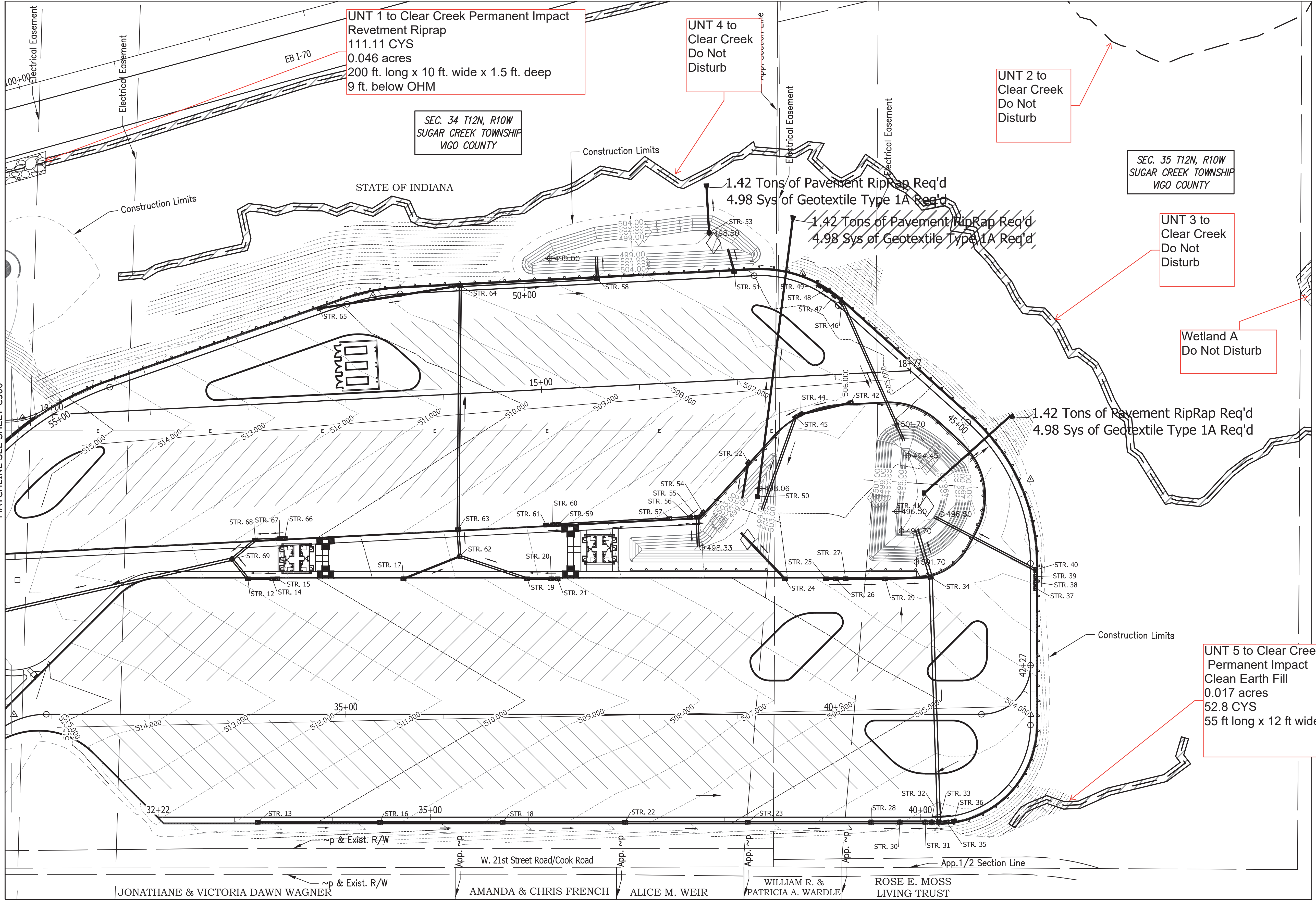

UNT 1 to Clear Creek Permanent Impact
 Revetment Riprap
 111.11 CYS
 0.046 acres
 200 ft. long x 10 ft. wide x 1.5 ft. deep
 9 ft. below OHM

UNT 4 to
 Clear Creek
 Do Not
 Disturb

UNT 2 to
 Clear Creek
 Do Not
 Disturb

SEC. 35 T12N, R10W
 SUGAR CREEK TOWNSHIP
 VIGO COUNTY

UNT 3 to
 Clear Creek
 Do Not
 Disturb

Wetland A
 Do Not Disturb

1.42 Tons of Pavement RipRap Req'd
 4.98 Sys of Geotextile Type 1A Req'd

UNT 5 to Clear Creek
 Permanent Impact
 Clean Earth Fill
 0.017 acres
 52.8 CYS
 55 ft long x 12 ft wide x 2 ft deep

MATCHLINE SEE SHEET C300

Do Not Disturb

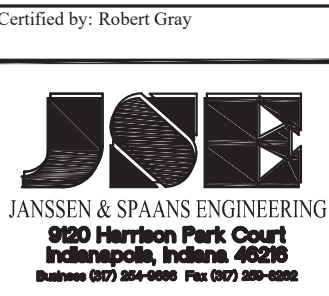
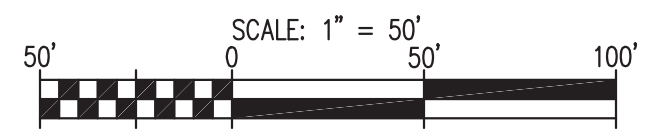

PUBLIC WORKS PROJECT NO. 84003001-22-058-C1
 CLEAR CREEK WELCOME CENTER
 VIGO COUNTY, INDIANA

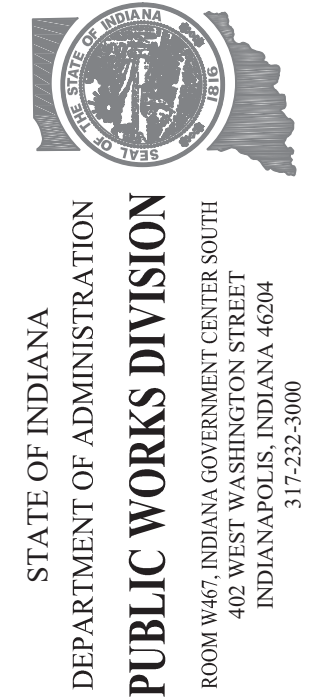

Revisions:	
Project Number:	84003001-22-058-C1
Requestion Number:	
Account Number:	
Designer:	ENG
Drawing Date:	MMMM YYYY
Drafter:	TEC
Drawing Scale:	1"=50'
DAPW Approval:	
Client Approval:	
Reference Number:	1364
Building Reference:	
Drawing Number:	C301
Sheet:	of TBD

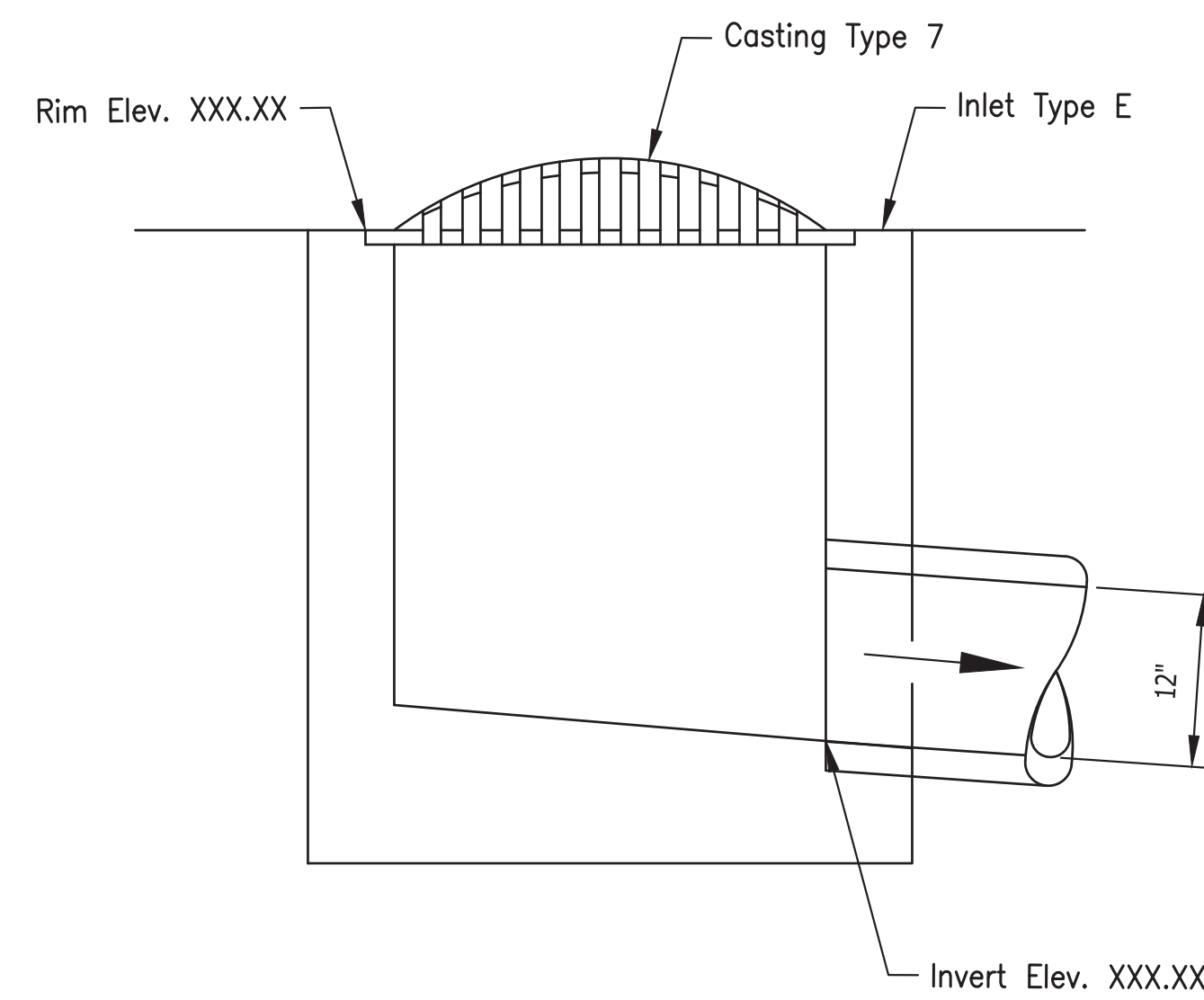
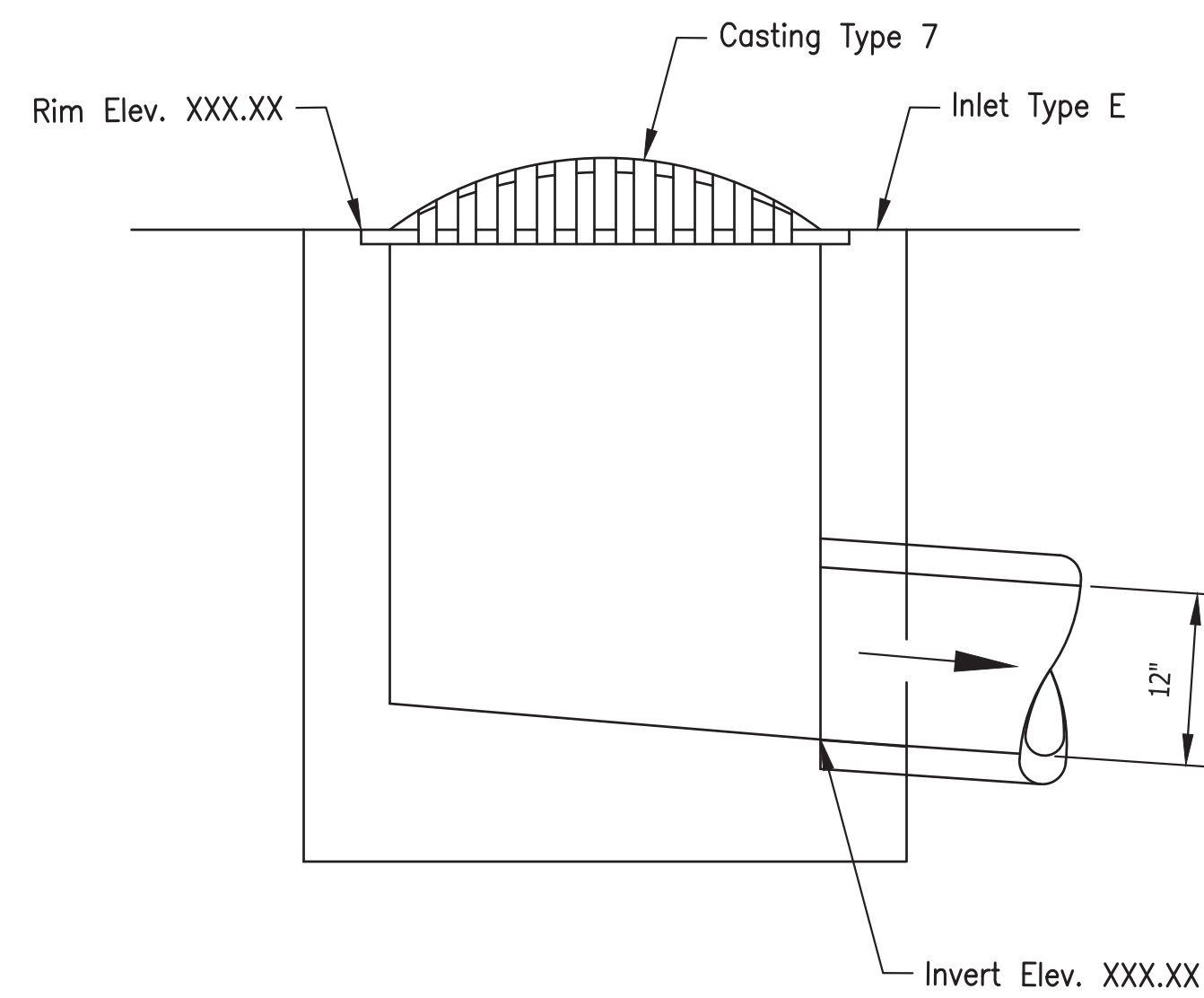
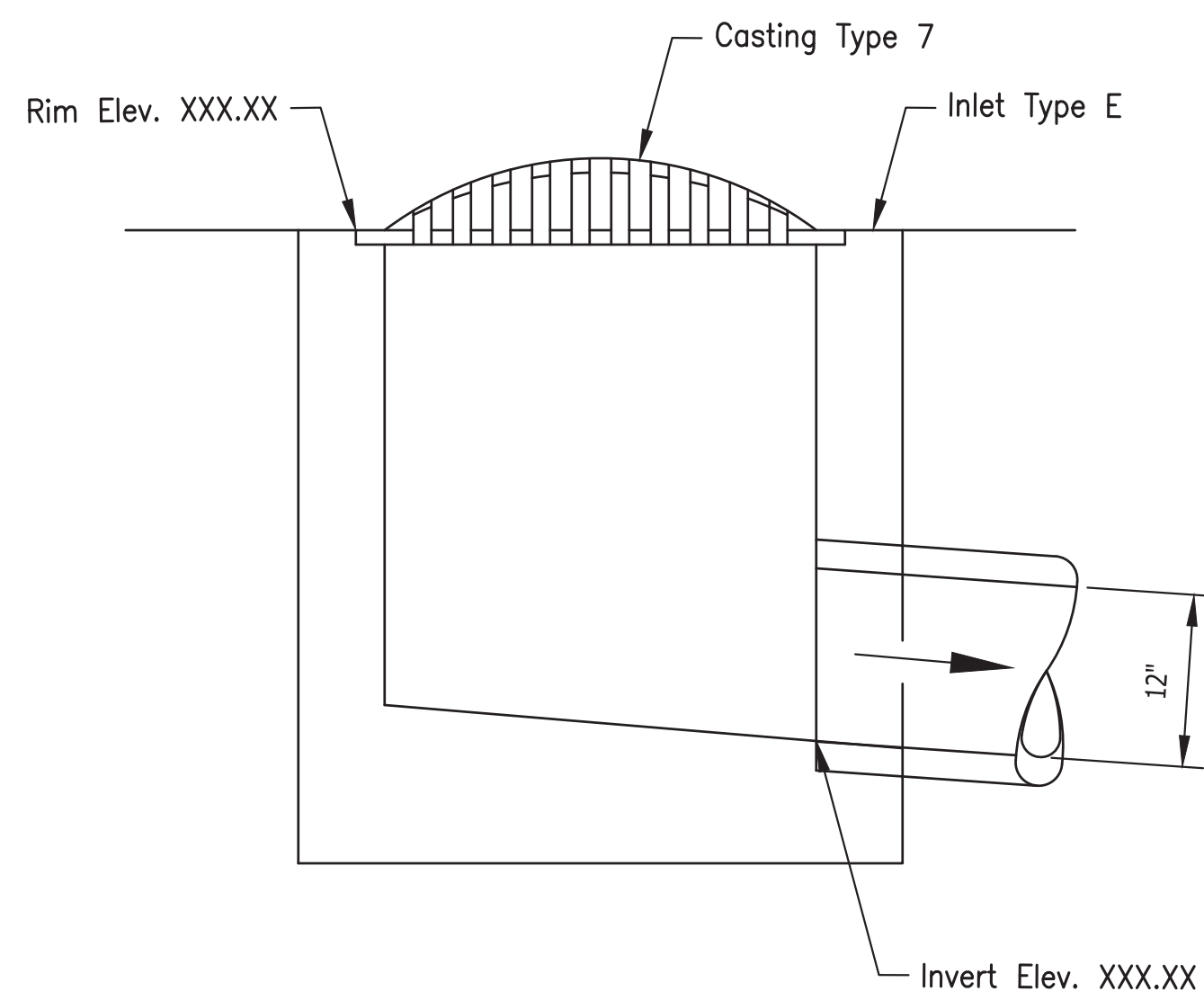
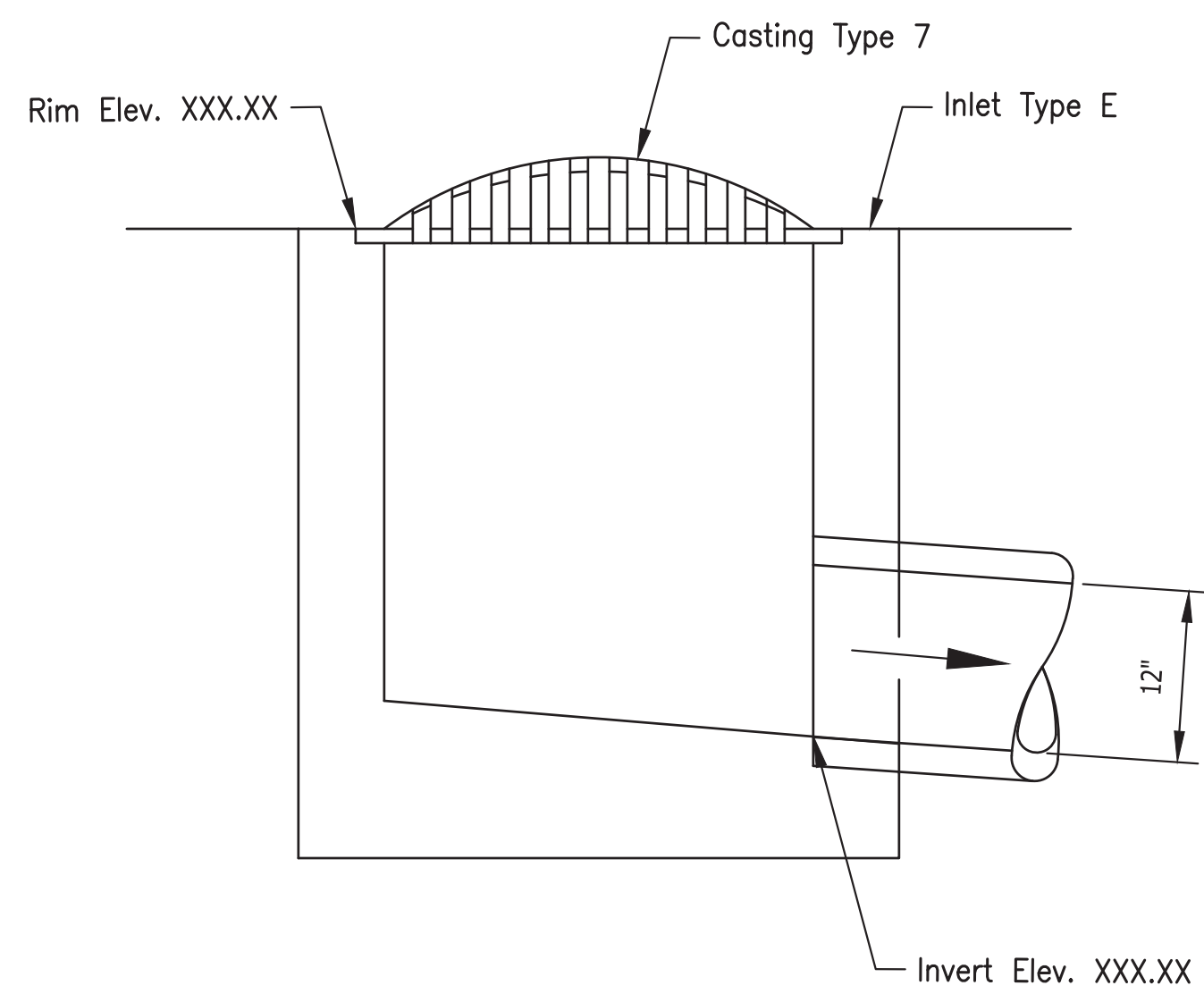
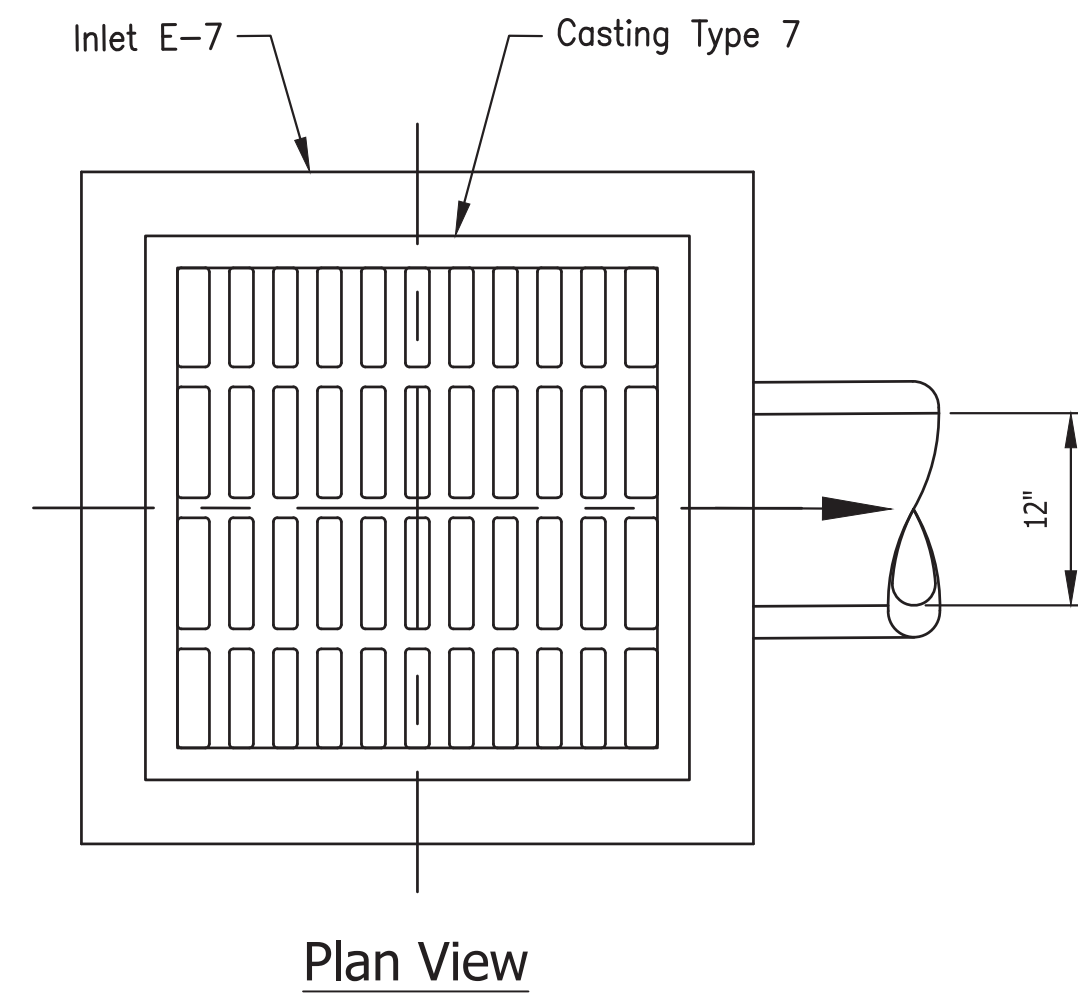
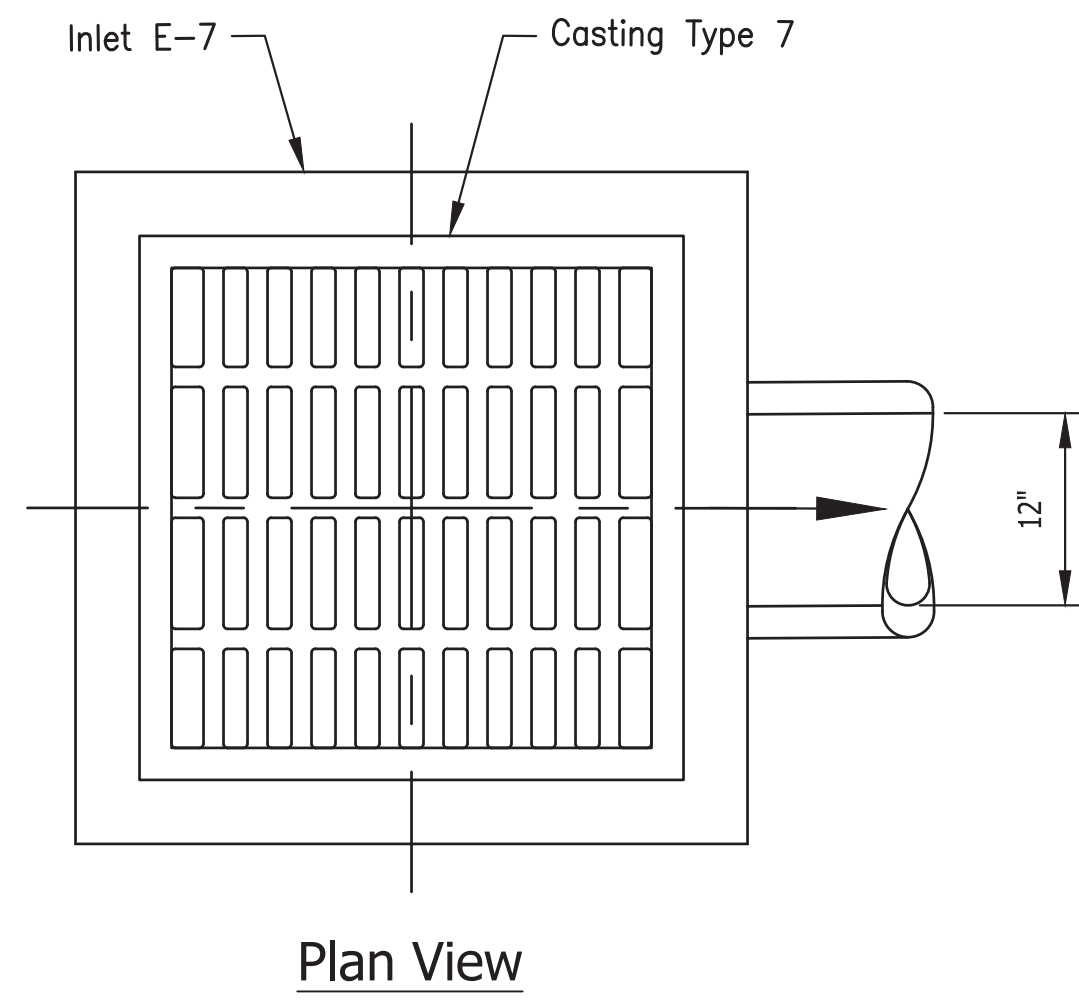
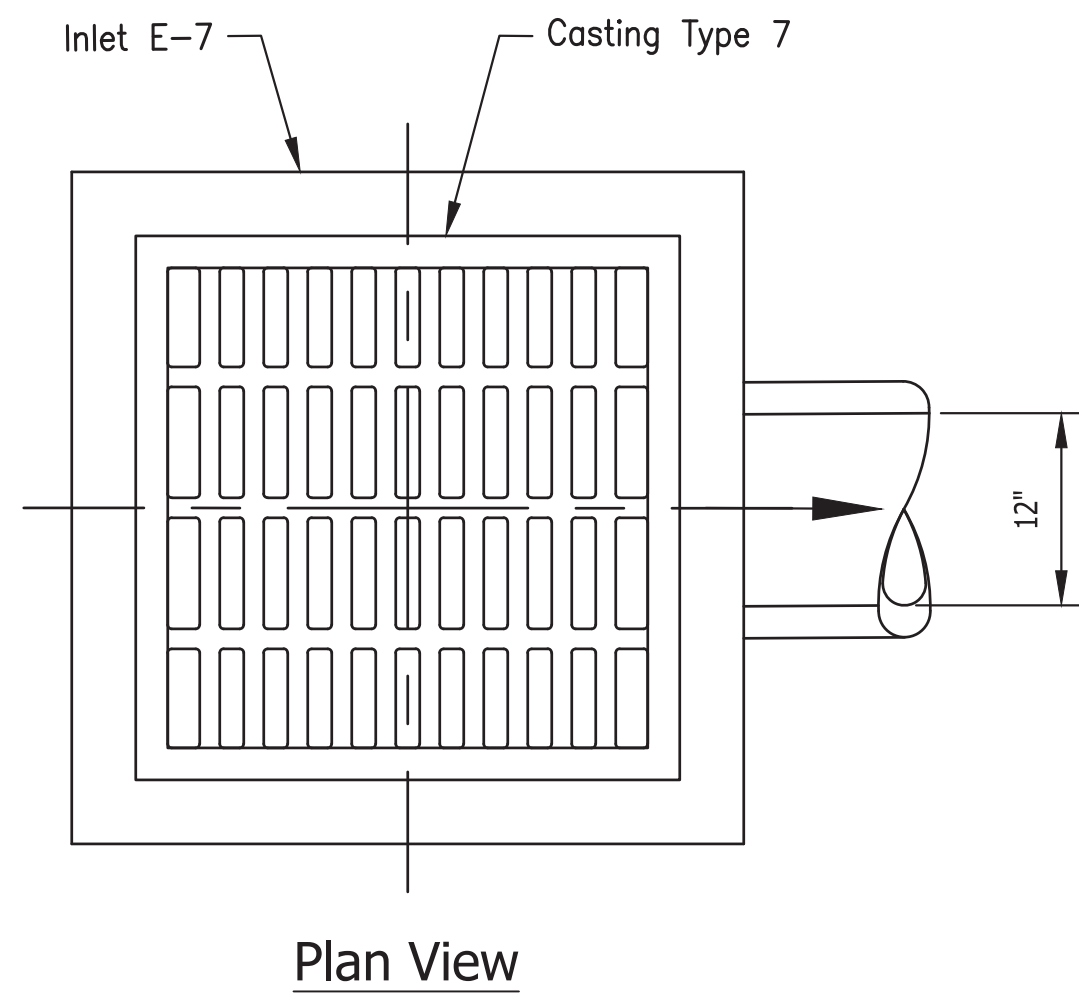
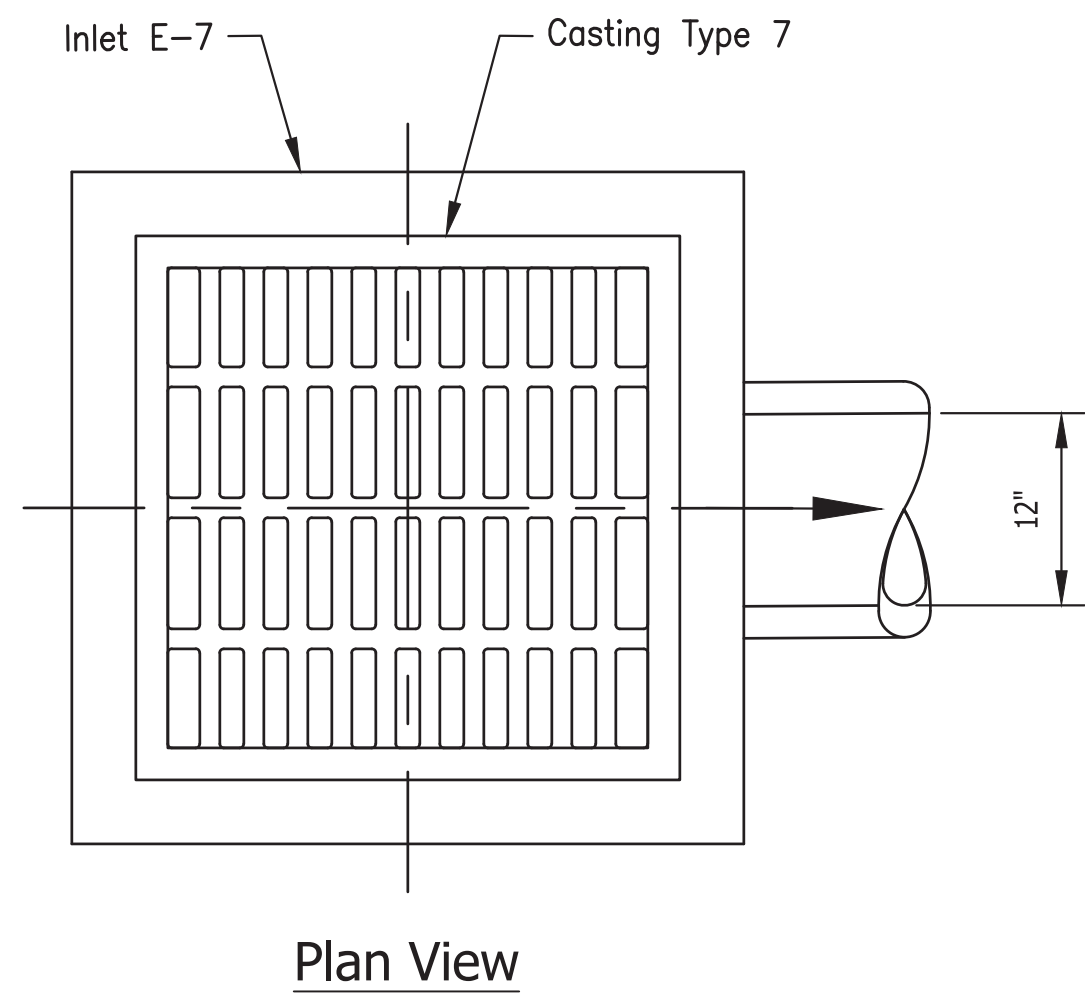

POND OUTFALL STR. NO. 31

POND OUTFALL STR. NO. 39

POND OUTFALL STR. NO. 42

POND OUTFALL STR. NO. 60

Last Saved By: mreed Printed: 12/1/22
 P:\1364 - Clear Creek Welcome Center\WORKS\SITE SHEETS\WB WELCOME CENTER\1364-EB-C300 DR PLAN.dwg Dec 01, 2022 - 4:35:50 pm

Certified by: Robert Gray

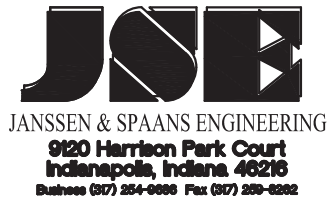

PUBLIC WORKS PROJECT NO. 84003001-22-058-C1
 CLEAR CREEK WELCOME CENTER
 VIGO COUNTY, INDIANA

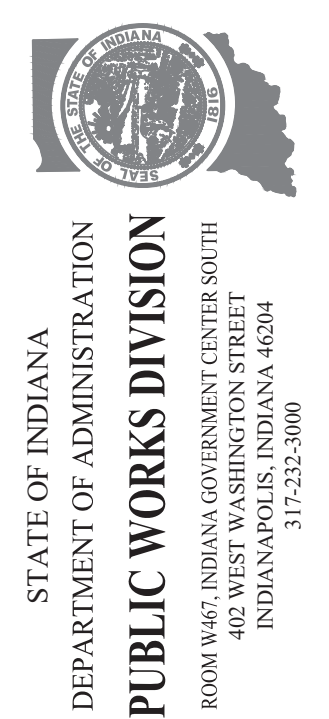

Revisions:	
Project Number:	84003001-22-058-C1
Requestion Number:	-
Account Number:	-
Designer:	ENG M M M M M Y Y Y Y
Drafter:	TEC 1"=50'
DAPW Approval:	-
Client Approval:	-
Reference Number:	1364
Building Reference:	-
Drawing Number:	C307
Sheet:	--- of TBD



REST AREA WELCOME CENTER 1 3/4 MILES NEXT REST AREA 64 MILES IGSOE-1 ① I-70 MM 0.0	REST AREA WELCOME CENTER 1/2 MILE VENDING MACHINES IGSOE-2 ① I-70 MM 1.0	MOTORISTS SERVICE INFORMATION NEXT RIGHT IGSE-1 ① I-70 MM 1.3	REST AREA WELCOME CENTER IGSOE-3 ① I-70 MM 1.5
---	---	--	---

- LEGEND**
- Proposed Sign
 - ① No change required to existing signs and supports
 - ⑬ New panel sign on new ground mounted supports
 - ⑭ New sheet sign on new supports
 - ④① Line, Multi-Component, Solid, White, 6 in.
 - ④② Line, Multi-Component, Solid, Yellow, 4 in.
 - ④③ Line, Multi-Component, Solid, White, 4 in.
 - ④④ Line, Multi-Component, Solid, White, 10 in.
 - ④⑤ Transverse, Multi-Component, Yield Line, 36 in.
 - ④⑥ Transverse, Multi-Component, Stop Line, 24 in.
 - ⑤① Pavement Message Marking, Multi-Component, Turn Arrow
 - ⑤② Pavement Message Marking, Multi-Component, Accessibility
 - ⑥① Line, Multi-Component, Solid, Blue, 4 in.

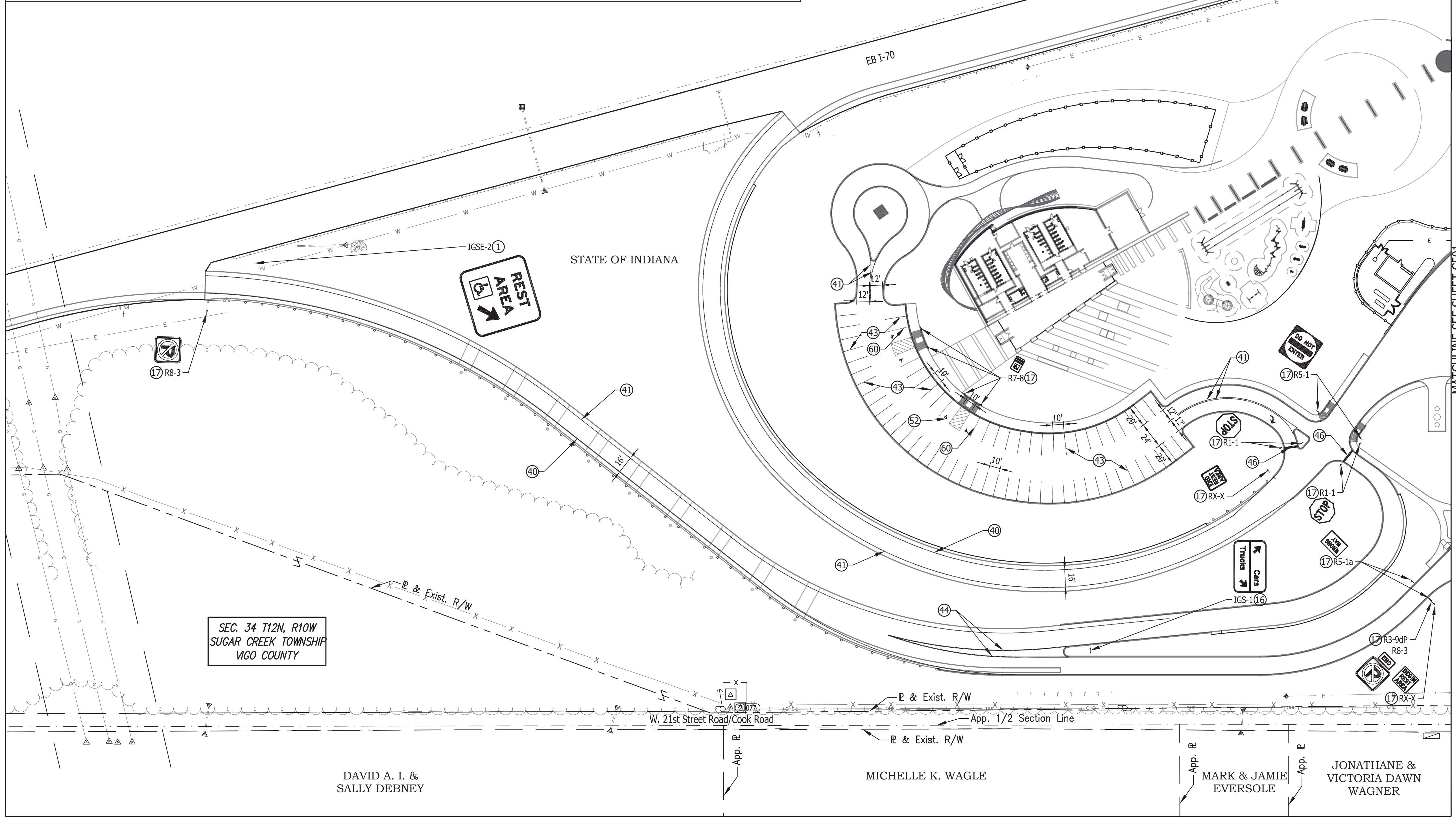

SEC. 34 T12N, R10W
SUGAR CREEK TOWNSHIP
VIGO COUNTY

DAVID A. I. &
SALLY DEBNEY

MICHELLE K. WAGLE

MARK & JAMIE
EVERSOLE

JONATHANE &
VICTORIA DAWN
WAGNER

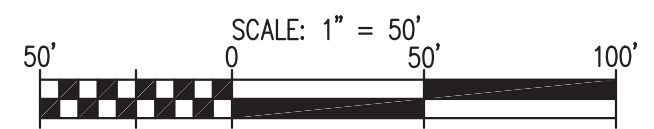

MATCHLINE SEE SHEET C501

Last Saved By: mreed Printed: 2/7/22 P:\1364 - Clear Creek Welcome Center\WORKS\SITE SHEETS\EB WELCOME CENTER\1364-EB-C501-SHA-PMK-PLAN.dwg Dec 01, 2022 - 4:53:29 pm

Certified by: Robert Gray

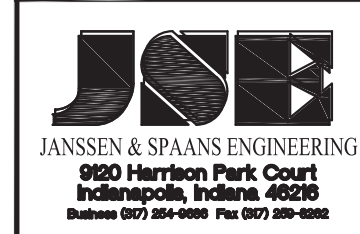

LANDSCAPE ARCHITECTURE
30 W Monroe Street, Suite 500
Chicago, IL 60603
T: 312-465-2359
www.ratiodesign.com

PUBLIC WORKS PROJECT NO. 84003001-22-058-C1
CLEAR CREEK WELCOME CENTER
VIGO COUNTY, INDIANA



STATE OF INDIANA
DEPARTMENT OF ADMINISTRATION
PUBLIC WORKS DIVISION
ROOM 9407, INDIANA GOVERNMENT CENTER SOUTH
402 WEST WASHINGTON STREET
INDIANAPOLIS, INDIANA 46204
317-232-3000

Revisions:

Project Number: 84003001-22-058-C1
Requisition Number:

Account Number:

Designer: ENG MYYYYY YYYY
Drafter: TEC
DAPW Approval:

Client Approval:

Reference Number: 1364

Building Reference:

Drawing Number: C500

Sheet: --- of TBD

Last Saved By: mreed Printed: 12/17/22
 P:\1364 - Clear Creek Welcome Center\DWG\SITE SHEETS\EB WELCOME CENTER\1364-EB-C500 SH-PAK PLN.dwg Dec 01, 2022 - 03:54:44 pm

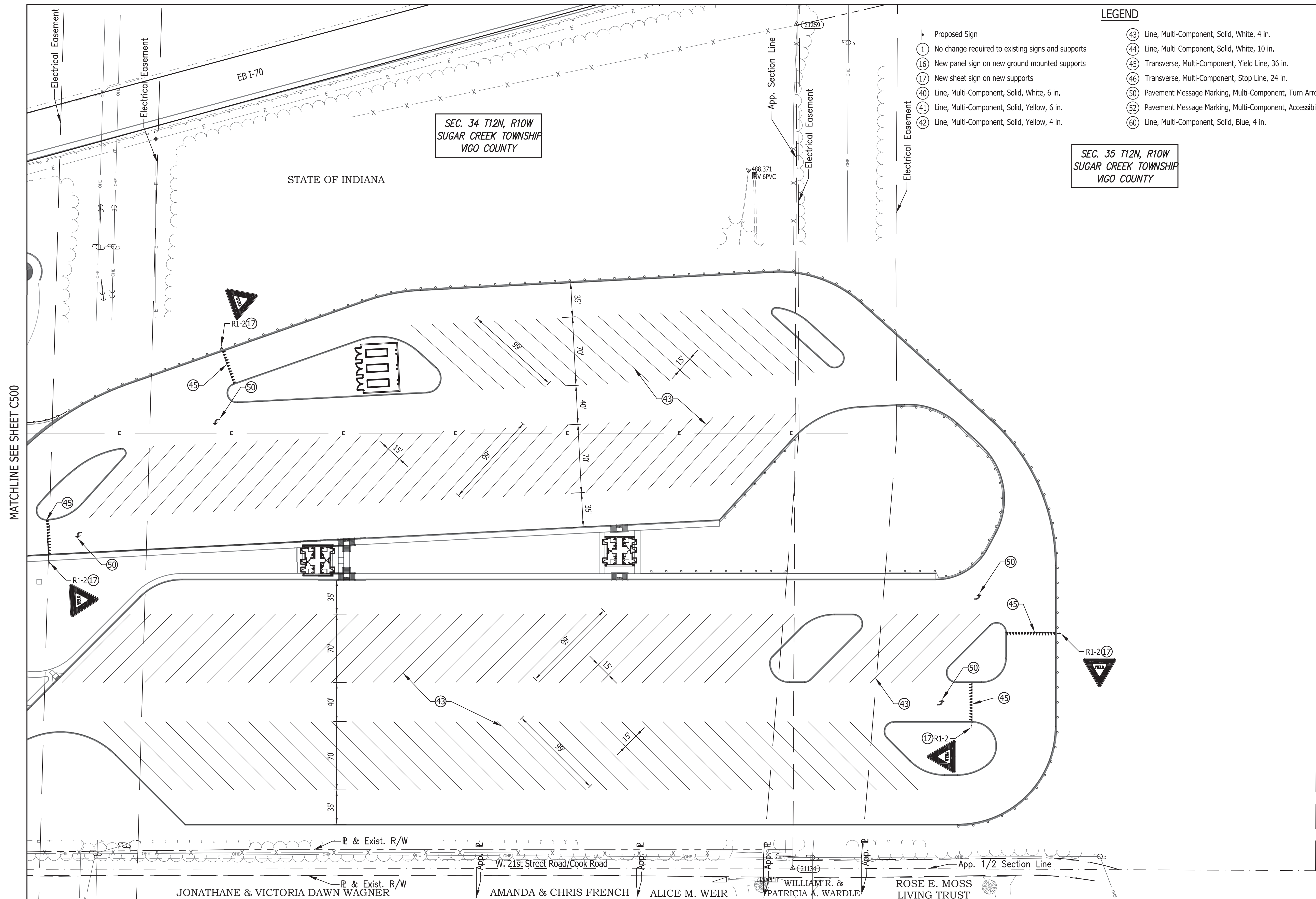

MATCHLINE SEE SHEET C500

LEGEND

Proposed Sign	(43) Line, Multi-Component, Solid, White, 4 in.
(1) No change required to existing signs and supports	(44) Line, Multi-Component, Solid, White, 10 in.
(16) New panel sign on new ground mounted supports	(45) Transverse, Multi-Component, Yield Line, 36 in.
(17) New sheet sign on new supports	(46) Transverse, Multi-Component, Stop Line, 24 in.
(40) Line, Multi-Component, Solid, White, 6 in.	(50) Pavement Message Marking, Multi-Component, Turn Arrow
(41) Line, Multi-Component, Solid, Yellow, 6 in.	(52) Pavement Message Marking, Multi-Component, Accessibility
(42) Line, Multi-Component, Solid, Yellow, 4 in.	(60) Line, Multi-Component, Solid, Blue, 4 in.

Certified by: Robert Gray

JSE
 JANSSEN & SPAANS ENGINEERING
 950 Harrison Park Court
 Indianapolis, Indiana 46229
 Phone: (317) 554-0000 Fax: (317) 554-0001

synthesis
RATIO
 LANDSCAPE ARCHITECTURE
 30 W. Monroe Street, Suite 500
 Chicago, IL 60603
 T: 312.465.2359
 www.ratiodesign.com

PUBLIC WORKS PROJECT NO. 84003001-22-058-C1
 CLEAR CREEK WELCOME CENTER
 VIGO COUNTY, INDIANA

STATE OF INDIANA
 DEPARTMENT OF ADMINISTRATION
PUBLIC WORKS DIVISION
 ROOM 9407, INDIANA GOVERNMENT CENTER SOUTH
 402 WEST WASHINGTON STREET
 INDIANAPOLIS, INDIANA 46204
 317-232-3000

Revisions:	
Project Number:	84003001-22-058-C1
Requisition Number:	
Account Number:	
Designer:	ENG
Drawing Date:	MMMMM YYYY
Drafter:	TEC
Drawing Scale:	1"=50'
DAPW Approval:	
Client Approval:	
Reference Number:	1364
Building Reference:	
Drawing Number:	C501
Sheet:	of TBD

