

PROJECT	DESIGNATION
1701589	1601078
CONTRACT	BRIDGE FILE
B-40580	041-23-10200

INDIANA DEPARTMENT OF TRANSPORTATION

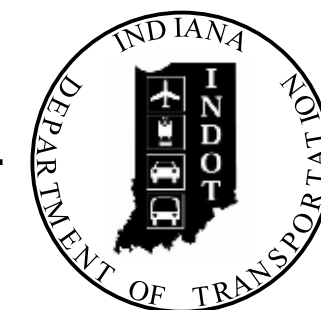

STRUCTURE INFORMATION				
STRUCTURE	TYPE	SPAN AND SKEW	OVER	STATION
041-23-10200	CONTINUOUS COMPOSITE PRESTRESSED CONCRETE BULB-TEE BEAM BRIDGE	3 Spans: 58'-0", 70'-0", 58'-0" Skew: 10° Lt.	Coal Creek	239+02.00 Line "PR-A"

Kin Project Information		
DES. NUMBER	DESCRIPTION	TYPE
*1701589	SR 163 over Brouillets Creek	Bridge

* Lead Des Number

BRIDGE PLANS

FOR SPANS OVER 20 FEET

ROUTE: US 41 AT: RP 168+22

PROJECT NO. 1701589 P.E.
1701589 R/W
1701589 CONST.

Bridge Replacement on US 41 over Coal Creek
Located Approximately 2.52 Miles South of SR 55
Between Sections 5, 6, 7 & 8, T-20-N, R-7-W, Shawnee Township, Fountain County, Indiana

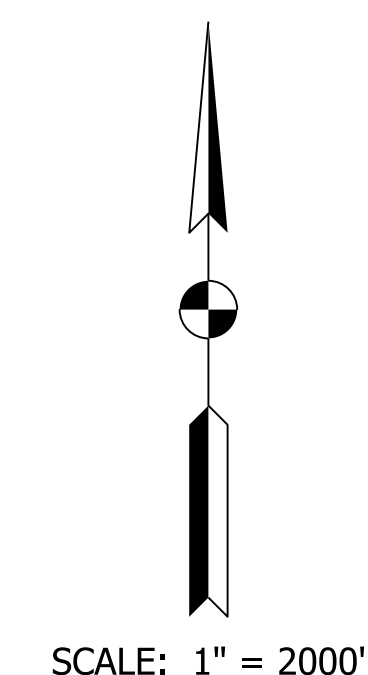
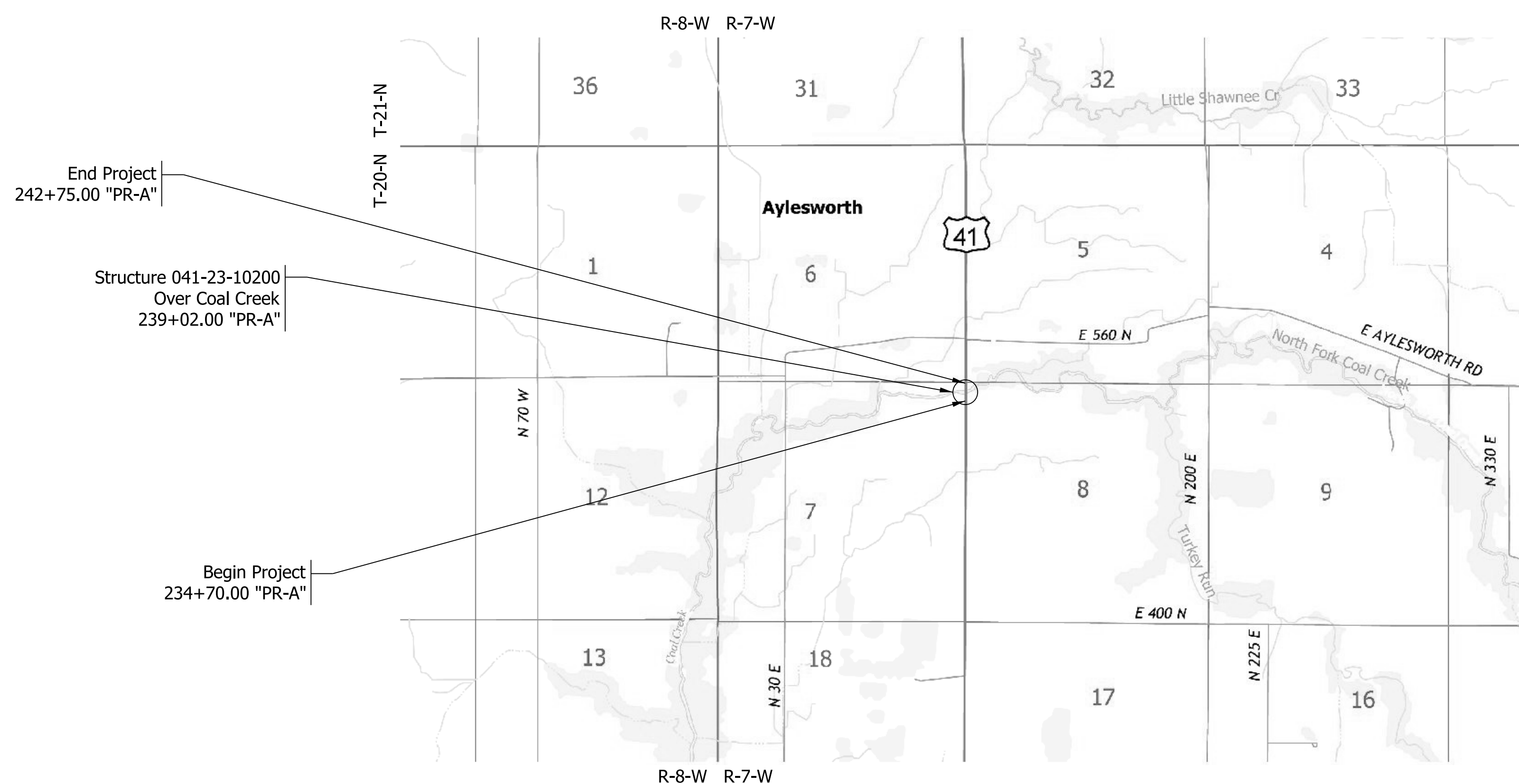

TRAFFIC DATA / US 41		
A.A.D.T.	(2021)	3,459 V.P.D.
A.A.D.T.	(2041)	3,529 V.P.D.
D.H.V	(2041)	376 V.P.H.
DIRECTIONAL DISTRIBUTION	47.01% N.B. 52.99% S.B.	
TRUCKS	14.18% A.A.D.T. 13.9% D.H.V.	

DESIGN DATA / US 41	
DESIGN SPEED	55 M.P.H.
PROJECT DESIGN CRITERIA	NEW CONSTRUCTION (NON-FREEWAY)
FUNCTIONAL CLASSIFICATION	MINOR ARTERIAL
RURAL/URBAN	RURAL
TERRAIN	LEVEL
ACCESS CONTROL	NONE

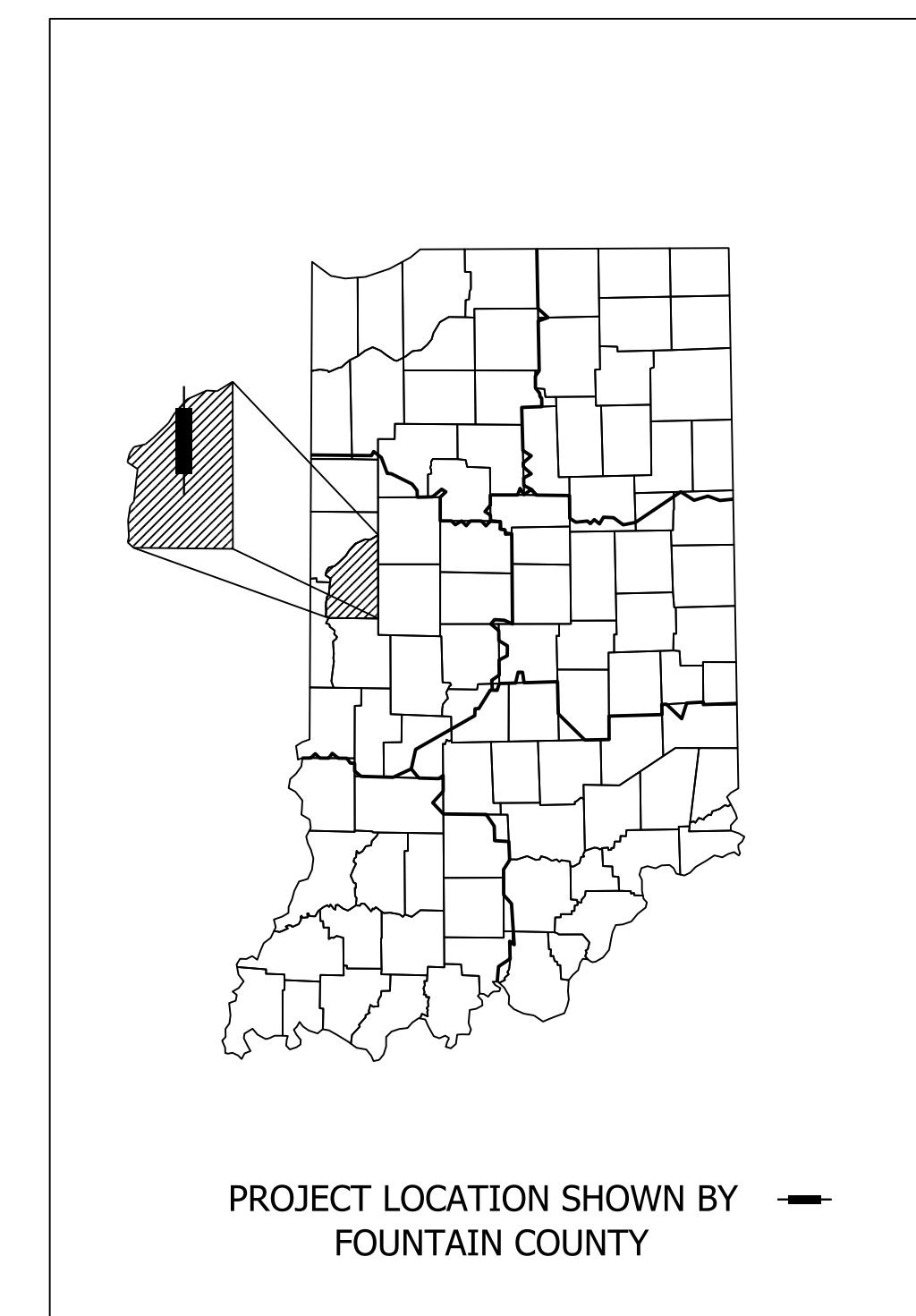

LATITUDE: 40° 12' 00" N LONGITUDE: 87° 14' 35" W

BRIDGE LENGTH:	0.036 MI.
ROADWAY LENGTH:	0.008 MI.
TOTAL LENGTH:	0.044 MI.
MAX. GRADE:	-1.65 %

HUC: 05120108100040

INDIANA DEPARTMENT OF TRANSPORTATION
STANDARD SPECIFICATIONS DATED 2020
TO BE USED WITH THESE PLANS.

PARSONS

101 W. Ohio St., Suite 2121
Indianapolis, IN 46204
Bus (317) 616-1000
Fax (317) 616-1033

IP_PWP:dms26358\US41_BR_Title Sheet.dgn
25-FEB-2020

PLANS PREPARED BY:	PARSONS	317-616-1000
		PHONE NUMBER
CERTIFIED BY:		DATE
APPROVED FOR LETTING:	INDIANA DEPARTMENT OF TRANSPORTATION	DATE

BRIDGE FILE		
041-23-10200		
DESIGNATION		
1601078		
SURVEY BOOK	SHEETS	
ELECTRONIC	1	of 17
CONTRACT	PROJECT	
B-40580	1701589	

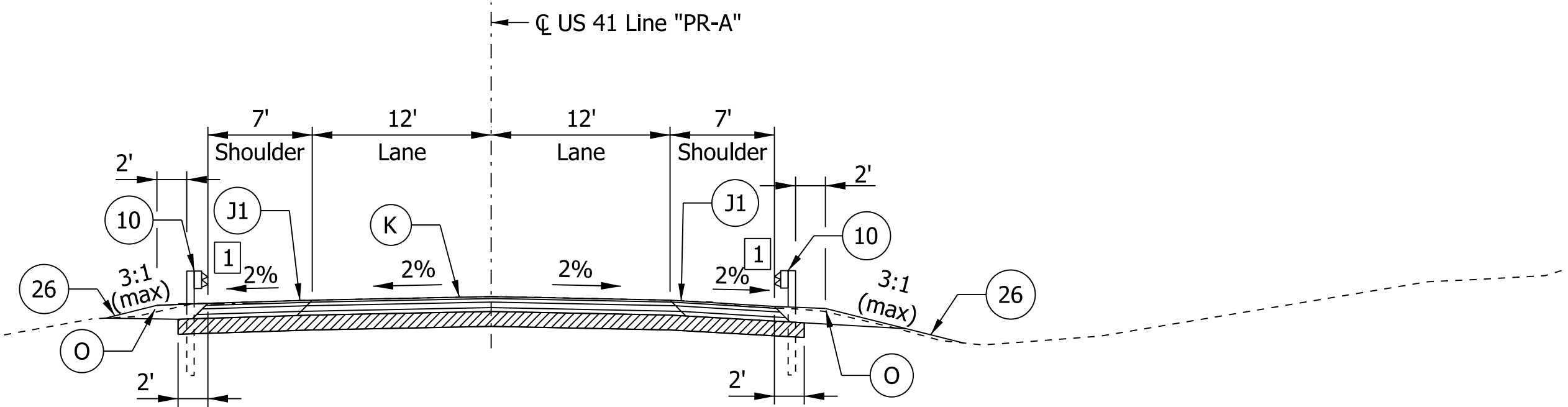

TYPICAL SECTION

Sta. 236+75.00 to Sta. 237+84.19, Line "PR-A"
 Sta. 240+19.81 to Sta. 241+30.00, Line "PR-A"

- 1 Begin Guardrail
 Sta. 236+86.51 Lt.
 Sta. 236+55.59 Rt.
 End Guardrail
 Sta. 241+48.41 Lt.
 Sta. 241+17.49 Rt.
- 2 2'-0" to 7'-0"
 Sta. 235+83.33 to Sta. 236+75.00
 7'-0" to 2'-0"
 Sta. 241+60.00 to Sta. 242+51.67
- 3 2'-0" to 7'-0"
 Sta. 235+53.33 to Sta. 236+45.00
 7'-0" to 2'-0"
 Sta. 241+30.00 to Sta. 242+21.67

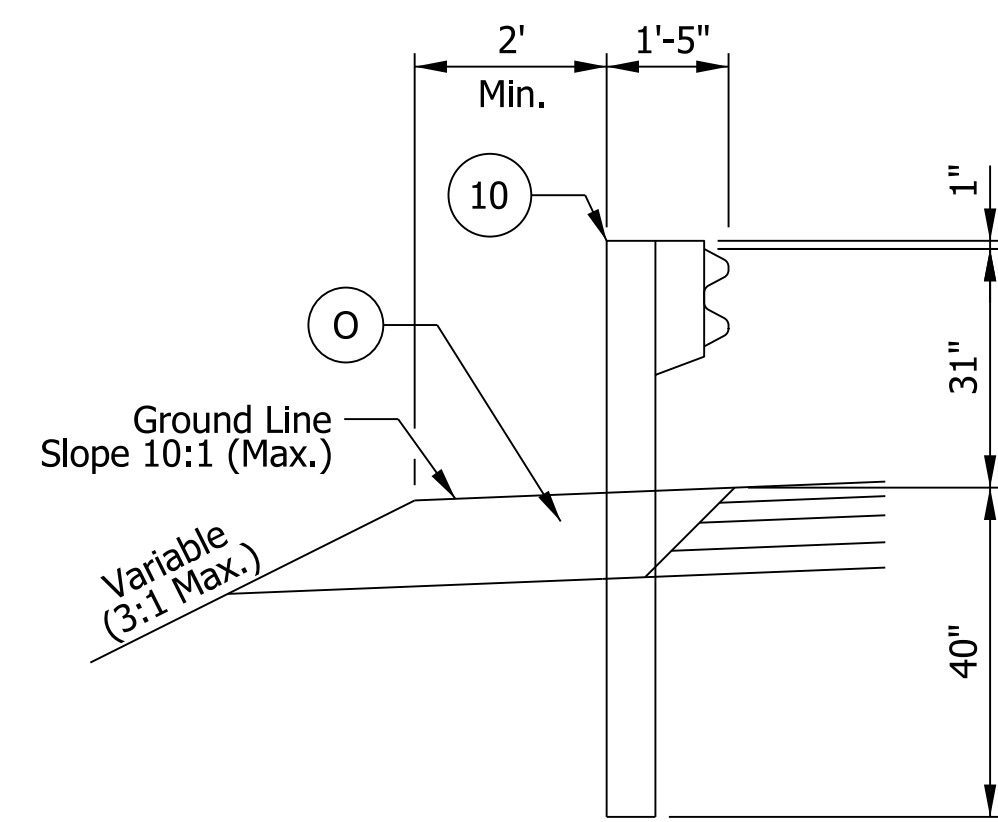

MGS W-Beam Typical
 NOT TO SCALE

PAVING EXCEPTION

Sta. 237+84.19 to Sta. 240+19.81, Line "PR-A"

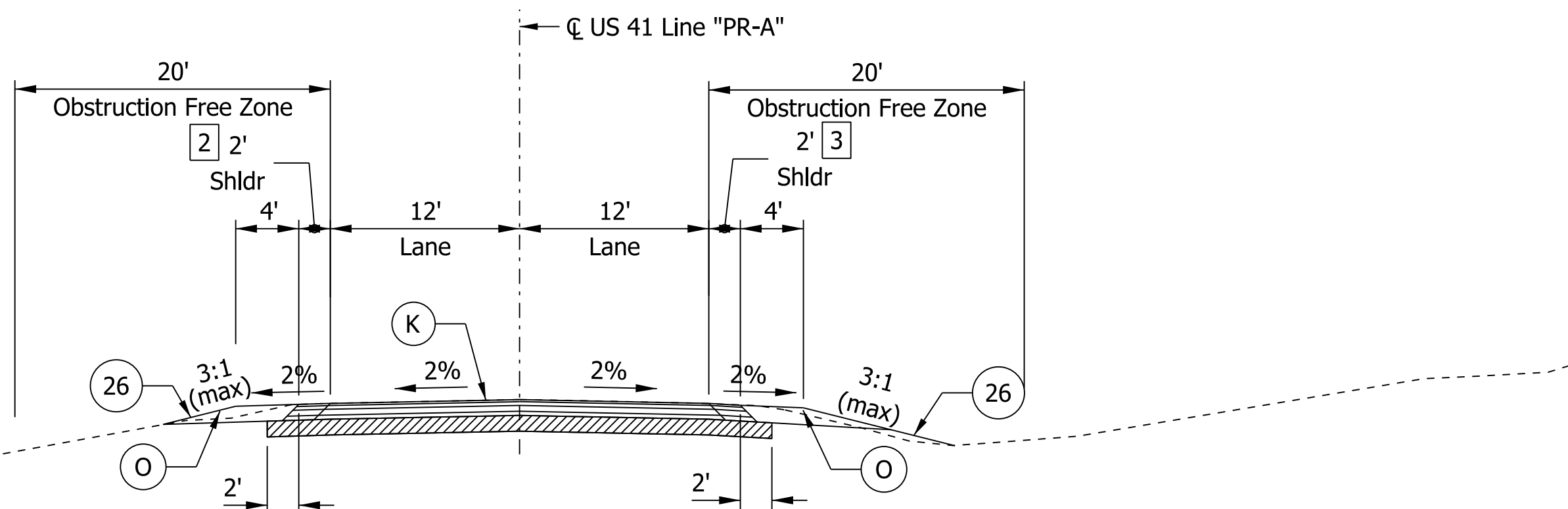

TYPICAL SECTION

Sta. 234+70.00 to Sta. 236+75.00, Line "PR-A"
 Sta. 241+30.00 to Sta. 242+75.00, Line "PR-A"

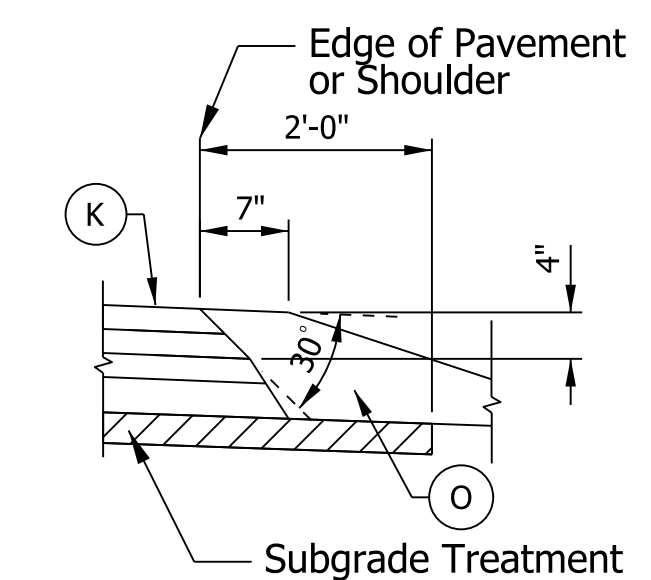

SAFETY EDGE ON HMA PAVEMENT

NOTE TO REVIEWER:
 PAVEMENT DESIGN HAS NOT BEEN COMPLETED
 AND WILL BE ADDED AT NEXT SUBMITTAL.

Notes:

- 1. Remove existing guardrail:
 Sta. 237+26.38 to Sta. 240+79.48 Lt.
 Sta. 237+38.81 to Sta. 240+83.54 Rt.

- (K) - Full Depth HMA Pavement on Subgrade Treatment Type - TBD
- (26) - Mulched Seeding R
- (O) - Compacted Aggregate, No. 53
- (J1) - Shoulder Rumble Strip
- (10) - Guardrail, MGS, W-Beam, 6'-3" Spacing
- (Hatched Box) - Subgrade Treatment, Type - TBD

RECOMMENDED FOR APPROVAL	DESIGN ENGINEER	DATE
DESIGNED: WN	DRAWN: SJC	
CHECKED: KAP	CHECKED: KAP	

INDIANA
 DEPARTMENT OF TRANSPORTATION

TYPICAL CROSS SECTIONS

HORIZONTAL SCALE	BRIDGE FILE
1/8" = 1'	041-23-10200
VERTICAL SCALE	DESIGNATION
N/A	1601078
SURVEY BOOK	SHEETS
ELECTRONIC	3 of 17
CONTRACT	PROJECT
B-40580	1701589

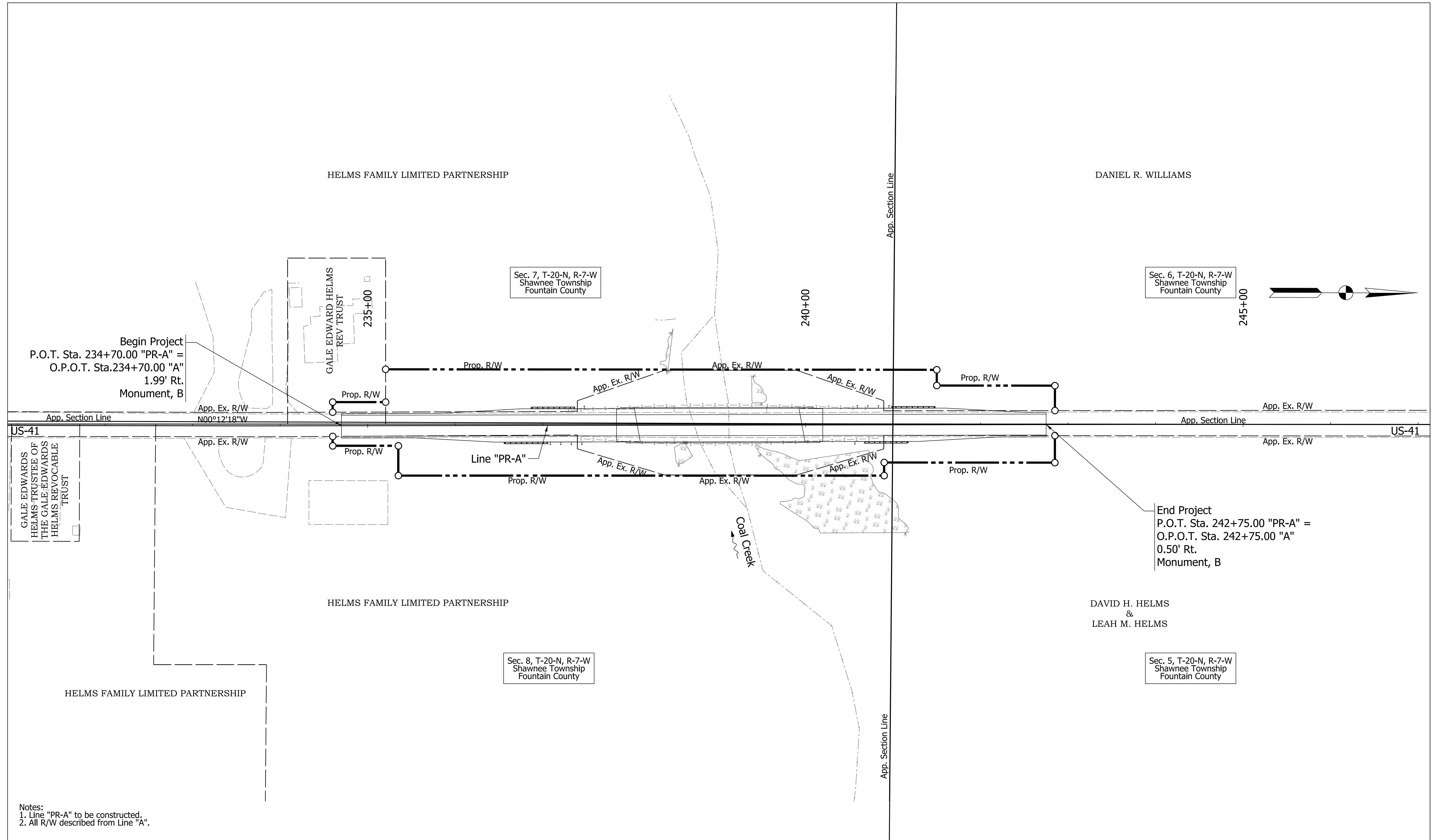

Begin Project
 P.O.T. Sta. 234+70.00 "PR-A" =
 O.P.O.T. Sta. 234+70.00 "A"
 1.99' Rt.
 Monument, B

End Project
 P.O.T. Sta. 242+75.00 "PR-A" =
 O.P.O.T. Sta. 242+75.00 "A"
 0.50' Rt.
 Monument, B

Notes:
 1. Line "PR-A" to be constructed.
 2. All R/W described from Line "A".

RECOMMENDED FOR APPROVAL	DESIGN ENGINEER	DATE
DESIGNED: WN	DRAWN: SJC	
CHECKED: KAP	CHECKED: KAP	

INDIANA
 DEPARTMENT OF TRANSPORTATION

PLAT NO. 1

HORIZONTAL SCALE	BRIDGE FILE
1" = 50'	041-23-10200
VERTICAL SCALE	DESIGNATION
N/A	1601078
SURVEY BOOK	SHEETS
ELECTRONIC	4 of 17
CONTRACT	PROJECT
B-40580	1701589

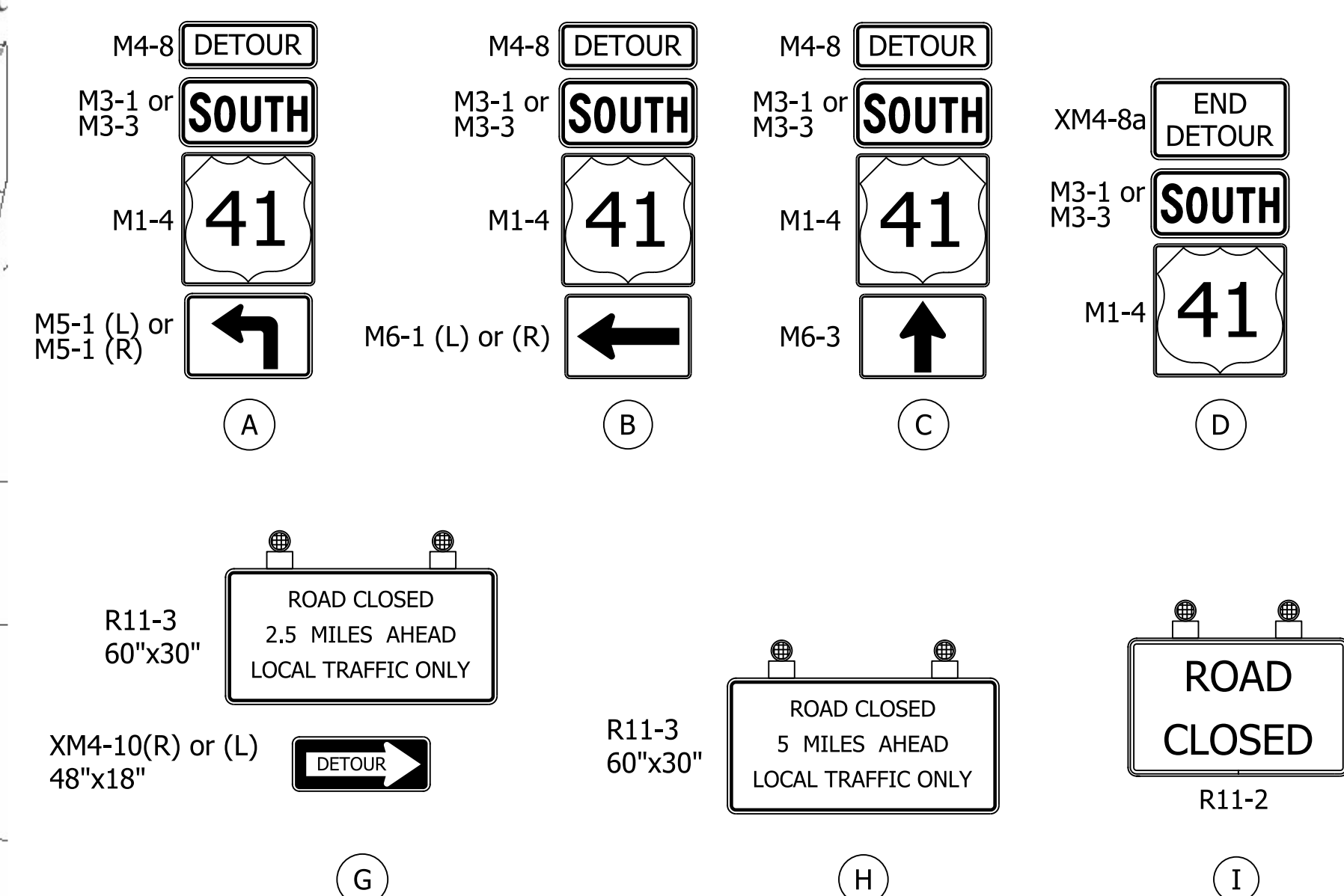
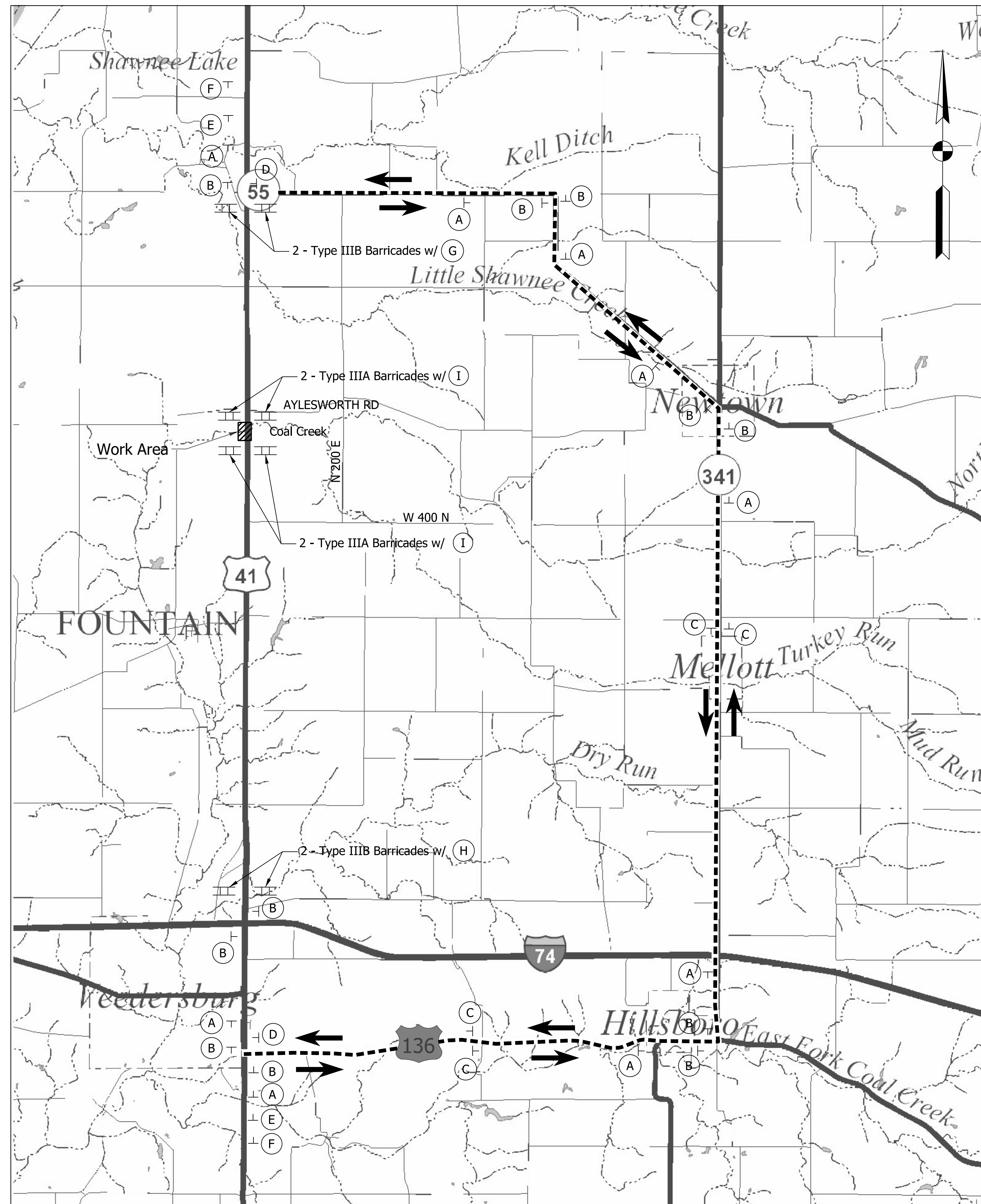

LEGEND

- :** Detour Route
- |-:** Typical Sign Standard (Road Closure Sign Assembly)
- |||:** Barricade, Type III
- ↑↓:** Detour Traffic

QUANTITY SUMMARY TABLE	
ITEM	QUANTITY
Construction Sign Type A	4 Each
Detour Route Marker Assembly	26 Each
Road Closure Sign Assembly	4 Each
Barricade Type IIIA	48 LFT
Barricade Type IIIB	48 LFT

- Notes:**
- Confirming detour route marker assemblies (C) shall be placed every 3 miles along US 136 and HWY 341.
 - Detour signing to be in accordance with INDOT STD. DWG. E801-TCDT-01.

NOTE TO REVIEWER: Comments have been received for MOT by INDOT, but will be implemented for next submittal

RECOMMENDED FOR APPROVAL _____ DESIGN ENGINEER _____ DATE _____	INDIANA DEPARTMENT OF TRANSPORTATION	HORIZONTAL SCALE N/A	BRIDGE FILE 041-23-10200
DESIGNED: _____ WVN _____ DRAWN: _____ SJC _____	MAINTENANCE OF TRAFFIC DETOUR ROUTE	VERTICAL SCALE N/A	DESIGNATION 1601078
CHECKED: _____ KAP _____ CHECKED: _____ KAP _____		SURVEY BOOK ELECTRONIC	SHEETS 5 of 17
		CONTRACT B-40580	PROJECT 1701589

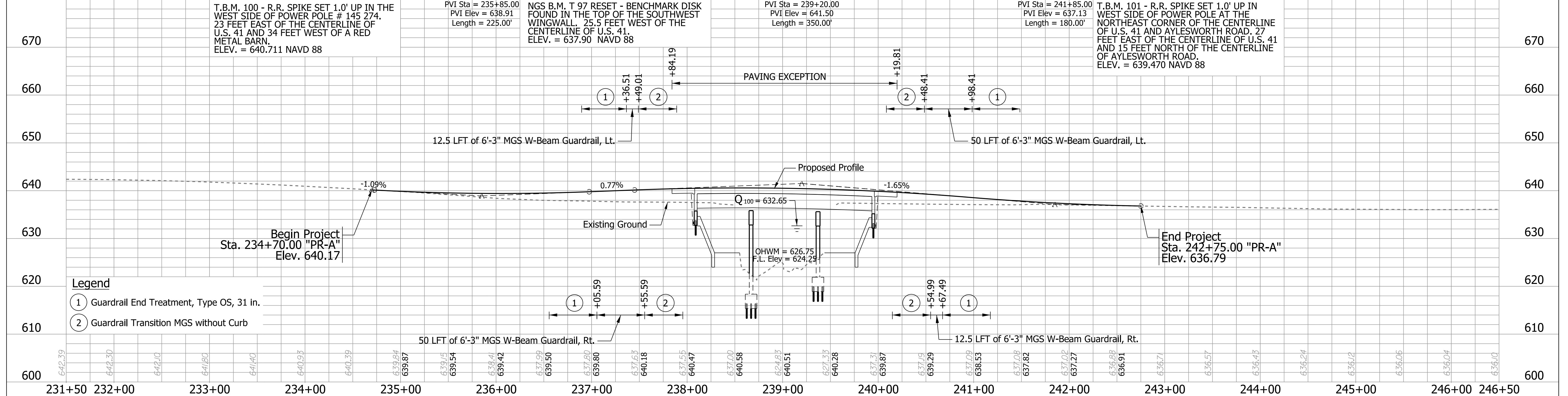
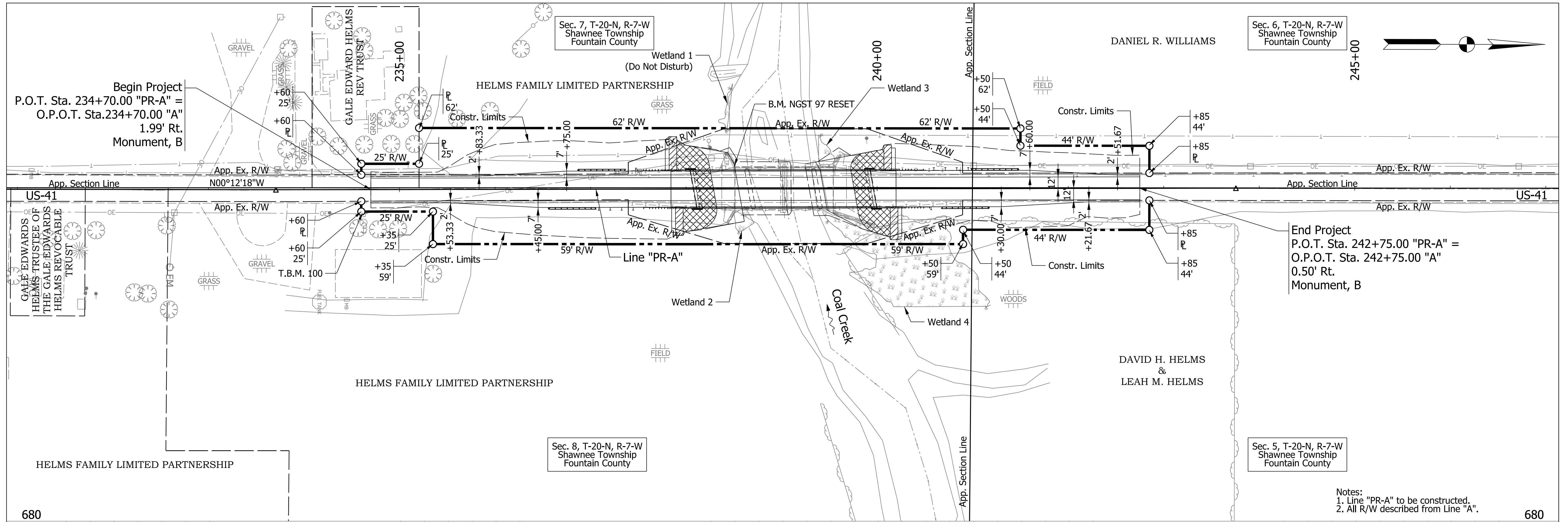

RECOMMENDED FOR APPROVAL		DESIGN ENGINEER		DATE	INDIANA DEPARTMENT OF TRANSPORTATION		HORIZONTAL SCALE		BRIDGE FILE	
DESIGNED: WN	DRAWN: SJC				PLAN & PROFILE SHEET US-41 OVER COAL CREEK LINE "PR-A"		1" = 50'		041-23-10200	
CHECKED: KAP	CHECKED: KAP						1" = 10'		1601078	
							SURVEY BOOK		SHEETS	
					CONTRACT		6 of 17		PROJECT	
					B-40580		1701589			

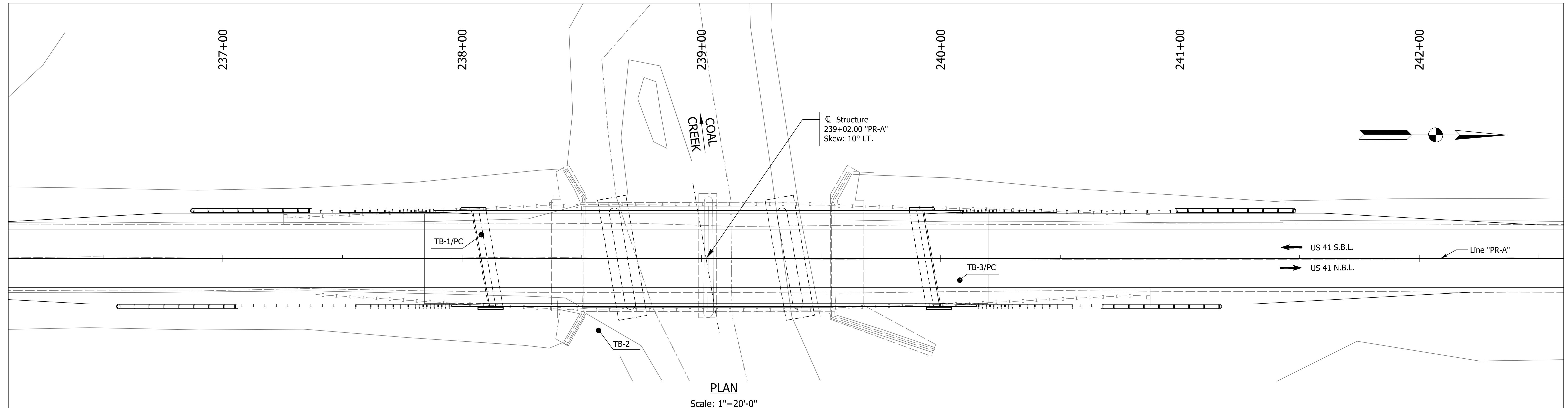

PILE LOADING FOR GEOTECHNICAL TESTING				
LOCATION	Bent No.1	Pier No.2	Pier No.3	Bent No.4
Pile Size, Type & Grade	HP 12x74 GRADE 50 ksi	HP 12x74 GRADE 50 ksi	HP 12x74 GRADE 50 ksi	HP 12x74 GRADE 50 ksi
Factored Design Load, Q _f (Kip)				
Factored Design Soil Resistance, R _r (Kip)				
Resistance Factor				
Downdrag Load, DD (Kip)				
Nominal Soil Resistance, R _n (Kip)*				
Downdrag Friction, R _s (Kip)				
Scour Zone Friction, R _n (Kip)				
Relaxation of Tip in Shale (Kip)				
Nominal Driving Resistance, R _{ndr} (Kip)				
Estimated Pile Tip Elevation (Minimum)				
Testing Method	PDA - ISS 701.05(b)			

NOTES:
 *In Calculation of DD, $\gamma_p = 1.4 \gamma_p$
 Soil boring information available from consultant upon request.

NOTE TO REVIEWER
 GEOTECHNICAL REPORT IS FORTHCOMING,
 PILE LOADING TABLE WILL BE COMPLETED
 WITH NEXT SUBMITTAL

LOG OF TEST BORING												
CLIENT : Parson's Transportation, Inc.					BORING NO.: TB-1/PC							
DES NO. : 1601078					SHEET : 1 OF 2							
PROJECT TYPE : Bridge Replacement					NORTHING : 1803455							
LOCATION : US 41 over Coal Creek					EASTING : 2908138							
COUNTY : Fountain					DATE STARTED : 01-16-20							
PROJECT NO. : CJ185102					DATE COMPLETED : 01-16-20							
ELEVATION : 637.0		BORING METHOD : Hollow Stem Auger		HAMMER : Auto								
STATION : 238+08		RIG TYPE : CME 750 ATV		DRILLER/WSP : C.M.								
OFFSET : 10.0 ft Left		CASING DIA. : ---		TEMPERATURE : 25 °F								
LINE : "PR-A"		CORE SIZE : ---		WEATHER : Clear								
DEPTH : 35.0 ft												
GROUNDWATER : <input checked="" type="checkbox"/> Encountered at 13.0 ft <input checked="" type="checkbox"/> At completion Dry												
ELEVATION	SAMPLE DEPTH	SOIL/MATERIAL DESCRIPTION	SAMPLE NUMBER	SPT Blows per ft	RECOVERY	MOISTURE CONTENT	DRY DENSITY, pcf	PROCTER LIMITS, %	UNSAT. COMP. %	ATTEBERG LIMITS	REMARKS	
635.0	2.5	Asphaltic Concrete	SS 1	19-11-7	72	10.4				LL 17	FI 7	-1.0, SS-11/B : pH = 8.1, SG = 2.69, soluble sulfate = 93 ppm
630.0	6.0	Sandy Loom, loose to medium dense, moist, gray, (fill), A-2-4(0), Lab No. 27370	SS 2	7-5-2	72	10.8						
625.0	7.5		SS 3	6-5-4	78	7.8						
620.0	10.0	Sandy Loom, loose to medium dense, moist, brown, with cohesive seam near 10 ft, (possible fill)	SS 4	9-5-7	72	17.0						
615.0	12.5		SS 5	10-14-14	72							
610.0	17.5	Gravelly Sand, medium dense to very dense, wet, brown, with sand sand gravel near 24 ft, A-1-B, Lab No. 27360	SS 6	17-19-20	72							
605.0	25.0		SS 7	23-41-50/3	77							
600.0	27.5	Weathered Shale, soft, brown and gray	RC 1									- 27.5, for slope index of 24 hr = 5
595.0	30.0											
590.0	32.5											
585.0	35.0											
580.0												
575.0												
570.0												
565.0												
560.0												
555.0												
550.0												
545.0												
540.0												
535.0												
530.0												
525.0												
520.0												
515.0												
510.0												
505.0												
500.0												
595.0												
590.0												
585.0												
580.0												
575.0												
570.0												
565.0												
560.0												
555.0												
550.0												
545.0												
540.0												
535.0												
530.0												
525.0												
520.0												
515.0												
510.0												
505.0												
500.0												
595.0												
590.0												
585.0												
580.0												
575.0												
570.0												
565.0												
560.0												
555.0												
550.0												
545.0												
540.0												
535.0												
530.0												
525.0												
520.0												
515.0												
510.0												
505.0												
500.0												

LOG OF TEST BORING											
CLIENT : Parson's Transportation, Inc.					BORING NO.: TB-1/PC						
DES NO. : 1601078					SHEET : 2 OF 2						
PROJECT TYPE : Bridge Replacement					NORTHING : 1803455						
LOCATION : US 41 over Coal Creek					EASTING : 2908138						
COUNTY : Fountain					DATE STARTED : 01-16-20						
PROJECT NO. : CJ185102					DATE COMPLETED : 01-16-20						
ELEVATION : 637.0		BORING METHOD : Hollow Stem Auger		HAMMER : Auto							
STATION : 238+08		RIG TYPE : CME 750 ATV		DRILLER/WSP : C.M.							
OFFSET : 10.0 ft Left		CASING DIA. : ---		TEMPERATURE : 25 °F							
LINE : "PR-A"		CORE SIZE : ---		WEATHER : Clear							
DEPTH : 35.0 ft											
GROUNDWATER : <input checked="" type="checkbox"/> Encountered at 13.0 ft <input checked="" type="checkbox"/> At completion Dry											
ELEVATION	SAMPLE DEPTH	SOIL/MATERIAL DESCRIPTION	SAMPLE NUMBER	SPT Blows per ft	RECOVERY	MOISTURE CONTENT	DRY DENSITY, pcf	PROCTER LIMITS, %	UNSAT. COMP. %	ATTEBERG LIMITS	REMARKS
605.0	32.5	Weathered Shale, soft, brown and gray	RC 1								
600.0	35.0										
595.0											
590.0											
585.0											
580.0											
575.0											
570.0											
565.0											
560.0											
555.0											
550.0											
545.0											
540.0											
535.0											
530.0											
525.0											
520.0											
515.0											
510.0											
505.0											
500.0											
595.0											
590.0											
585.0											
580.0											
575.0											
570.0											
565.0											
560.0											
555.0											
550.0											
545.0											
540.0											
535.0											
530.0											
525.0											
520.0											
515.0											
510.0											
505.0											
500.0											

RECOMMENDED FOR APPROVAL _____ DESIGN ENGINEER _____ DATE _____ DESIGNED: <u>ZMR</u> DRAWN: <u>JEW</u> CHECKED: <u>AAH</u> CHECKED: <u>AAH</u>	INDIANA DEPARTMENT OF TRANSPORTATION SOIL BORINGS	<table border="1" style="width: 100%;"> <tr> <td>HORIZONTAL SCALE</td> <td>BRIDGE FILE</td> </tr> <tr> <td>AS NOTED</td> <td>041-23-10200</td> </tr> <tr> <td>VERTICAL SCALE</td> <td>DESIGNATION</td> </tr> <tr> <td>AS NOTED</td> <td>1601078</td> </tr> <tr> <td>SURVEY BOOK</td> <td>SHEETS</td> </tr> <tr> <td>ELECTRONIC</td> <td>7 of 17</td> </tr> <tr> <td>CONTRACT</td> <td>PROJECT</td> </tr> <tr> <td>B-40580</td> <td>1701589</td> </tr> </table>	HORIZONTAL SCALE	BRIDGE FILE	AS NOTED	041-23-10200	VERTICAL SCALE	DESIGNATION	AS NOTED	1601078	SURVEY BOOK	SHEETS	ELECTRONIC	7 of 17	CONTRACT	PROJECT	B-40580	1701589
HORIZONTAL SCALE	BRIDGE FILE																	
AS NOTED	041-23-10200																	
VERTICAL SCALE	DESIGNATION																	
AS NOTED	1601078																	
SURVEY BOOK	SHEETS																	
ELECTRONIC	7 of 17																	
CONTRACT	PROJECT																	
B-40580	1701589																	

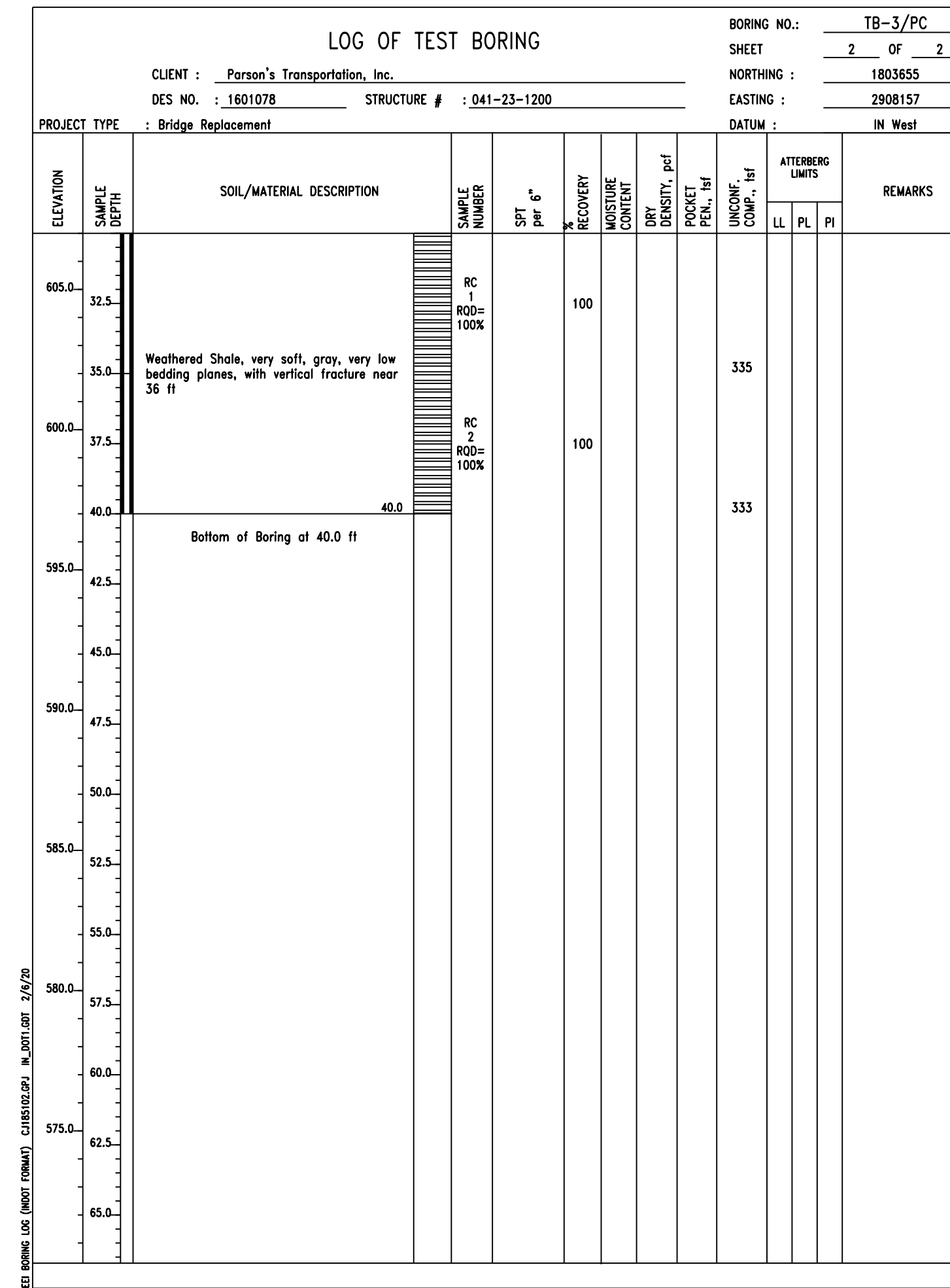
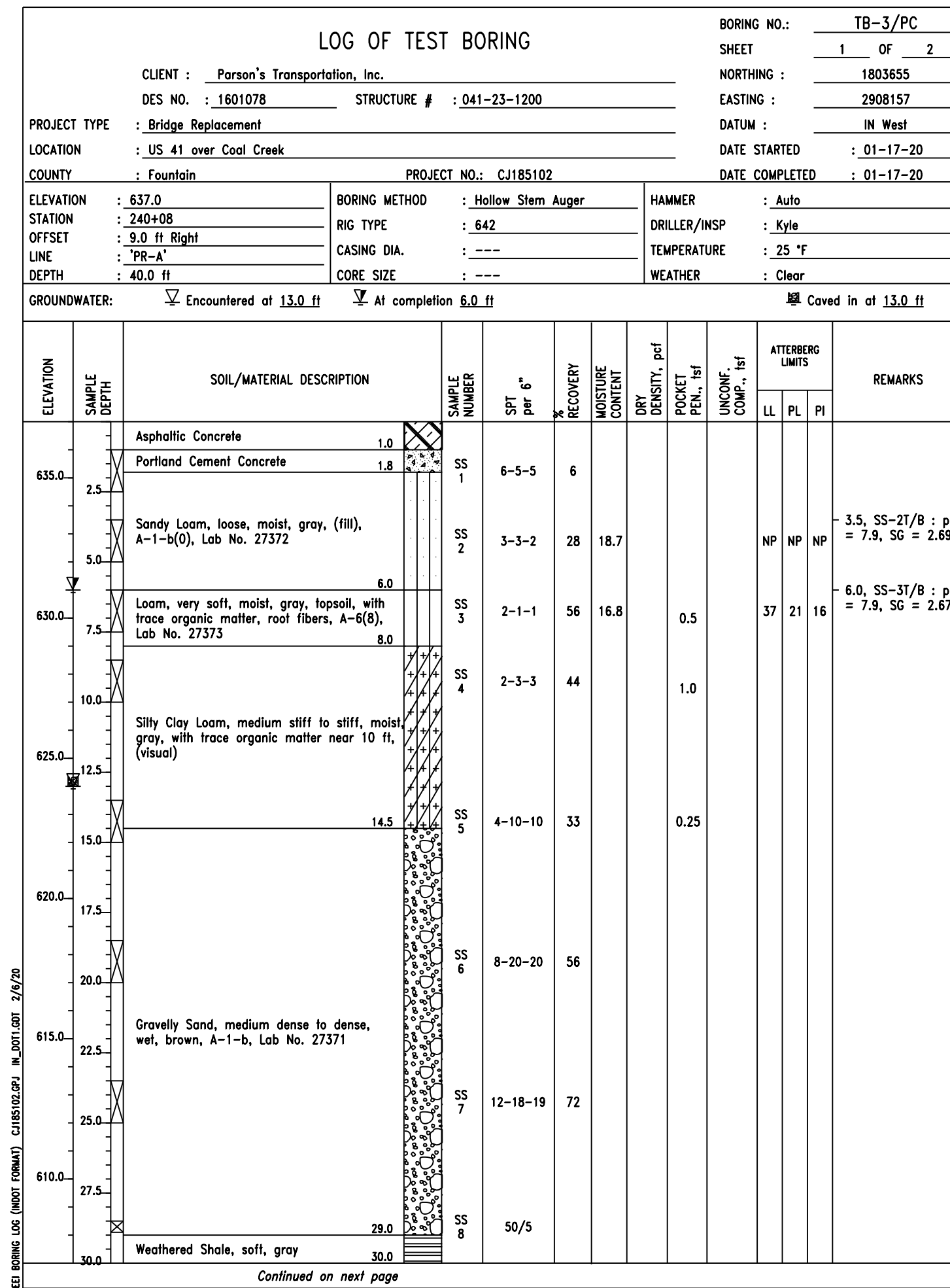
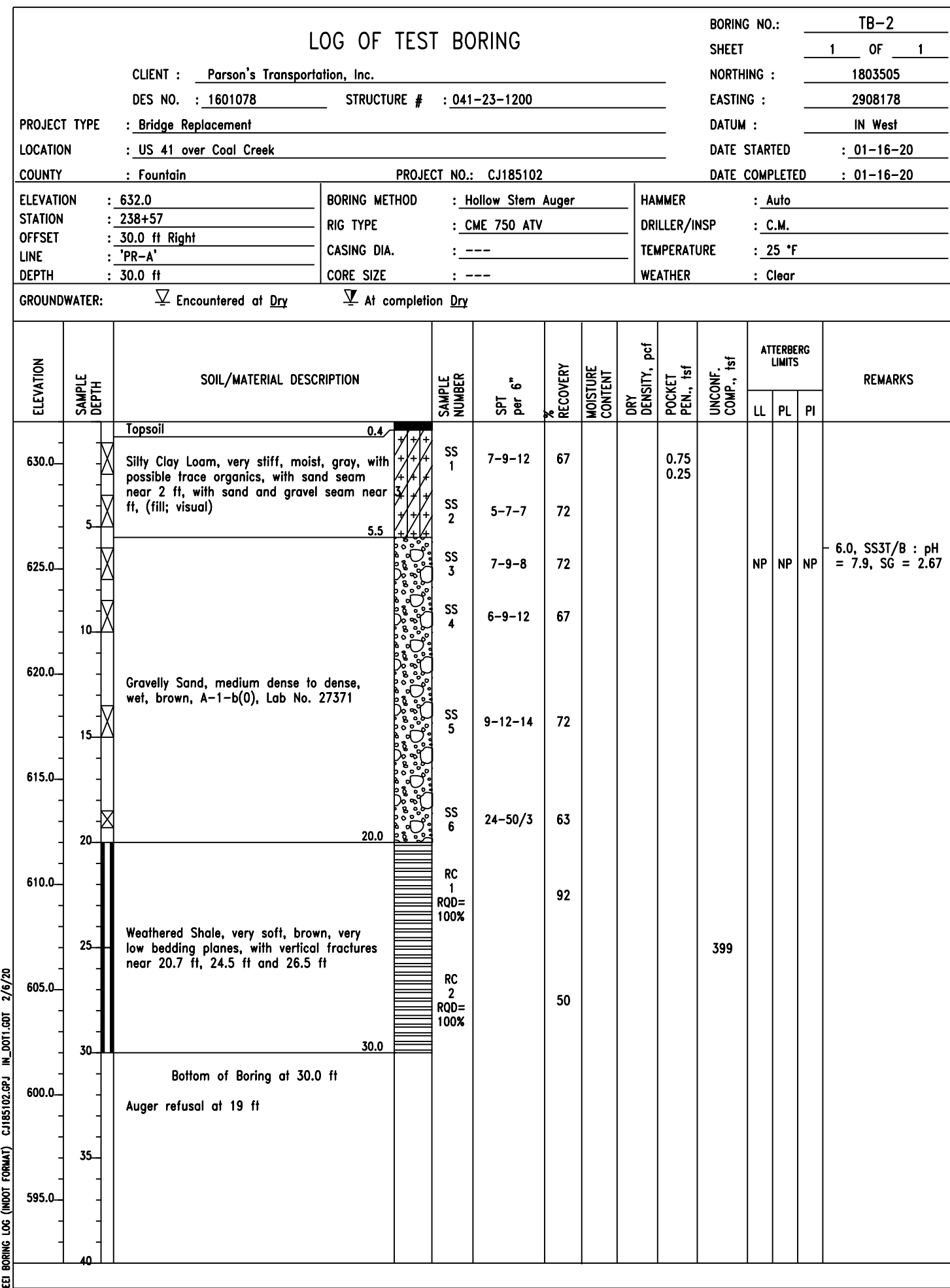

RECOMMENDED FOR APPROVAL _____ DATE _____
DESIGN ENGINEER

DESIGNED: ZMR DRAWN: JEW
CHECKED: AAH CHECKED: AAH

INDIANA
DEPARTMENT OF TRANSPORTATION

SOIL BORINGS

HORIZONTAL SCALE	BRIDGE FILE
AS NOTED	041-23-10200
VERTICAL SCALE	DESIGNATION
AS NOTED	1601078
SURVEY BOOK	SHEETS
ELECTRONIC	8 of 17
CONTRACT	PROJECT
B-40580	1701589

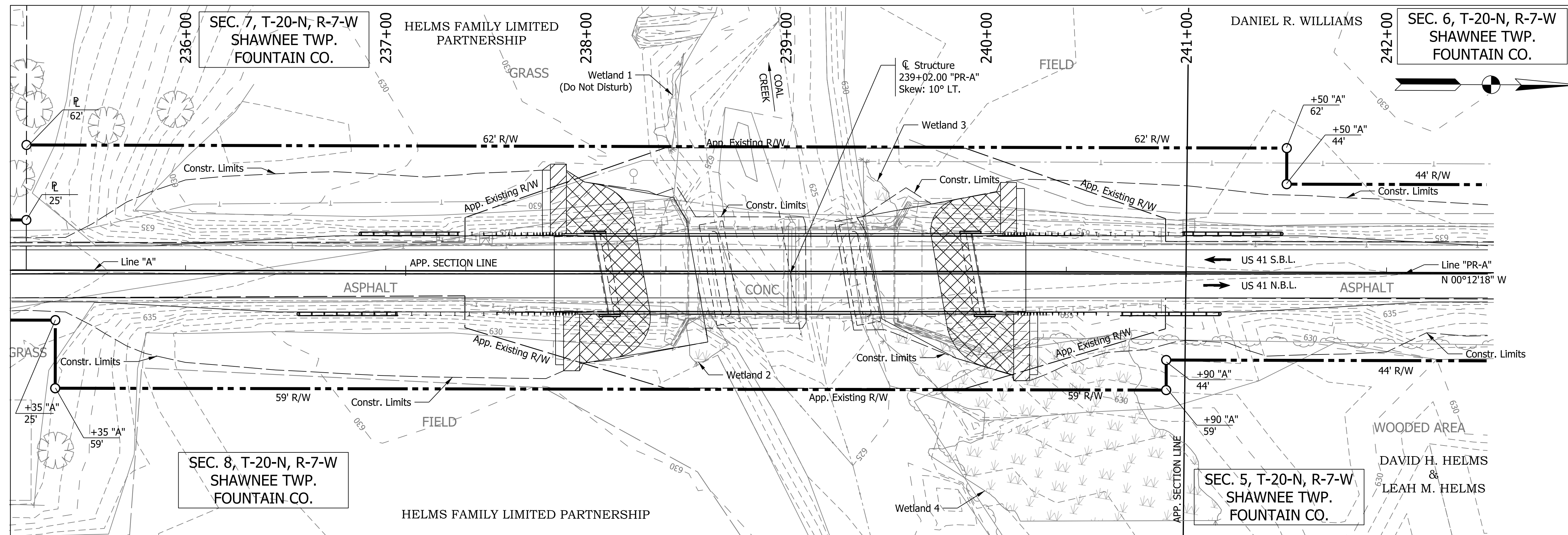

EXISTING STRUCTURE
 The existing reinforced concrete arch bridge (41-0-3885A) was built in 1942 and widened in 1967, with 2 spans: 50'-0" with a 43'-0" min. clear roadway. Existing structure to be removed.

HYDRAULIC SCOUR DATA

Q100 Discharge	= 6,960 Cfs.
Q100 Elev.	= 632.65 Ft. (NAVD 88)
Scour Depth	= 13.33 Ft.
Low Scour Elev.	= 610.92 Ft.
Q500 Discharge	= 9,400 Cfs.
Q500 Elev.	= 633.08 Ft.
Scour Depth	= 16.73 Ft.
Low Scour Elev.	= 607.25 Ft.

Based on Flowline Elev. 624.25 Ft.

HYDRAULIC DATA

Drainage Area	= 62.49 Sq. Mi.
Discharge (Q100)	= 6,960 Cfs.
Q100 Elev.	= 632.65 Ft. (NAVD 88)
Back Water @ Q100	= 0.88 Ft.
Velocity @ Q100	= 6.73 Ft./Sec.
Waterway Opening Required (Below Elev. 632.65)	= 1,062 Sft.
Waterway Opening Provided (Below Elev. 632.65)	= 1,126 Sft.
Min. Low Structure Elev.	= 635.58 Ft.

NOTES:
 For R/W and Additional information see Roadway Plan & Profile sheet.
 For Utility Contacts see Index Sheet No.2
 Cross-Hatched areas indicate limits of class I riprap Over Geotextiles. (Est. Riprap Qty. = 574 Tons) (Est. Geotextile Qty. = 529 Sys)
 Hatched areas indicate limits of revetment riprap for riprap drainage turnouts. (Est. Riprap Qty. = 94 Tons) (Est. Geotextiles Qty. = 122 Sys.)

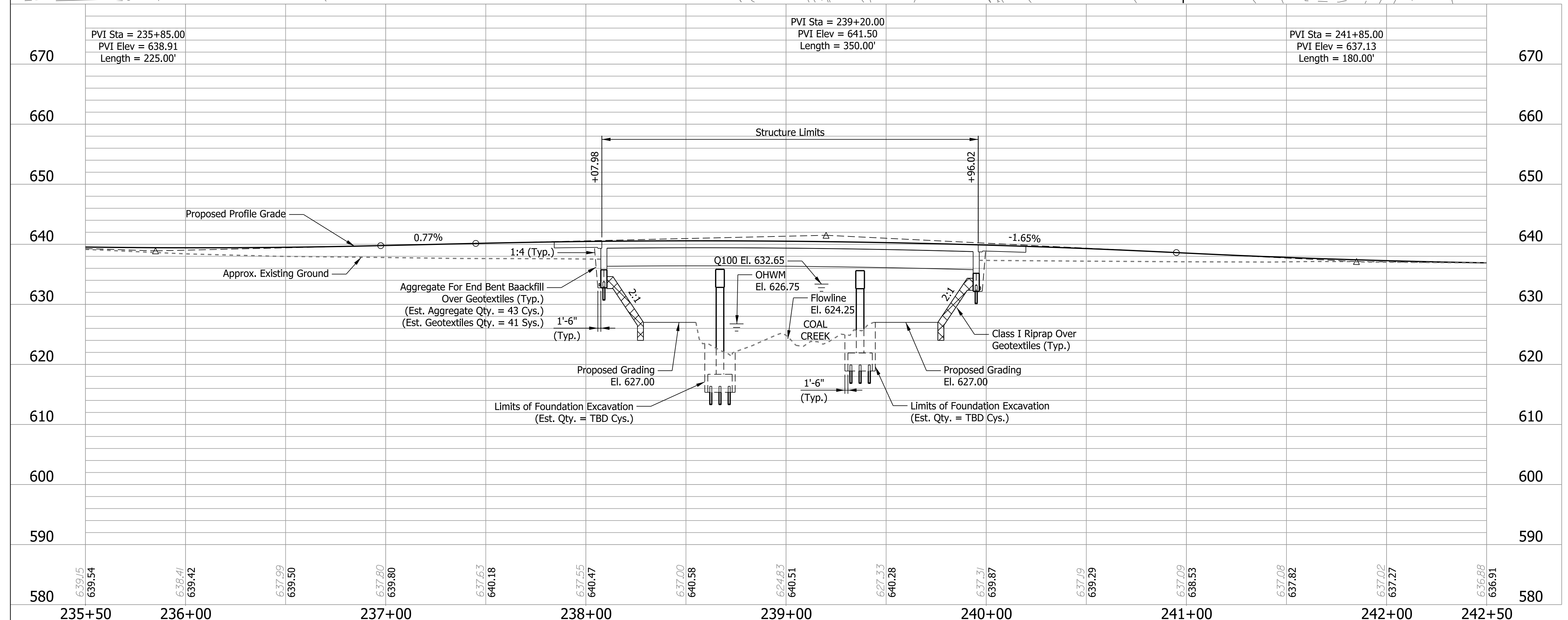

**CONTINUOUS COMPOSITE
 PRESTRESSED CONCRETE BULB-TEE BEAM BRIDGE**
 3 SPANS: 58'-0", 70'-0", 58'-0"
 37'-4" CLEAR ROADWAY; SKEW: 10°00'00" LT
 US 41 OVER COAL CREEK
 FOUNTAIN COUNTY

RECOMMENDED FOR APPROVAL	DESIGN ENGINEER	DATE	INDIANA DEPARTMENT OF TRANSPORTATION	HORIZONTAL SCALE	BRIDGE FILE
DESIGNED: ZMR	DRAWN: EWM			1" = 30'	041-23-10200
CHECKED: AAH	CHECKED: AAH			VERTICAL SCALE	DESIGNATION
			LAYOUT	1" = 10'	1601078
				SURVEY BOOK	SHEETS
				ELECTRONIC	9 of 17
				CONTRACT	PROJECT
				B-40580	1701589

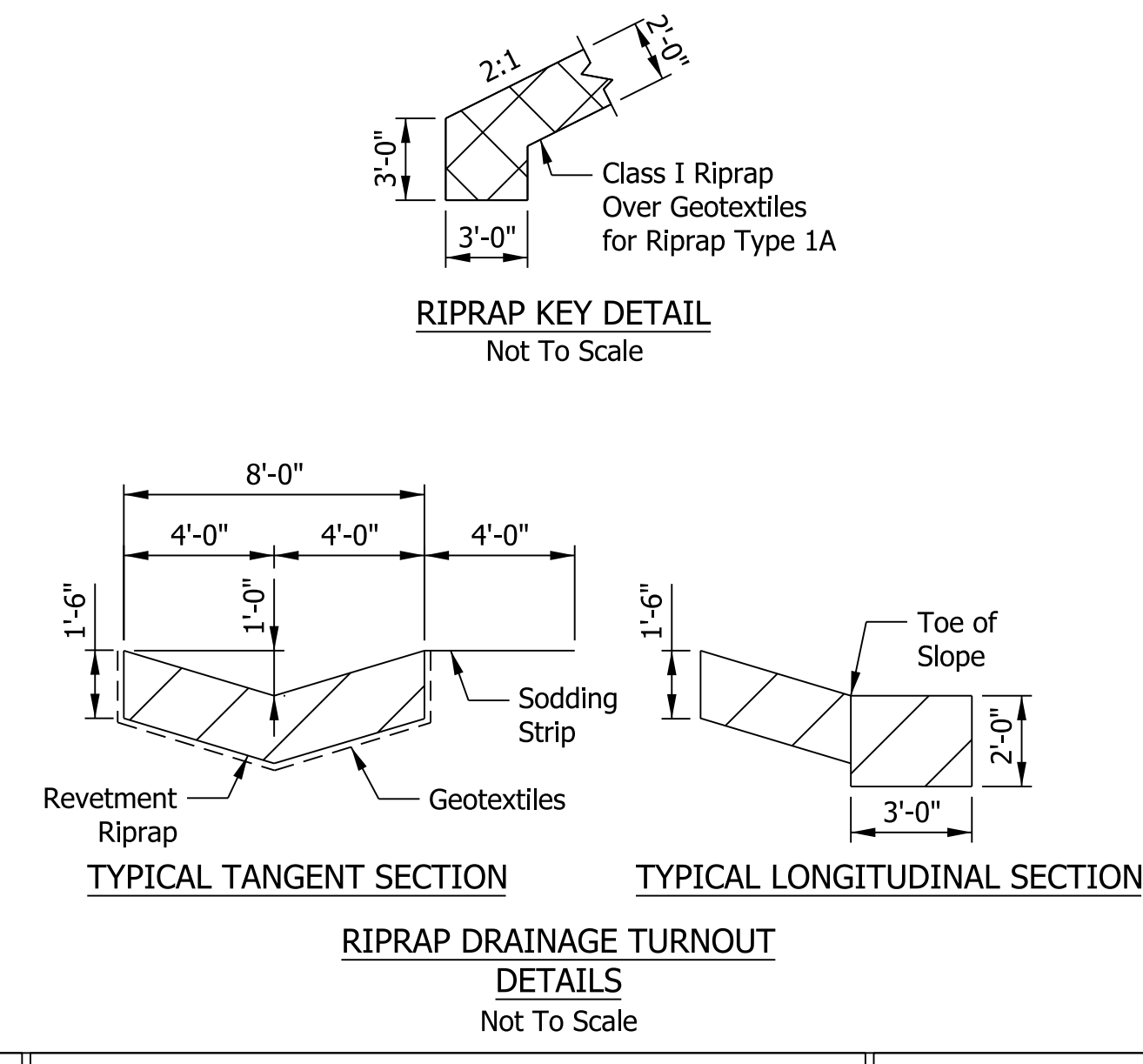
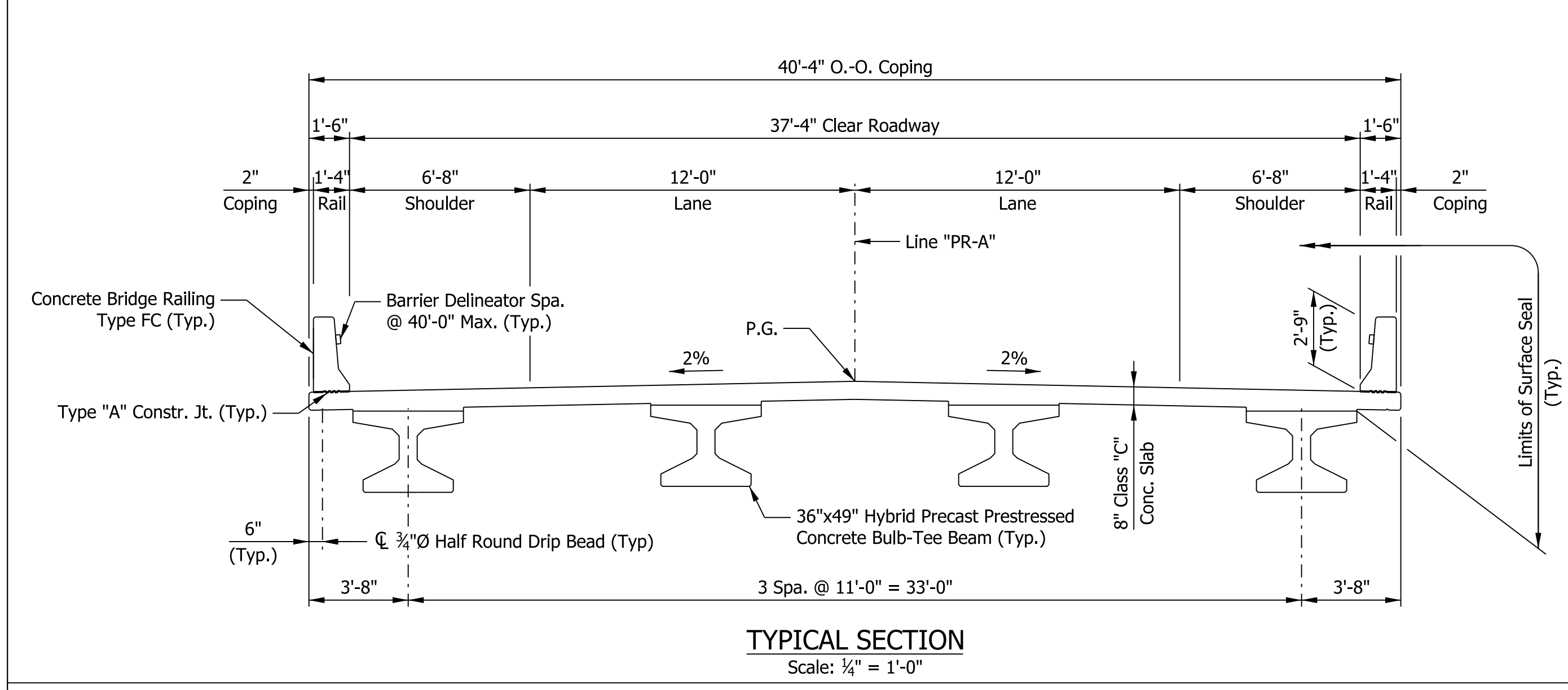
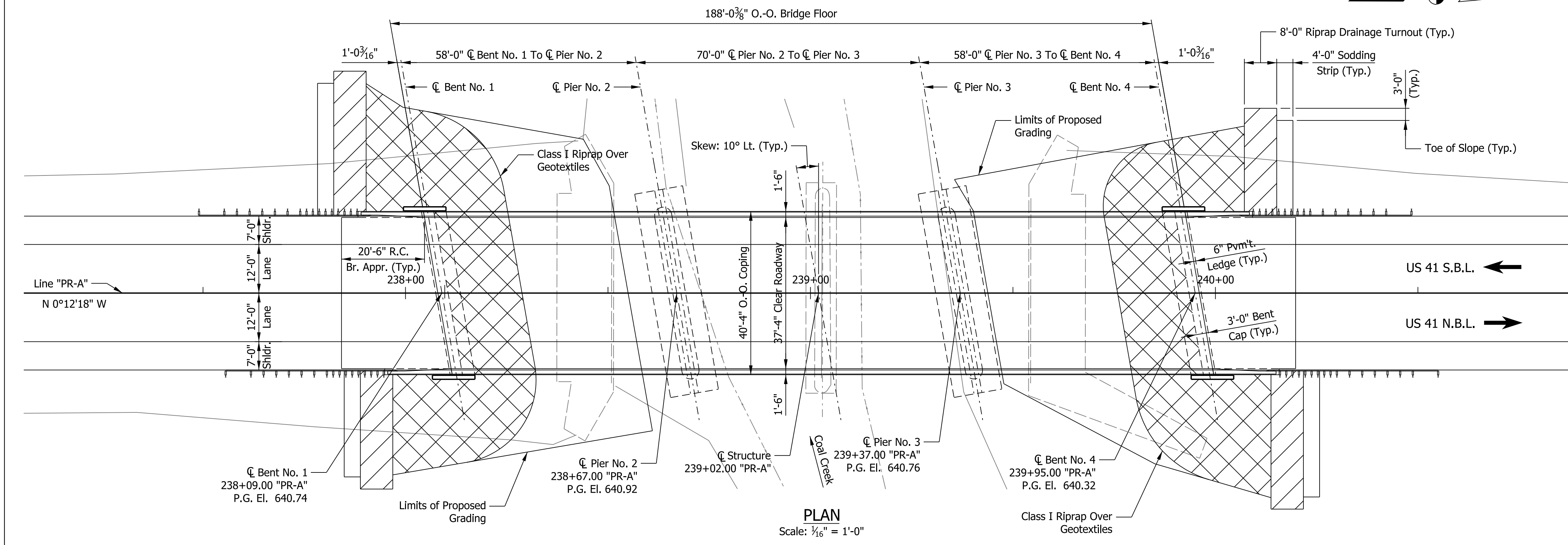
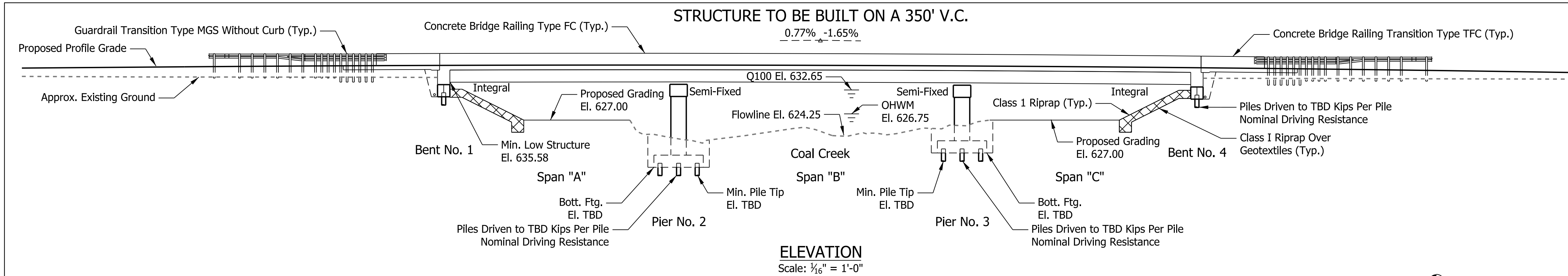

GENERAL NOTES

Reinforcing steel covering shall be 2 1/2" in Top and 1" min.
In bottom of floor slabs, 3" in footing except bottom steel which shall be 4", and 2" in all other parts, unless noted.

DESIGN DATA

Superstructure & Substructure Designed for HL-93 Loading in accordance with AASHTO LRFD Bridge Design Specifications Eighth Edition, 2017. Designed for actual dead load plus 35 psf of future wearing surface and 15 psf for SIP Metal deck forms. Slab designed with a 7 1/2" structural depth, and a 1/2" integral wearing surface.

DESIGN STRESSES

CONCRETE	
Prestressed Concrete	f _c = 8,000 p.s.i.
Class "A" Concrete	f _c = 3,500 p.s.i.
Class "B" Concrete	f _c = 3,000 p.s.i.
Class "C" Concrete	f _c = 4,000 p.s.i.

REINFORCING STEEL	
Grade 60	f _y = 60,000 p.s.i.

CONSTRUCTION LOADING

The exterior girder has been checked for strength, deflection, and overturning using the construction loads shown below. Cantilever overhang brackets were assumed for support of the deck overhang past the edge of the exterior girder. The finishing machine was assumed to be supported 6" outside the vertical coping form. The top overhang brackets were assumed to be located 6" past the edge of the vertical coping form. The bottom overhang brackets were assumed to be braced against the intersection of the girder bottom flange and web.

DECK FALSEWORK LOADS

Designed for 15 lb/Sft for permanent metal stay-in-place deck forms, removable deck forms, and 2-ft exterior walkway.

CONSTRUCTION LIVE LOAD

Designed for 20 lb/Sft extending 2-ft past the edge of coping and 75 lb/ft vertical force applied at a distance of 6 in. outside the face of coping over a 30-ft length of the deck centered with the finishing machine.

FINISHING MACHINE LOAD

4500 lb distributed over 10-ft along the coping.

WIND LOAD

Structure Designed for 70 mph horizontal wind loading in accordance with LRFD 3.8.1.

SEISMIC DESIGN DATA

Seismic Performance Zone	Zone TBD
Acceleration Coefficient (S _{D1})	TBD
Seismic Soil Profile Type	Site Class TBD

NOTES:
Hatching indicates limits of Revetment Riprap over Geotextiles
Cross-Hatching indicates limits of Class I Riprap.

**CONTINUOUS COMPOSITE
PRESTRESSED CONCRETE BULB-TEE BEAM BRIDGE**
3 SPANS: 58'-0", 70'-0", 58'-0"
37'-4" CLEAR ROADWAY; SKEW: 10°00'00" LT
US 41 OVER COAL CREEK
FOUNTAIN COUNTY

RECOMMENDED FOR APPROVAL _____ DESIGN ENGINEER DATE	INDIANA DEPARTMENT OF TRANSPORTATION	HORIZONTAL SCALE AS NOTED	BRIDGE FILE 041-23-10200
		VERTICAL SCALE AS NOTED	DESIGNATION 1601078
DESIGNED: ZMR CHECKED: AAH	DRAWN: EWM CHECKED: AAH	GENERAL PLAN	
		SURVEY BOOK B-40580	SHEETS 10 of 17 PROJECT 1701589

PAVEMENT QUANTITIES AND APPROACH TABLE

LOCATION	DESCRIPTION (APPROACH TYPE OR CLASS)	WIDTH	LENGTH	RADI	DISTANCE BEYOND R/W LINE	SURFACE BEYOND R/W LINE			GRADE				EXCAVATION		PAVEMENT REMOVAL	CLEAR ZONE AT DRIVE	SUBGRADE TREATMENT, TYPE IC, MODIFIED	SUBGRADE TREATMENT, TYPE IC	MILLING, ASPHALT, 1 1/2 IN.	HMA FOR APPROACHES					LIQUID ASPHALT SEALANT	JOINT ADHESIVE, SURFACE	JOINT ADHESIVE, INTERMEDIATE	HMA MATERIAL FOR:		COMPACTED AGGREGATE			GEOTEXTILE FOR SUBGRADE TYPE 2A	COMPACTED AGGREGATE FOR SURFACE NO. 73		MILLED HMA CORRUGATIONS, SINUSOIDAL	REMARKS	
						COMPACTED AGGREGATE BASE	HMA	CONCRETE	1	2	3	4	CUT	FILL						HMA MATERIALS								PRIME COAT	TACK COAT	NO. 53	NO. 53	NO. 5		DEPTH				
																				LBS. PER SYD.														LBS. PER SYD.				
						FT	FT	FT	FT	SYS	SYS	SYS	%	%						%	%	CYS	CYS	SYS				FT	SYS	SYS	SYS	SYS		SYS	SYS			SYS
Line "PR-A"																																						
Entire Project	234+70.00 to 242+75.00																																					
South of Bridge	234+70.00 to 237+84.19																																					
North of Bridge	240+19.81 to 242+75.00																																					
TOTALS																																						

GUARDRAIL SUMMARY TABLE

LOCATION		W-BEAM GUARDRAIL LENGTH											CURVED W-BEAM				REMARKS						
FROM STATION	TO STATION	LEFT	MEDIAN LEFT	MEDIAN RIGHT	RIGHT	STANDARD POST AT 6 FT 3 IN. SPA.	MGS W-BEAM, 6 FT 3 IN SPA.	STANDARD POST AT 3 FT 1.5 IN. SPA.	DOUBLE FACED AT 6 FT 3 IN. SPA.	MGS HEADWALL-MOUNTED POSTS	W-BEAM, NESTED GUARDRAIL	GUARDRAIL END TREATMENT, OS 31"	GUARDRAIL, MGS, W-BEAM, CABLE, TERMINAL ANCHOR	GUARDRAIL MGS TRANSITION WITHOUT CURB	TERMINAL SYSTEM			CONNECTOR SYSTEM		GUARDRAIL REMOVE	GUARDRAIL RESET		
															TYPE	EACH		TYPE	EACH			LFT	LFT
236+75.00	237+84.19	X					12.50					1		1								126	
236+75.00	237+84.19				X		50.00					1		1								114	
240+19.81	242+75.00	X					50.00					1		1								127	
240+19.81	242+75.00				X		12.50					1		1								130	
TOTALS							125					4		4								497	

RECOMMENDED FOR APPROVAL _____ DESIGN ENGINEER DATE	INDIANA DEPARTMENT OF TRANSPORTATION		HORIZONTAL SCALE N/A	BRIDGE FILE 041-23-10200
DESIGNED: <u>KAP</u> DRAWN: <u>KAP</u>	MISCELLANEOUS TABLES		VERTICAL SCALE N/A	DESIGNATION 1601078
CHECKED: <u>CAC</u> CHECKED: <u>CAC</u>			SURVEY BOOK ELECTRONIC	SHEETS 12 of 17
			CONTRACT B-40580	PROJECT 1701589

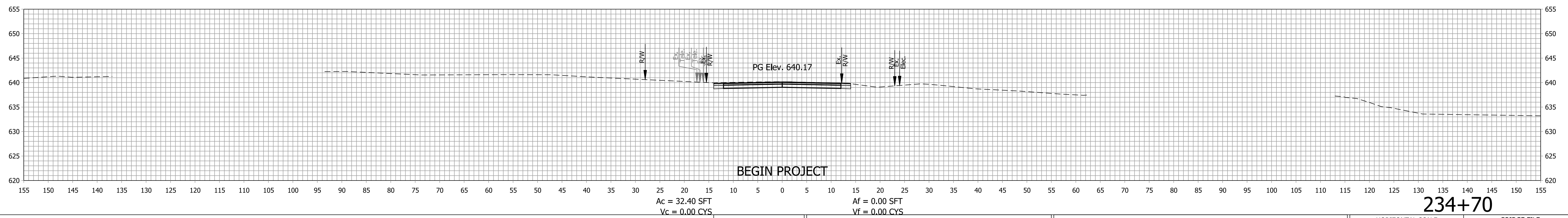
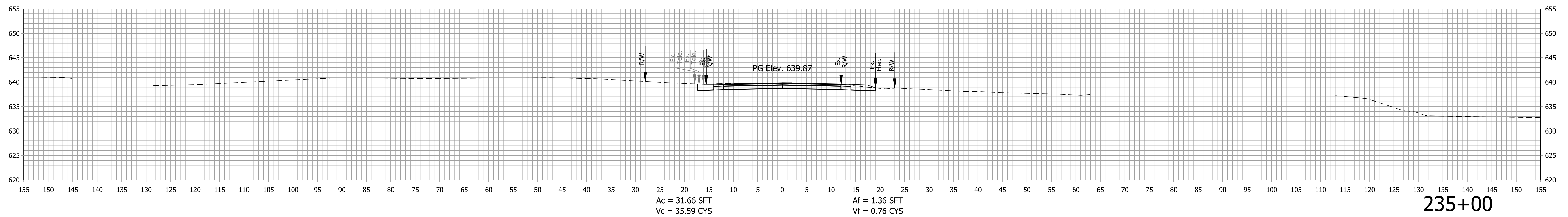
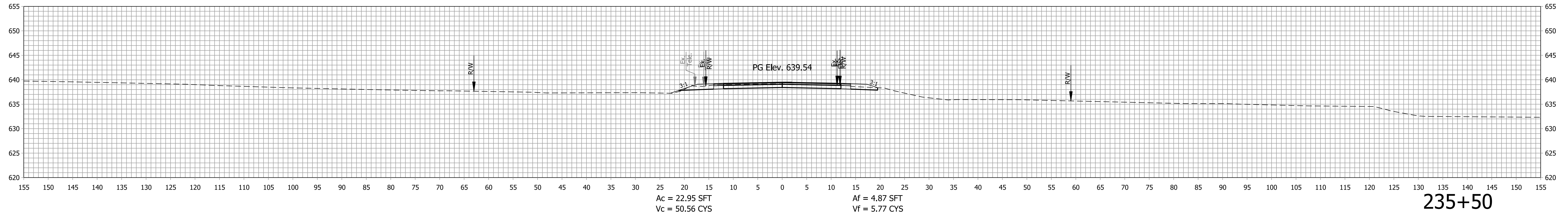

RECOMMENDED FOR APPROVAL _____	DESIGN ENGINEER _____	DATE _____
DESIGNED: <u>KAP</u>	DRAWN: <u>KAP</u>	
CHECKED: <u>CAC</u>	CHECKED: <u>CAC</u>	

**INDIANA
DEPARTMENT OF TRANSPORTATION**

**CROSS SECTIONS
US 41 OVER COAL CREEK**

HORIZONTAL SCALE 1" = 10'	BRIDGE FILE 041-23-10200
VERTICAL SCALE 1" = 10'	DESIGNATION 1601078
SURVEY BOOK ELECTRONIC	SHEETS of
CONTRACT B-40580	PROJECT 1701589

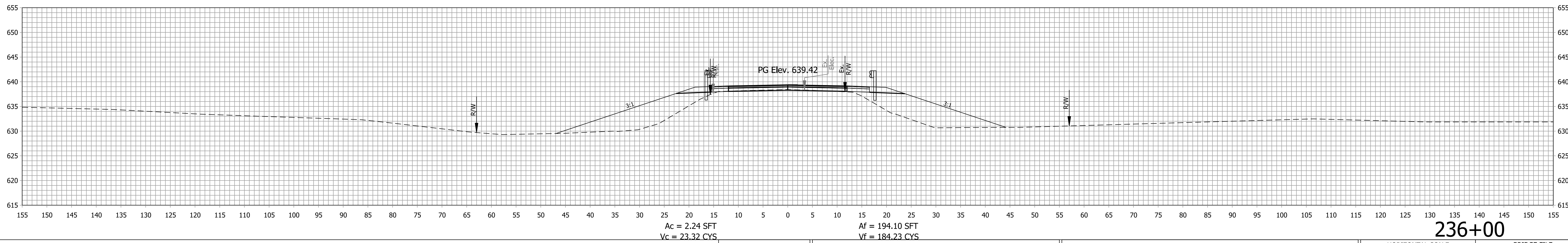
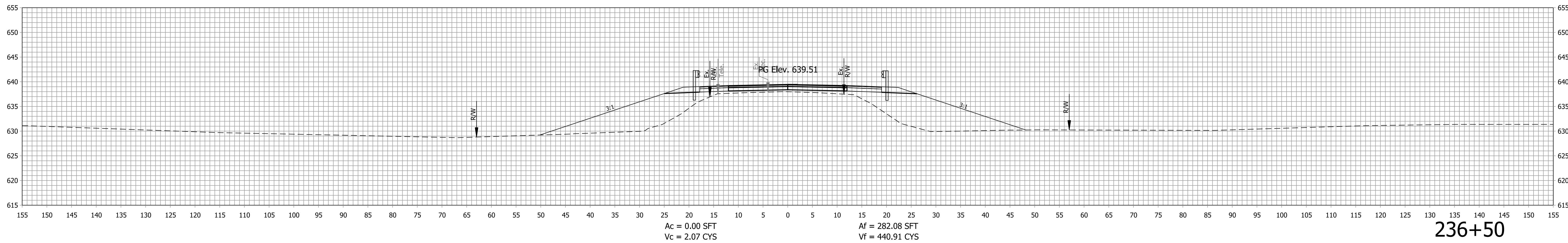
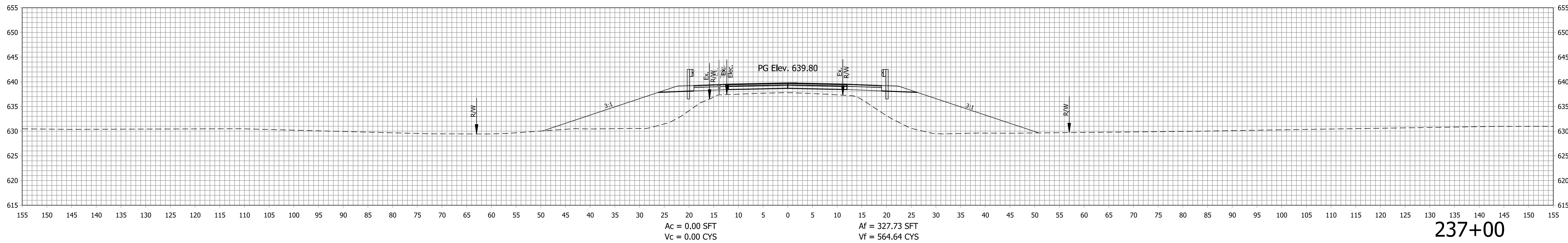

RECOMMENDED FOR APPROVAL _____	DESIGN ENGINEER _____	DATE _____
DESIGNED: KAP	DRAWN: KAP	
CHECKED: CAC	CHECKED: CAC	

INDIANA
DEPARTMENT OF TRANSPORTATION

CROSS SECTIONS
US 41 OVER COAL CREEK

HORIZONTAL SCALE 1" = 10'	BRIDGE FILE 041-23-10200
VERTICAL SCALE 1" = 10'	DESIGNATION 1601078
SURVEY BOOK ELECTRONIC	SHEETS of
CONTRACT B-40580	PROJECT 1701589

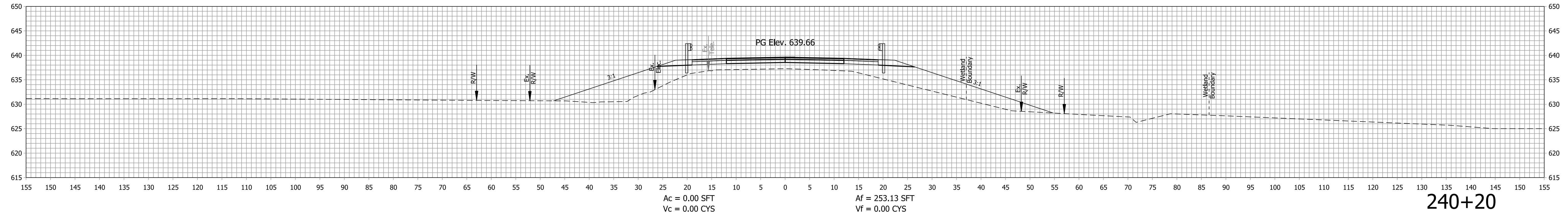

PAVING EXCEPTION
STA. 234+84.19 TO STA. 240+19.81

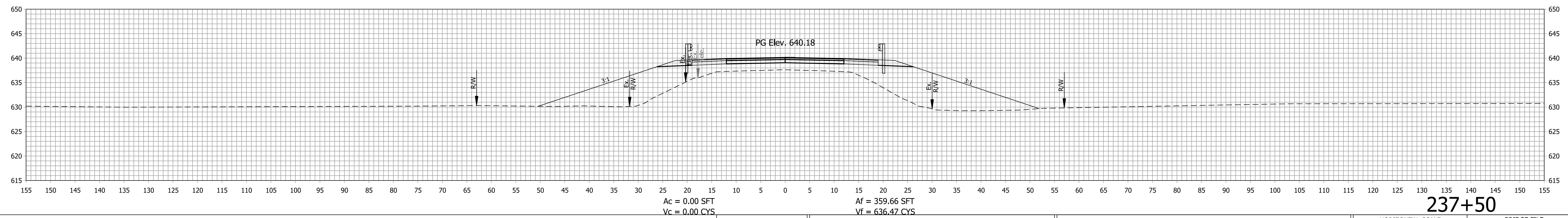
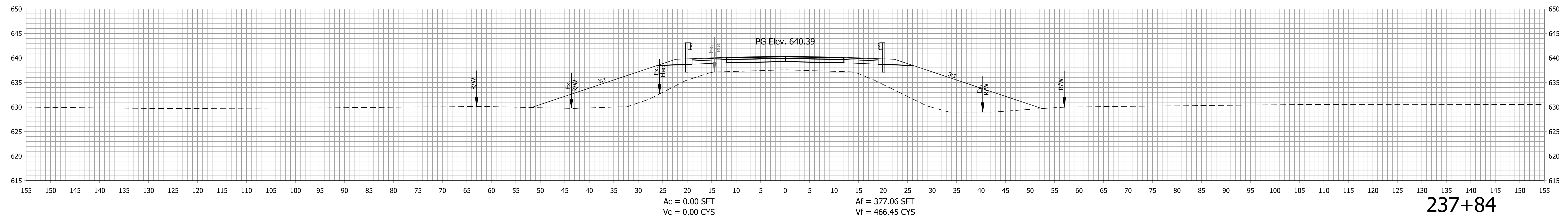

RECOMMENDED FOR APPROVAL _____	DESIGN ENGINEER _____	DATE _____
DESIGNED: KAP	DRAWN: KAP	
CHECKED: CAC	CHECKED: CAC	

INDIANA
DEPARTMENT OF TRANSPORTATION

CROSS SECTIONS
US 41 OVER COAL CREEK

HORIZONTAL SCALE 1" = 10'	BRIDGE FILE 041-23-10200
VERTICAL SCALE 1" = 10'	DESIGNATION 1601078
SURVEY BOOK ELECTRONIC	SHEETS of
CONTRACT B-40580	PROJECT 1701589

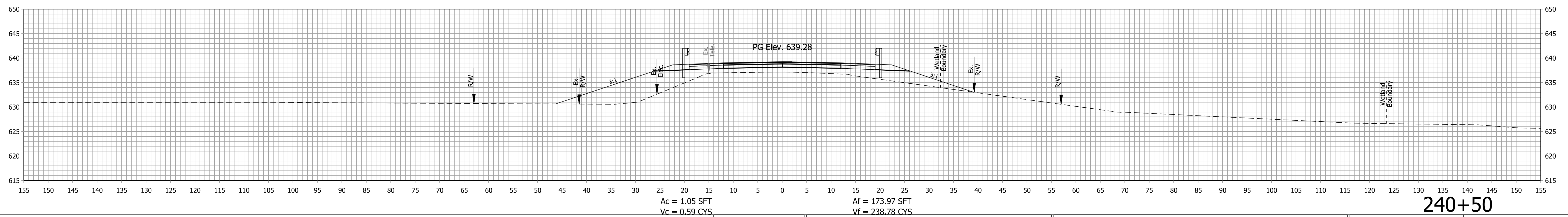
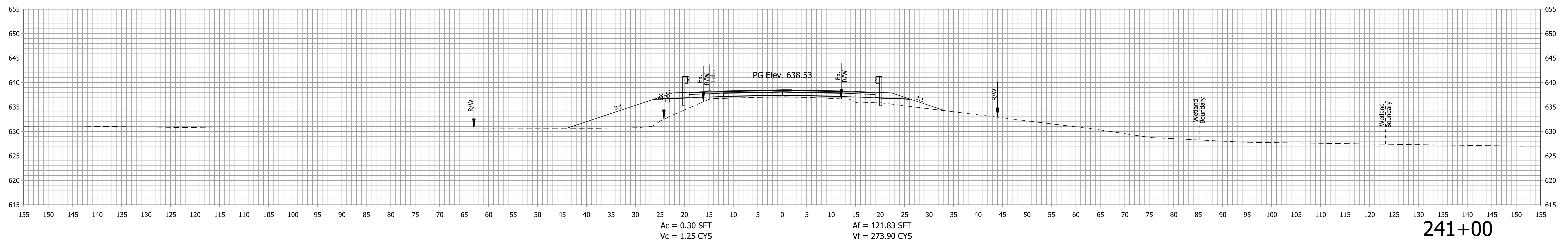
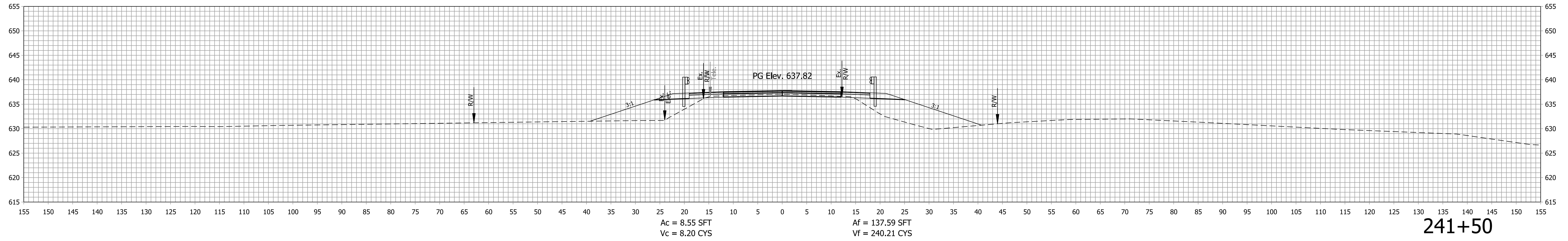

RECOMMENDED FOR APPROVAL	DESIGN ENGINEER	DATE
DESIGNED: KAP	DRAWN: KAP	
CHECKED: CAC	CHECKED: CAC	

INDIANA
DEPARTMENT OF TRANSPORTATION

CROSS SECTIONS
US 41 OVER COAL CREEK

HORIZONTAL SCALE 1" = 10'	BRIDGE FILE 041-23-10200
VERTICAL SCALE 1" = 10'	DESIGNATION 1601078
SURVEY BOOK ELECTRONIC	SHEETS of
CONTRACT B-40580	PROJECT 1701589

