

INDIANA DEPARTMENT OF TRANSPORTATION

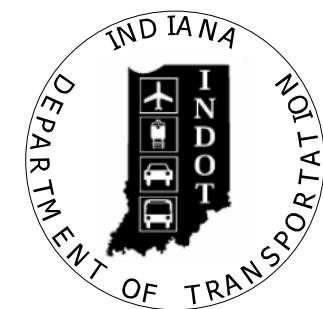

BRIDGE REHABILITATION PLANS

FOR SPANS OVER 20 FEET

ROUTE: I-65 AT: RP 24+73 (NBL) 24+74 (SBL)

PROJECT NO. 2001604 & 2001605 P.E.

NO ADDITIONAL RIGHT-OF-WAY
REQUIRED FOR THIS PROJECT

R/W

1700135 CONST.

This Bridge Superstructure replacement of the North and South Bound Bridges is on I-65 over Pigeon Roost Creek located approximately 4.58 miles South of State Road 56 in Section 7, T 2 N, R 7 E Vienna Township, Scott County, Indiana. (38° 37' 12" N, 85° 46' 58" W)

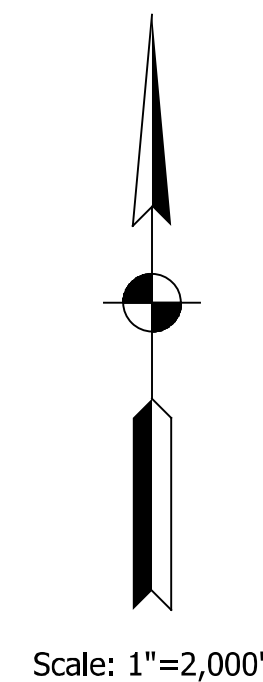
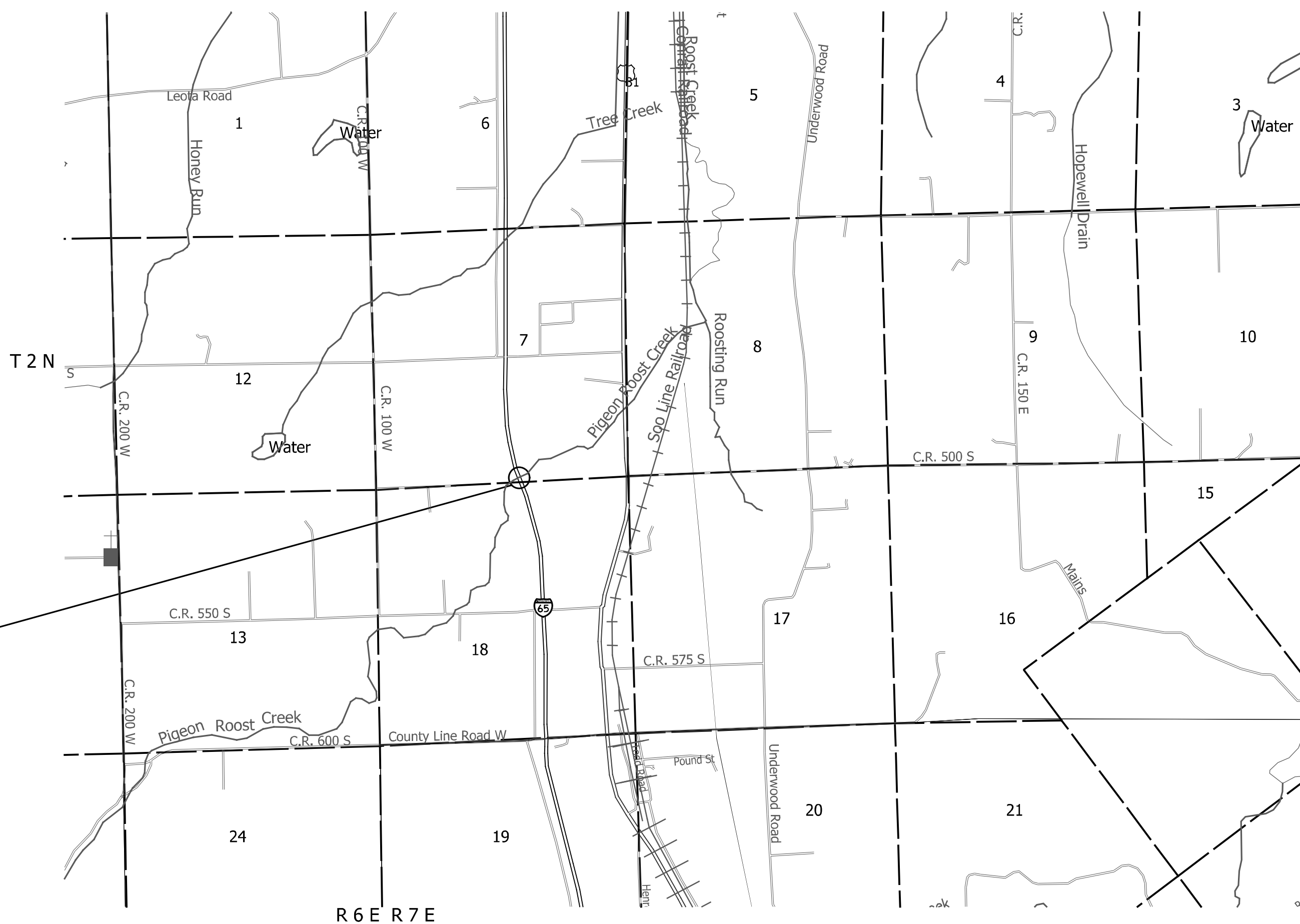

TRAFFIC DATA		I-65	
A.A.D.T.	2023	44,140	V.P.D.
A.A.D.T.	2043	48,810	V.P.D.
D.H.V		3070	V.P.H.
DIRECTIONAL DISTRIBUTION		51.5	%
TRUCKS		23.3	% A.A.D.T.
		26.9	% D.H.V.

DESIGN DATA	
DESIGN SPEED	70 M.P.H.
PROJECT DESIGN CRITERIA	4R (FREEWAY)
FUNCTIONAL CLASSIFICATION	PRINCIPLE ARTERIAL
RURAL/URBAN	RURAL
TERRAIN	LEVEL
ACCESS CONTROL	FULL

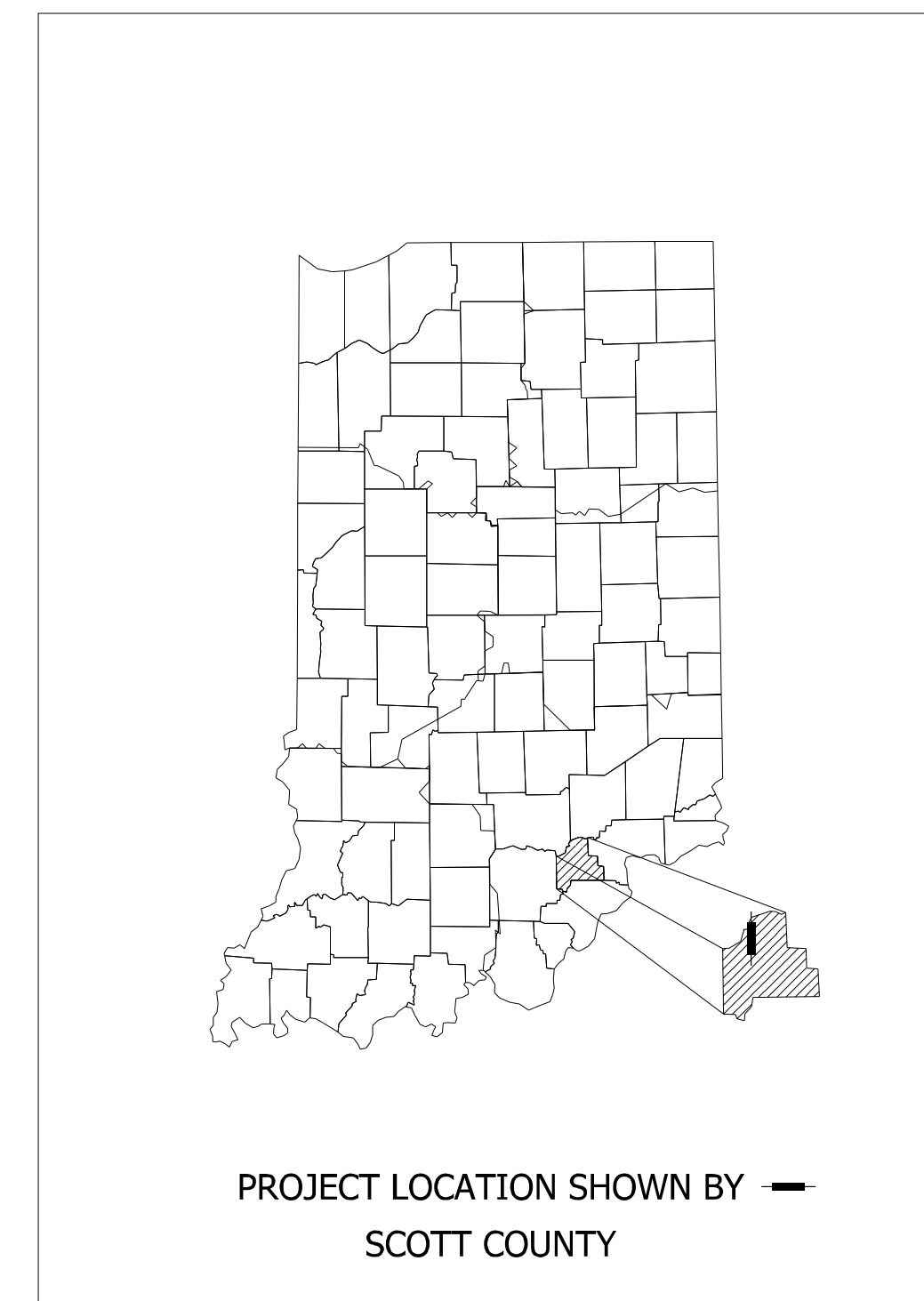

LATITUDE: 38°37'12" N LONGITUDE: 85°46'58" W

BRIDGE LENGTH: 0.019 MI.
 ROADWAY LENGTH: 12.800 MI.
 TOTAL LENGTH: 12.819 MI.
 MAX. GRADE: +0.300 %

HUC: 05120207040090

INDIANA DEPARTMENT OF TRANSPORTATION
STANDARD SPECIFICATIONS DATED 2020
TO BE USED WITH THESE PLANS.

PROJECT	DESIGNATION
1700135	2001604 & 2001605
CONTRACT	BRIDGE FILE
R-41529	165-024-04229 CNBL & CSBL

STRUCTURE	TYPE	SPAN AND SKEW	OVER	STATION
165-024-04229 (CNBL/CSBL)	TWIN CONTINUOUS COMPOSITE PRESTRESSED CONCRETE BOX BEAM BRIDGE	3 Spans: 31'- 9" 32'-0", 31'-9" Skew: NO SKEW	PIGEON ROOST CREEK	887+72.29 "PR-Q"

KIN DESIGNATION NUMBERS	
DESIGNATION	DESCRIPTION
1600729	Bridge Rehabilitation for Structure 165-017-04222 ENBL
1600733	Bridge Rehabilitation for Structure 165-017-04222 ESBL
1600744	Bridge Rehabilitation for Structure 165-016-04220 ENBL
1600750	Bridge Rehabilitation for Structure 165-016-04220 ESBL
1700135 (LEAD)	I65 Roadway Reconstruction
2001600	Bridge Rehabilitation for Structure 165-021-09939 ASBL
2001601	Bridge Rehabilitation for Structure 165-021-09940 ANBL
2001603	Bridge Rehabilitation for Structure 165-023-04227
2001604	Bridge Rehabilitation for Structure 165-024-04229 BNBL
2001605	Bridge Rehabilitation for Structure 165-024-04229 BSBL
2001607	Bridge Rehabilitation for Structure 165-024-04232 A

CULVERT ASSETS		
DES. NO.	CULVERT ASSET ID	WORK TYPE
2001593	CV 165-072-26.20	Small Structure Pipe Lining
2001594	CV 165-072-25.05	Small Structure Pipe Lining
2001595	CV 165-010-22.77	Small Structure Pipe Lining
2001596	CV 165-072-25.83	Small Structure Replacement
2001597	CV 165-010-22.65	Small Structure Paved Invert
2001598	CV 165-010-19.90	Small Structure Paved Invert
2001599	CV 165-010-18.35	Small Structure Pipe Lining

R-41529 - PART 8 OF 15

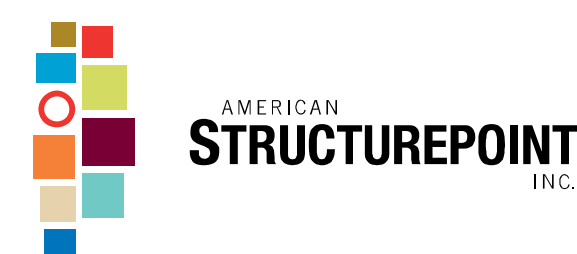

9025 RIVER ROAD, SUITE 200
INDIANAPOLIS, IN 46240
TEL 317.547.5580 FAX 317.543.0270
www.structurepoint.com

FEDERAL HIGHWAY ADMINISTRATION
U.S. DEPT. OF TRANSPORTATION

APPROVED: _____ DATE _____

DIVISION ADMINISTRATOR

PLANS PREPARED BY: American Structurepoint, Inc. (317) 547-5580 PHONE NUMBER

CERTIFIED BY: _____ DATE _____

APPROVED FOR LETTING: _____ DATE _____
INDIANA DEPARTMENT OF TRANSPORTATION

BRIDGE FILE	
165-024-04229 CNBL & CSBL	
DESIGNATION	
2001604 & 2001605	
SHEETS	
SURVEY BOOK	1 of 17
PROJECT	
ELECTRONIC	CONTRACT
R-41529	1700135

Note:
 Sta. 861+43.38 "Q" = Sta. 861+43.38 "PR-Q"
 Sta. 907+43.38 "PR-Q" = Sta. 907+43.38 "Q"

LEGEND

- (K) I-65 (Travel Lanes, Auxiliary Lanes, Gore Areas)
 Full Depth HMA Pavement consisting of
 xxx lbs/sys QC/QA-HMA, x, xx, Surface, x.x mm, on
 xxx lbs/sys QC/QA-HMA, x, xx, Intermediate, xx.x mm, on
 xxx lbs/sys QC/QA-HMA, x, xx, Base, xx.x mm, on
 xxx lbs/sys QC/QA-HMA, x, xx, Intermediate, OG xx.x mm, on
 X" Compacted Aggregate, No. 53, Separation Layer, on
 Geotextile for Pavement, Type XX, on
 Subgrade Treatment, Type XX
- (J) I-65 (Shoulders)
 Full Depth HMA Pavement consisting of
 xxx lbs/sys QC/QA-HMA, x, xx, Surface, x.x mm, on
 xxx lbs/sys QC/QA-HMA, x, xx, Intermediate, xx.x mm, on
 xxx lbs/sys QC/QA-HMA, x, xx, Base, xx.x mm, on
 xxx lbs/sys QC/QA-HMA, x, xx, Intermediate, OG xx.x mm, on
 X" Compacted Aggregate, No. 53, Separation Layer, on
 Geotextile for Pavement, Type XX, on
 Subgrade Treatment, Type XX
- (G) MGS W-Beam Guardrail
- (M) Milling, Asphalt, X.X"
- (O) Compacted Aggregate, No. 53
- (R) xxx lbs/sys QC/QA-HMA, x, xx, Surface, x.x mm
- (U) Underdrain (See Underdrain Details)
- (2) Concrete Median Barrier, 45"
- (4) Milled HMA Corrugations
- (27) Seed Mixture, R

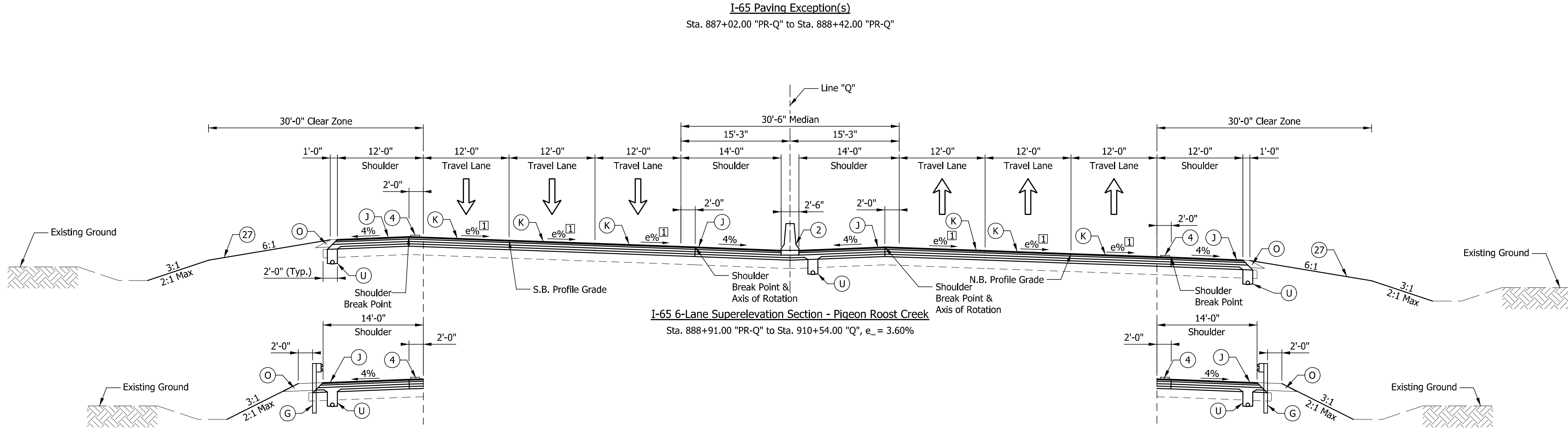
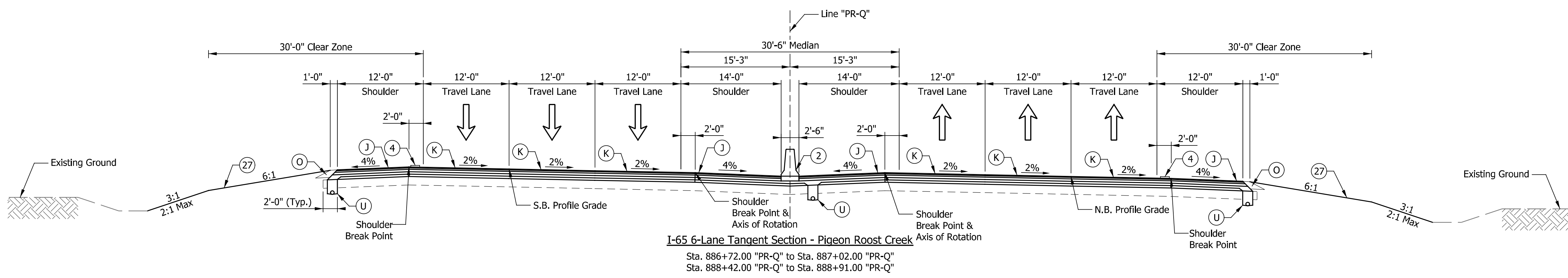
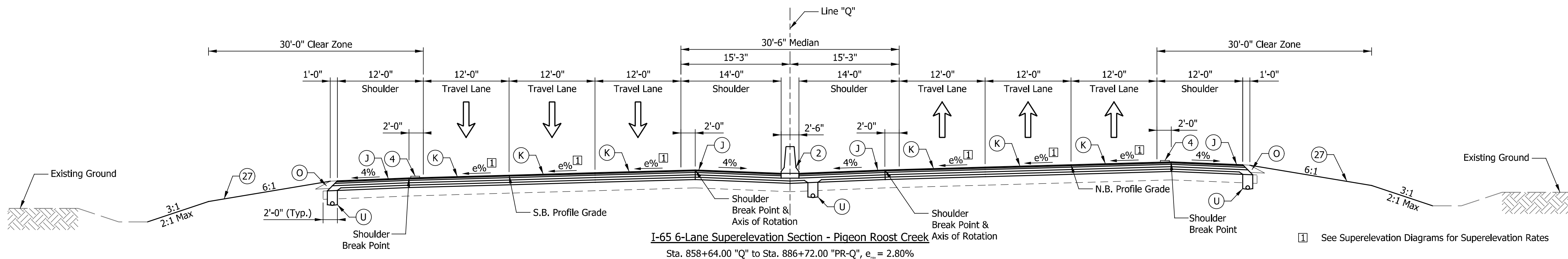

SB I-65 MGS Guardrail Section

NB I-65 MGS Guardrail Section

FOR INFORMATION ONLY

RECOMMENDED FOR APPROVAL	DESIGN ENGINEER	DATE
DESIGNED: ZLM	DRAWN: BAD	
CHECKED: PKW	CHECKED: PKW	

INDIANA
 DEPARTMENT OF TRANSPORTATION

TYPICAL CROSS SECTIONS

HORIZONTAL SCALE	BRIDGE FILE
VERTICAL SCALE	165-024-04229 CNBL & CSBL
	DESIGNATION
	2001604 & 2001605
SURVEY BOOK	SHEETS
ELECTRONIC	3 of 17
CONTRACT	PROJECT
R-41529	1700135

Indiana State Dept. of Transportation
 Indiana State Dept. of Transportation

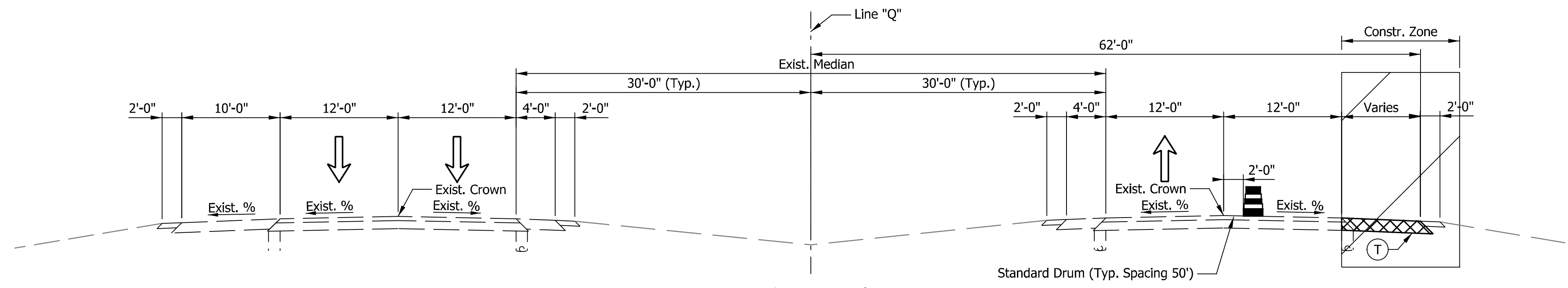

MOT Pre-Phase I Typical Section
 Nightly One-Lane Closures - Outside Shoulder Strengthening
 Sta. 679+00.00 "Q" to Sta. 887+02.00 "PR-Q"
 Paving Exception from Sta. 887+02.00 "PR-Q" to Sta. 888+42.00 "PR-Q"
 Sta. 888+42.00 "PR-Q" to Sta. 1050+00.00 "Q"

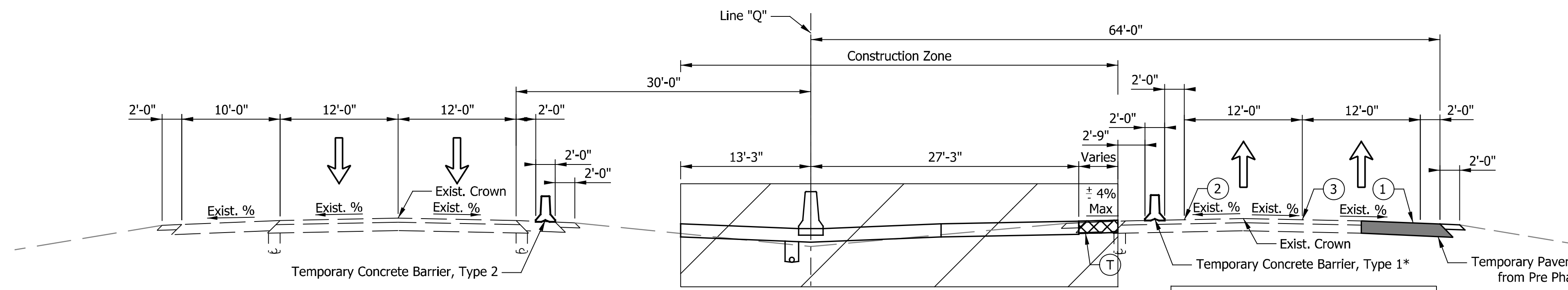

MOT Phase I Typical Section
 Sta. 679+00.00 "Q" to Sta. 1013+98.44 "Q"

*Temporary Barrier Type 1 is proposed instead of Type 2 as it can be utilized for Phase II of Maintenance of Traffic.

Note:
 I-65 Line "PR-Q" starts at P.C. Sta. 861+43.38 and ends at P.T. Sta. 907+43.38, therefore, similar offsets are to be followed for the placement of Temporary Traffic Barrier and Temporary Pavement Markings.

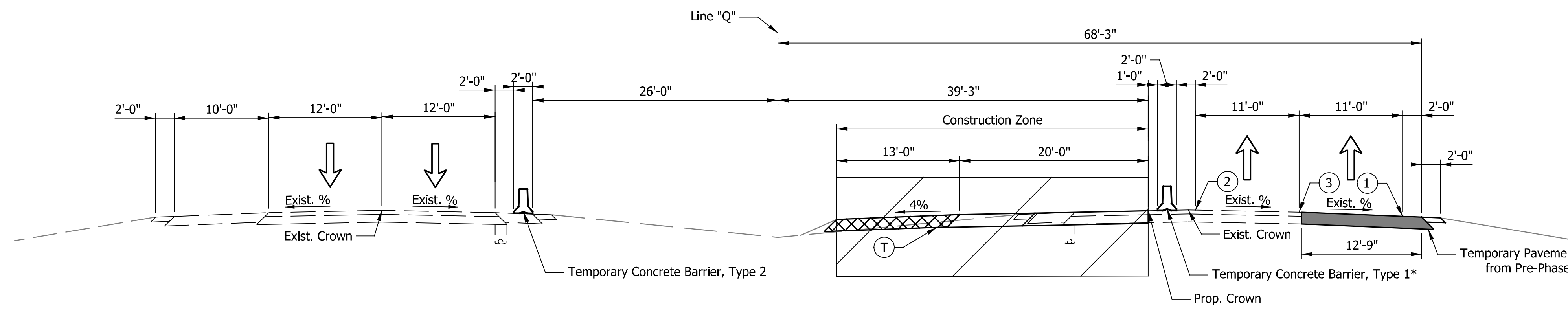

MOT Phase I Typical Section
 Sta. 1013+98.44 "Q" to Sta. 1050+00.00 "Q"

- Notes:
- 1.) Sta. 861+43.38 "Q" = Sta. 861+43.38 "PR-Q"
 - 2.) Sta. 907+31.04 "PR-Q" = Sta. 907+31.04 "Q"
 - 3.) Paving Exceptions from Sta. 887+02.00 "PR-Q" to Sta. 888+42.00 "PR-Q". Typical to all phases.
 - 4.) Interchange ramps for rest stops (approx. RP 22+30) to remain open in Phase I, closed to northbound traffic in Phase II, and closed to southbound traffic in Phase III. See Maintenance of Traffic Plan Details.

- LEGEND**
- ① Temporary Pavement Marking, 4 in., White
 - ② Temporary Pavement Marking, 4 in., Yellow
 - ③ Temporary Pavement Marking, 4 in., Broken White
 - Ⓣ HMA for Temporary Pavement, consisting of:
 xxx lbs/sys QC/QA-HMA, x, xx, Surface, x.x mm, on
 xxx lbs/sys QC/QA-HMA, x, xx, Intermediate, xx.x mm, on
 xxx lbs/sys QC/QA-HMA, x, xx, Base, xx.x mm, on
 xxx lbs/sys QC/QA-HMA, x, xx, Base, xx.x mm, on
 Subgrade Treatment, Type x

DATE	REVISION

FOR INFORMATION ONLY

RECOMMENDED FOR APPROVAL	DESIGN ENGINEER	DATE
DESIGNED: ZLM	DRAWN: BAD	
CHECKED: PKW	CHECKED: PKW	

**INDIANA
 DEPARTMENT OF TRANSPORTATION**

**TYPICAL CROSS SECTIONS
 MAINTENANCE OF TRAFFIC**

HORIZONTAL SCALE	BRIDGE FILE
1/8" = 1'-0"	I65-024-04229 CNBL & CSBL
VERTICAL SCALE	DESIGNATION
1/8" = 1'-0"	2001604 & 2001605
SURVEY BOOK	SHEETS
ELECTRONIC	4 of 17
CONTRACT	PROJECT
R-41529	1700135

I:\chf\chf\chf\Indiana_Sheets.tbl

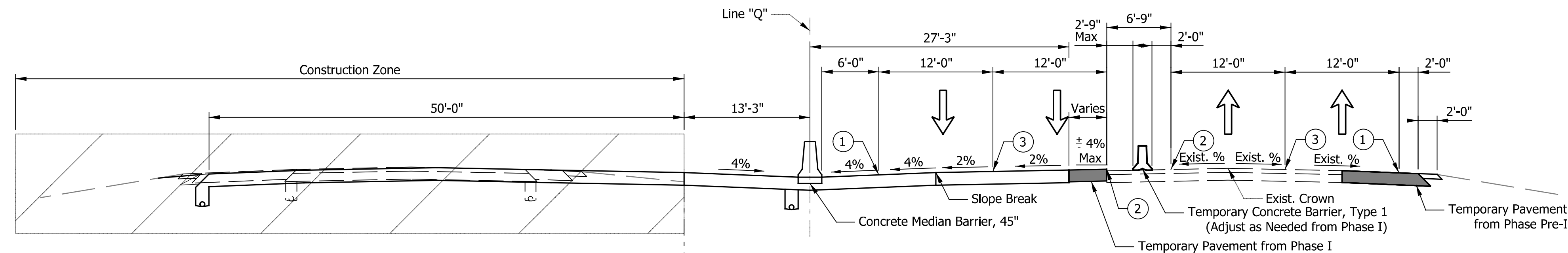

MOT Phase II Typical Section

Sta. 679+00.00 "Q" to Sta. 1013+98.44 "Q"

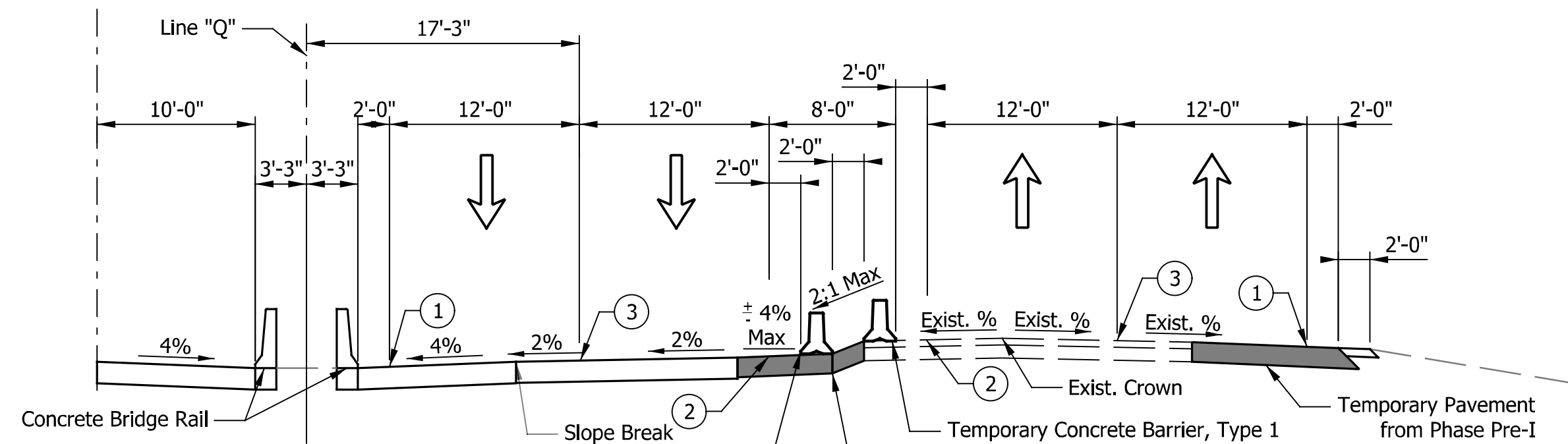

MOT Phase II Typical Section

Sta. 990+75.00 "Q" to Sta. 997+25.00 "Q"

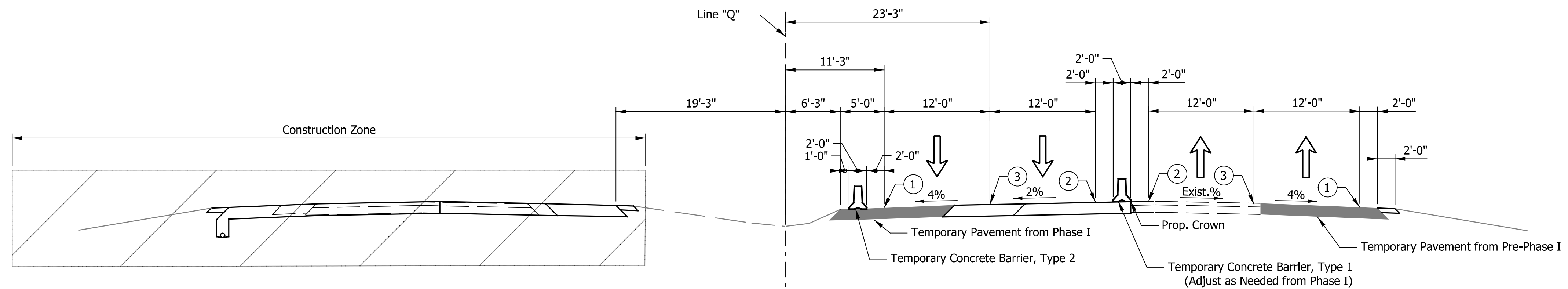

MOT Phase II Typical Section

Sta. 1013+98.44 "Q" to Sta. 1050+00.00 "Q"

LEGEND

- ① Temporary Pavement Marking, 4 in., White
- ② Temporary Pavement Marking, 4 in., Yellow
- ③ Temporary Pavement Marking, 4 in., Broken White
- Ⓣ HMA for Temporary Pavement, consisting of:
 xxx lbs/sys QC/QA-HMA, x, xx, Surface, x.x mm, on
 xxx lbs/sys QC/QA-HMA, x, xx, Intermediate, xx.x mm, on
 xxx lbs/sys QC/QA-HMA, x, xx, Base, xx.x mm, on
 xxx lbs/sys QC/QA-HMA, x, xx, Base, xx.x mm, on
 Subgrade Treatment, Type x

DATE	REVISION

FOR INFORMATION ONLY

RECOMMENDED FOR APPROVAL	DESIGN ENGINEER	DATE
DESIGNED: ZLM	DRAWN: BAD	
CHECKED: PKW	CHECKED: PKW	

INDIANA DEPARTMENT OF TRANSPORTATION

TYPICAL CROSS SECTIONS MAINTENANCE OF TRAFFIC

HORIZONTAL SCALE	BRIDGE FILE
1/8" = 1'-0"	I65-024-04229 CNBL & CSBL
VERTICAL SCALE	DESIGNATION
1/8" = 1'-0"	2001604 & 2001605
SURVEY BOOK	SHEETS
ELECTRONIC	5 of 17
CONTRACT	PROJECT
R-41529	1700135

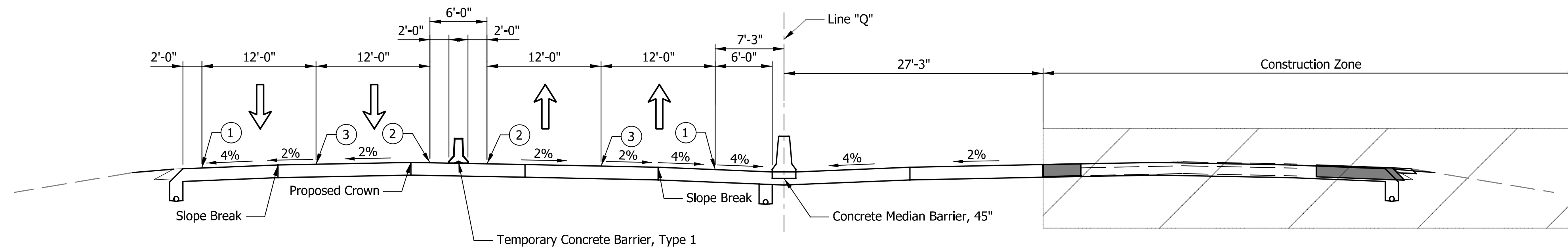

MOT Phase III Typical Section
Sta. 679+00.00 "Q" to Sta. 1013+98.44 "Q"

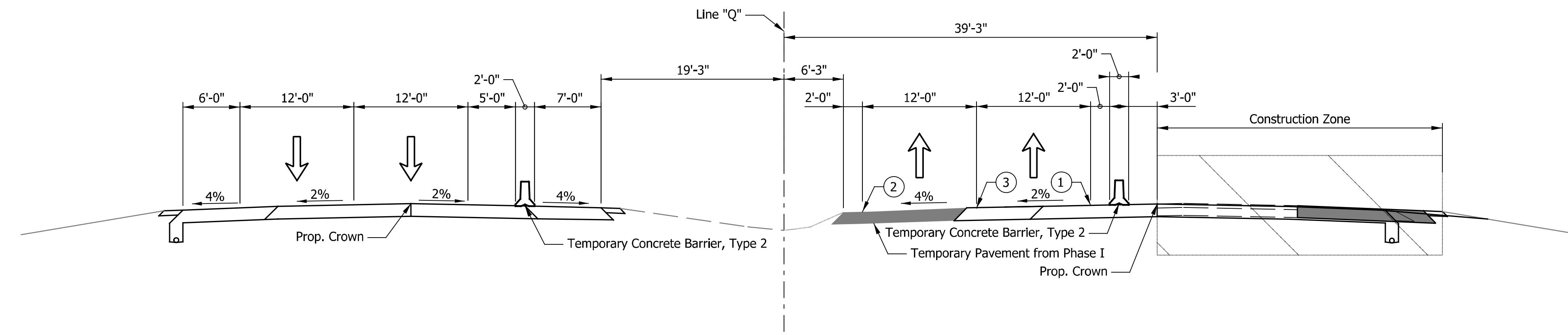

MOT Phase III Typical Section
Sta. 1013+98.44 "Q" to Sta. 1050+00.00 "Q"

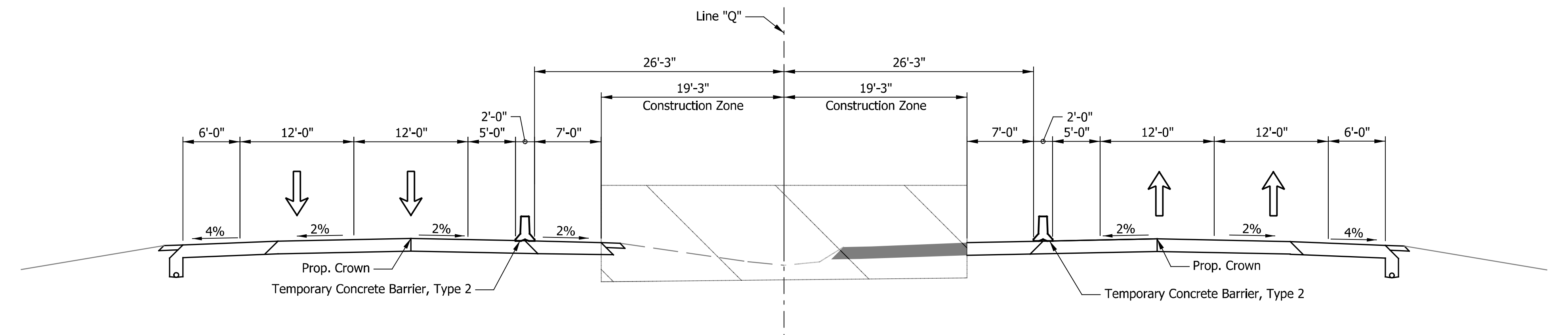

MOT Phase IV Typical Section
Sta. 1013+98.44 "Q" to Sta. 1050+00.00 "Q"

- LEGEND**
- ① Temporary Pavement Marking, 4 in., White
 - ② Temporary Pavement Marking, 4 in., Yellow
 - ③ Temporary Pavement Marking, 4 in., Broken White
 - Ⓣ HMA for Temporary Pavement, consisting of:
xxx lbs/sys QC/QA-HMA, x, xx, Surface, x.x mm, on
xxx lbs/sys QC/QA-HMA, x, xx, Intermediate, xx.x mm, on
xxx lbs/sys QC/QA-HMA, x, xx, Base, xx.x mm, on
xxx lbs/sys QC/QA-HMA, x, xx, Base, xx.x mm, on
Subgrade Treatment, Type x

DATE	REVISION

FOR INFORMATION ONLY

RECOMMENDED FOR APPROVAL	DESIGN ENGINEER	DATE
DESIGNED: ZLM	DRAWN: BAD	
CHECKED: PKW	CHECKED: PKW	

INDIANA
DEPARTMENT OF TRANSPORTATION

TYPICAL CROSS SECTIONS
MAINTENANCE OF TRAFFIC

HORIZONTAL SCALE	BRIDGE FILE
1/8" = 1'-0"	I65-024-04229 CNBL & CSBL
VERTICAL SCALE	DESIGNATION
1/8" = 1'-0"	2001604 & 2001605
SURVEY BOOK	SHEETS
ELECTRONIC	6 of 17
CONTRACT	PROJECT
R-41529	1700135

Note to Reviewer:
 Maintenance of Traffic typical sections are conceptual,
 and have been provided for your reference. Plan view
 and additional sections to be provided at PFC.

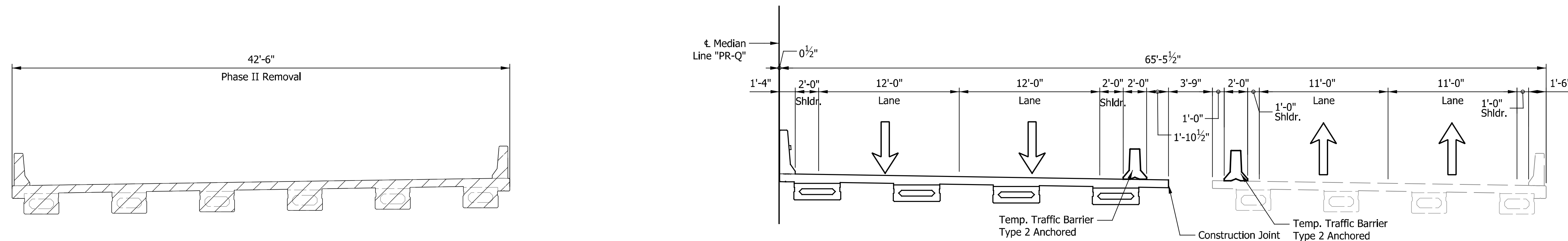
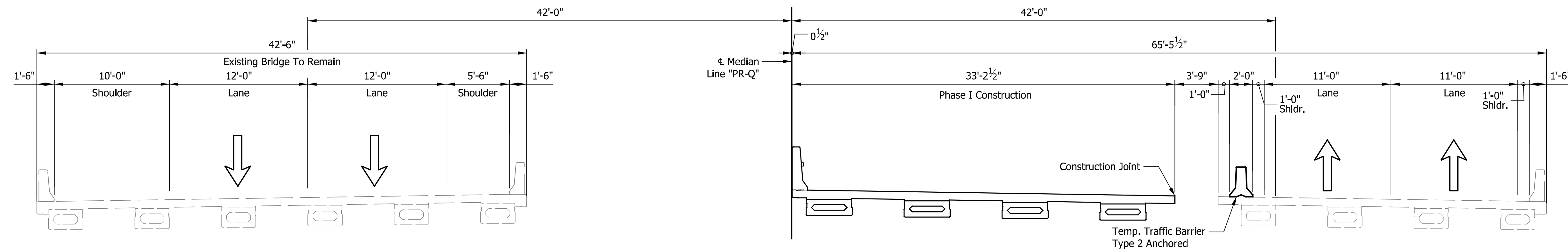
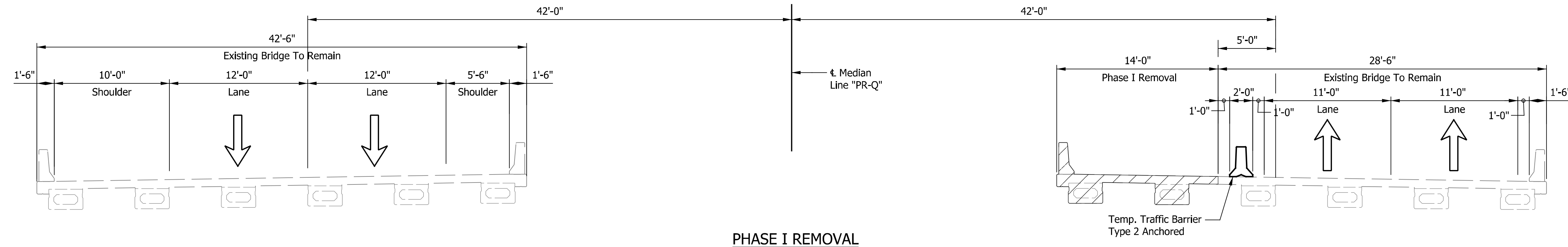

NOTE:
 Hatching Indicates Limits of Removal

RECOMMENDED FOR APPROVAL _____	DESIGN ENGINEER _____	DATE _____
DESIGNED: _____ DJB	DRAWN: _____ KRW	
CHECKED: _____ RTA	CHECKED: _____ RTA	

INDIANA
 DEPARTMENT OF TRANSPORTATION

TRAFFIC MAINTENANCE DETAILS

HORIZONTAL SCALE	BRIDGE FILE
3/16" = 1'-0"	I65-024-04229 CNBL & CSBL
VERTICAL SCALE	DESIGNATION
3/16" = 1'-0"	2001604 & 2001605
SURVEY BOOK	SHEETS
ELECTRONIC	7 of 17
CONTRACT	PROJECT
R-41529	1700135

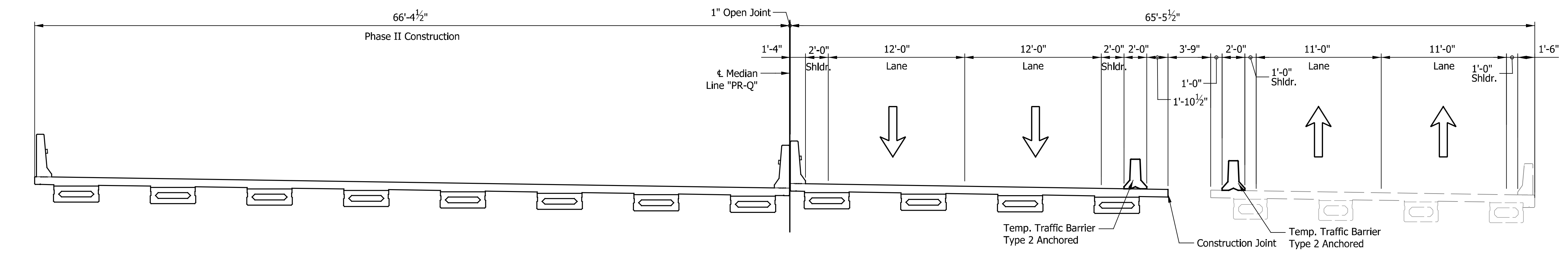

PHASE II CONSTRUCTION

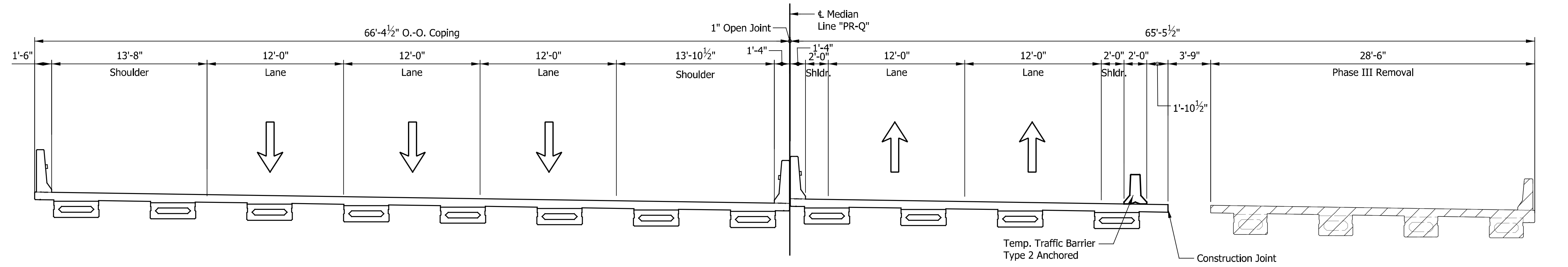

PHASE III REMOVAL

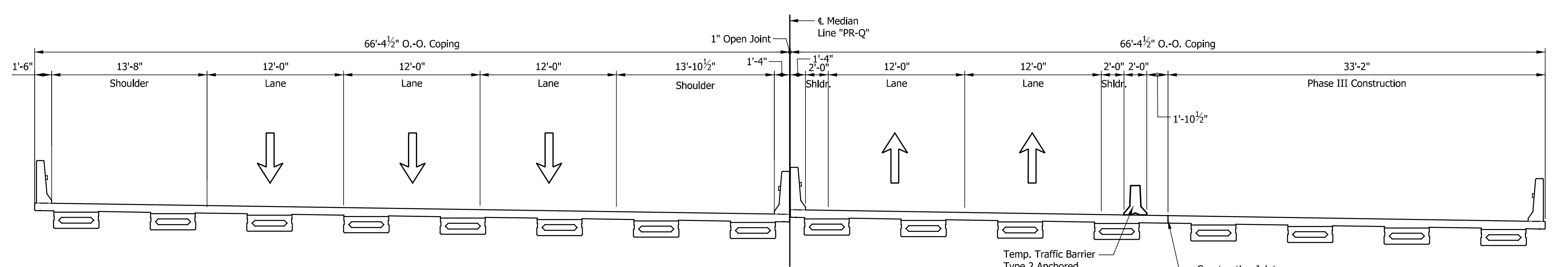

PHASE III CONSTRUCTION

Note to Reviewer:
Maintenance of Traffic typical sections are conceptual,
and have been provided for your reference. Plan view
and additional sections to be provided at PFC.

NOTE:
Hatching Indicates Limits of Removal

RECOMMENDED FOR APPROVAL _____	DESIGN ENGINEER _____	DATE _____
DESIGNED: _____ DJB	DRAWN: _____ KRW	
CHECKED: _____ RTA	CHECKED: _____ RTA	

INDIANA
DEPARTMENT OF TRANSPORTATION

TRAFFIC MAINTENANCE DETAILS

HORIZONTAL SCALE	BRIDGE FILE	
3/16" = 1'-0"	I65-024-04229 CNBL & CSBL	
VERTICAL SCALE	DESIGNATION	
3/16" = 1'-0"	2001604 & 2001605	
SURVEY BOOK	SHEETS	
ELECTRONIC	8	of 17
CONTRACT	PROJECT	
R-41529	1700135	

I:\chad\pfc\indiana\shades.tbl

885
SEC. 18, T 2 N, R 7 E
VIENNA TOWNSHIP
SCOTT COUNTY

890
SEC. 7, T 2 N, R 7 E
VIENNA TOWNSHIP
SCOTT COUNTY

895
KENNETH WAYNE HAVEN

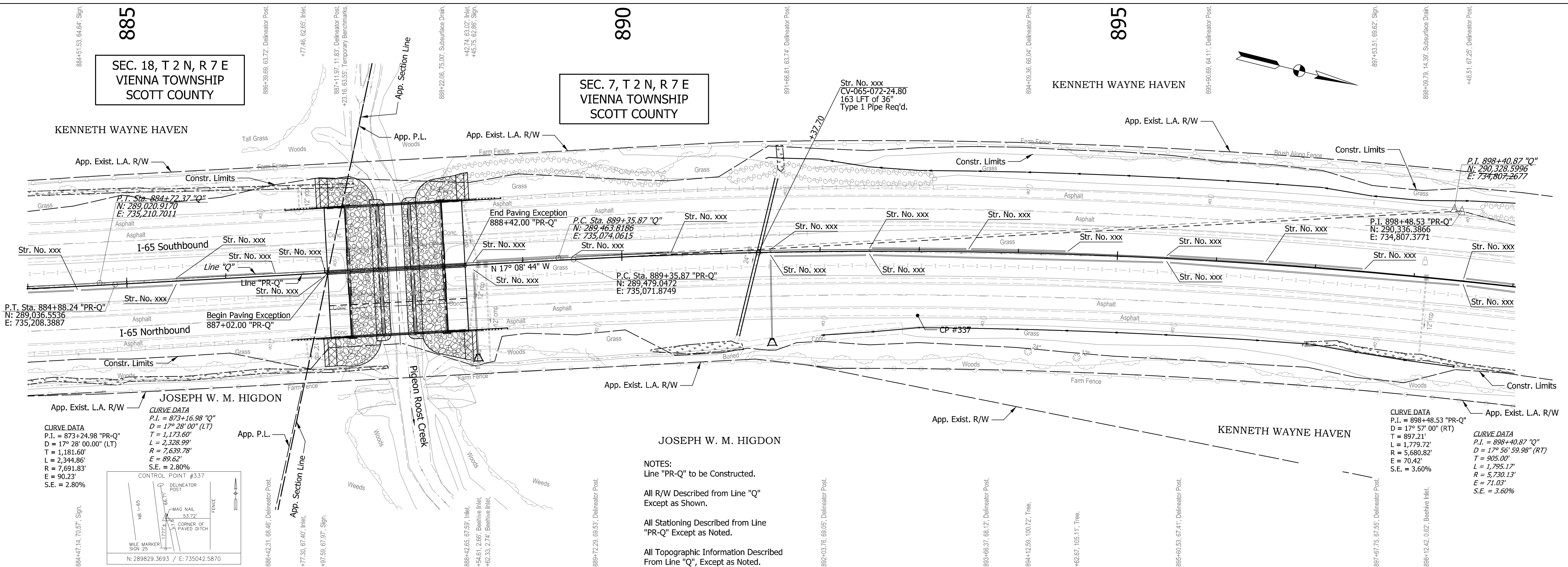

CURVE DATA
 P.I. = 873+24.98 "PR-Q"
 D = 17° 28' 00.00" (LT)
 T = 1,181.60'
 L = 2,344.86'
 R = 7,691.83'
 E = 90.23'
 S.E. = 2.80%

CURVE DATA
 P.I. = 873+16.98 "Q"
 D = 17° 28' 00" (LT)
 T = 1,173.60'
 L = 2,328.99'
 R = 7,639.78'
 E = 89.62'
 S.E. = 2.80%

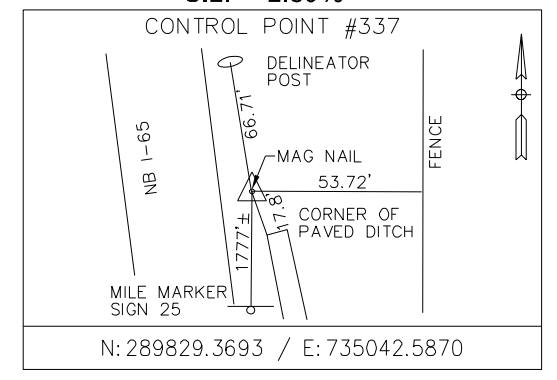

CURVE DATA
 P.I. = 898+48.53 "PR-Q"
 D = 17° 57' 00" (RT)
 T = 897.21'
 L = 1,779.72'
 R = 5,680.82'
 E = 70.42'
 S.E. = 3.60%

CURVE DATA
 P.I. = 898+40.87 "Q"
 D = 17° 56' 59.98" (RT)
 T = 905.00'
 L = 1,795.17'
 R = 5,730.13'
 E = 71.03'
 S.E. = 3.60%

NOTES:
 Line "PR-Q" to be Constructed.

All R/W Described from Line "Q" Except as Shown.

All Stationing Described from Line "PR-Q" Except as Noted.

All Topographic Information Described From Line "Q", Except as Noted.

TBM #18 - BRASS INDOT DISK MARKED "S-45", IN SW CORNER OF BRIDGE ABUTMENT OF THE SOUTH BOUND BRIDGE OVER PIGEON ROOST CREEK. ELEV: 590.08'

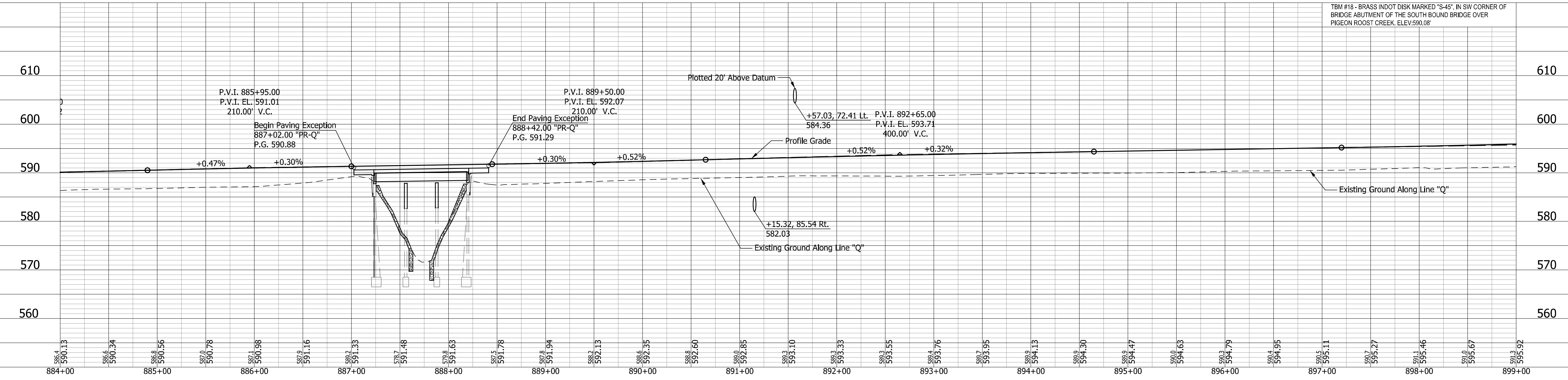

DATE	REVISION

FOR INFORMATION ONLY

RECOMMENDED FOR APPROVAL	DESIGN ENGINEER	DATE
DESIGNED: ZLM	DRAWN: BAD	
CHECKED: PKW	CHECKED: PKW	

INDIANA
 DEPARTMENT OF TRANSPORTATION
 PLAN AND PROFILE
 STA. 884+00.00 TO STA. 899+00.00

HORIZONTAL SCALE	BRIDGE FILE
1" = 50'-0"	I65-024-04229 CNBL & CSBL
VERTICAL SCALE	DESIGNATION
1" = 10'-0"	2001604 & 2001605
SURVEY BOOK	SHEETS
ELECTRONIC	9 of 17
CONTRACT	PROJECT
R-41529	1700135

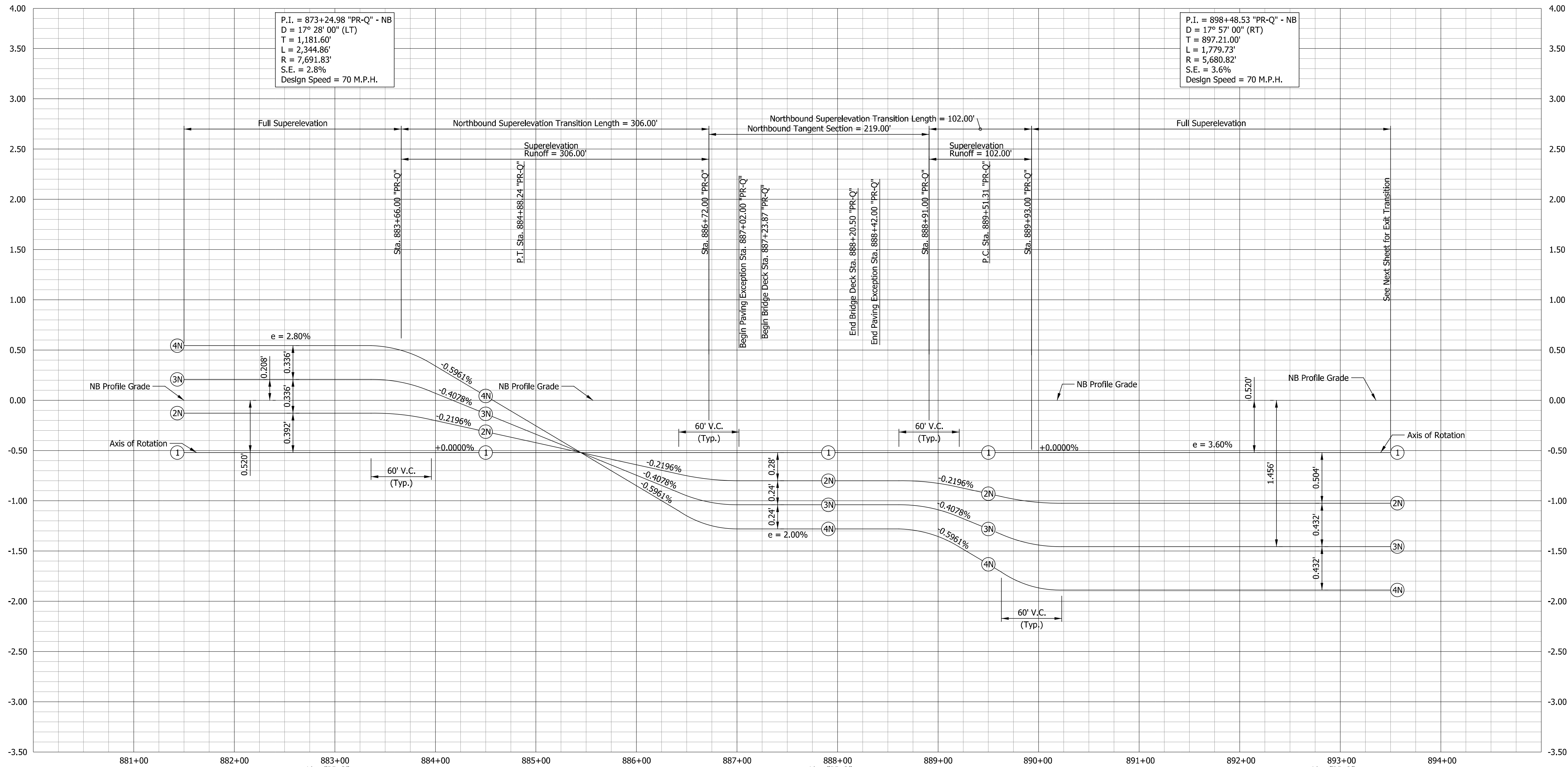

P.I. = 873+24.98 "PR-Q" - NB
 D = 17° 28' 00" (LT)
 T = 1,181.60'
 L = 2,344.86'
 R = 7,691.83'
 S.E. = 2.8%
 Design Speed = 70 M.P.H.

P.I. = 898+48.53 "PR-Q" - NB
 D = 17° 57' 00" (RT)
 T = 897.21.00'
 L = 1,779.73'
 R = 5,680.82'
 S.E. = 3.6%
 Design Speed = 70 M.P.H.

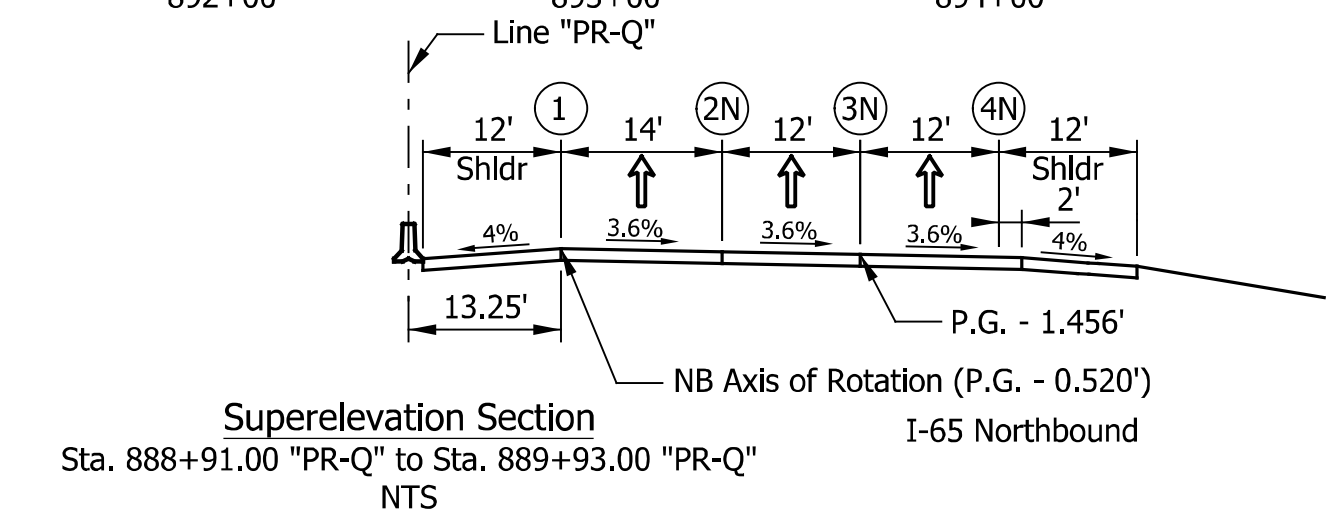
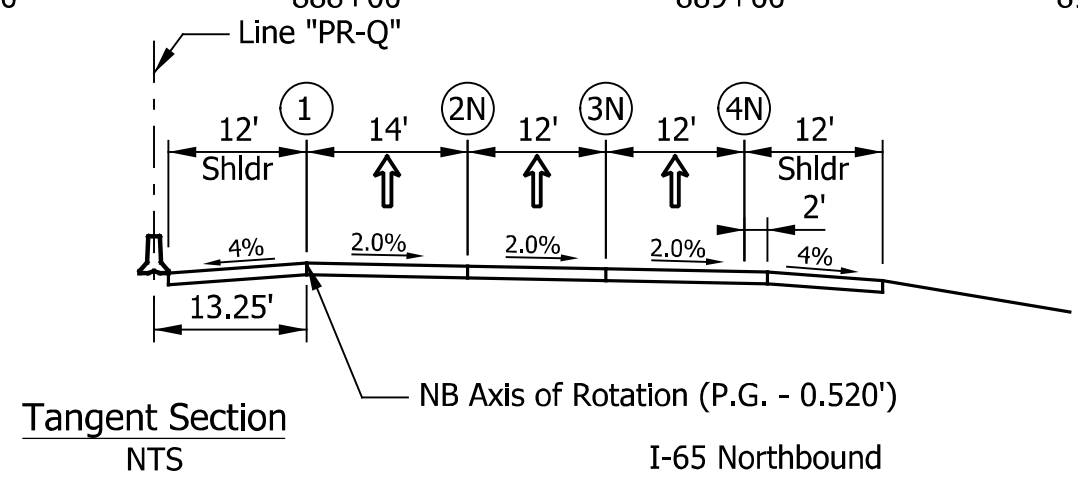
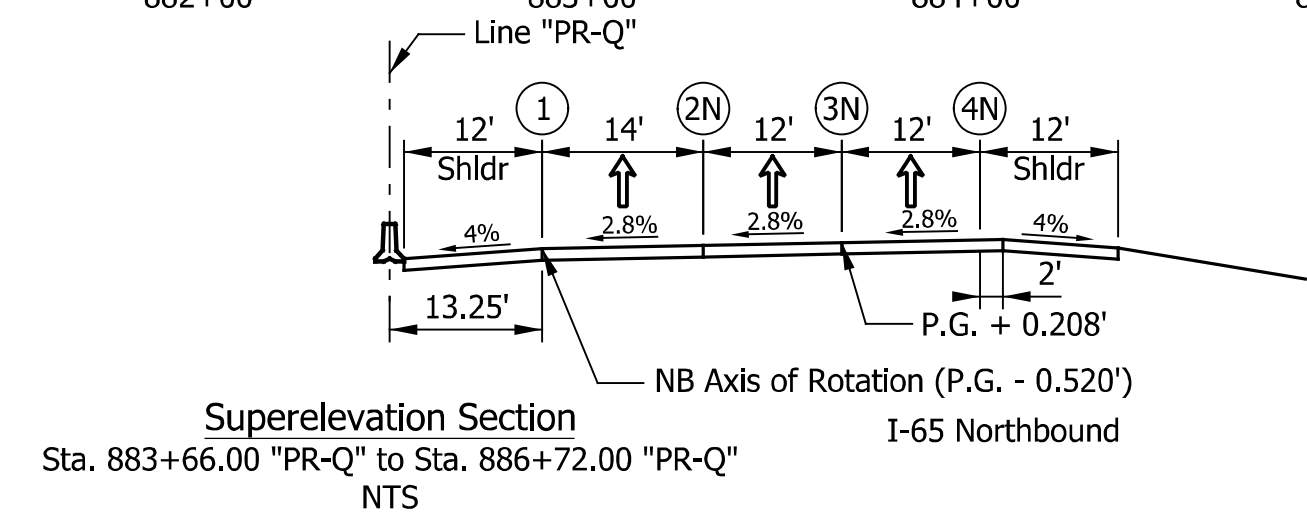

DATE	REVISION

FOR INFORMATION ONLY

RECOMMENDED FOR APPROVAL	DESIGN ENGINEER	DATE
DESIGNED: ZLM	DRAWN: ZLM	
CHECKED: CDH	CHECKED: PKW	

INDIANA
 DEPARTMENT OF TRANSPORTATION
 SUPERELEVATION TRANSITION DIAGRAM
 LINE "PR-Q"

HORIZONTAL SCALE	BRIDGE FILE
1" = 50'	I65-024-04229 CNBL & CSBL
VERTICAL SCALE	DESIGNATION
1" = 0.5'	2001604 & 2001605
SURVEY BOOK	SHEETS
ELECTRONIC	10 of 17
CONTRACT	PROJECT
R-41529	1700135

I:\indiana\2021\I65\024\04229\Drawings\201900172\0610.BR.SE.01.dgn

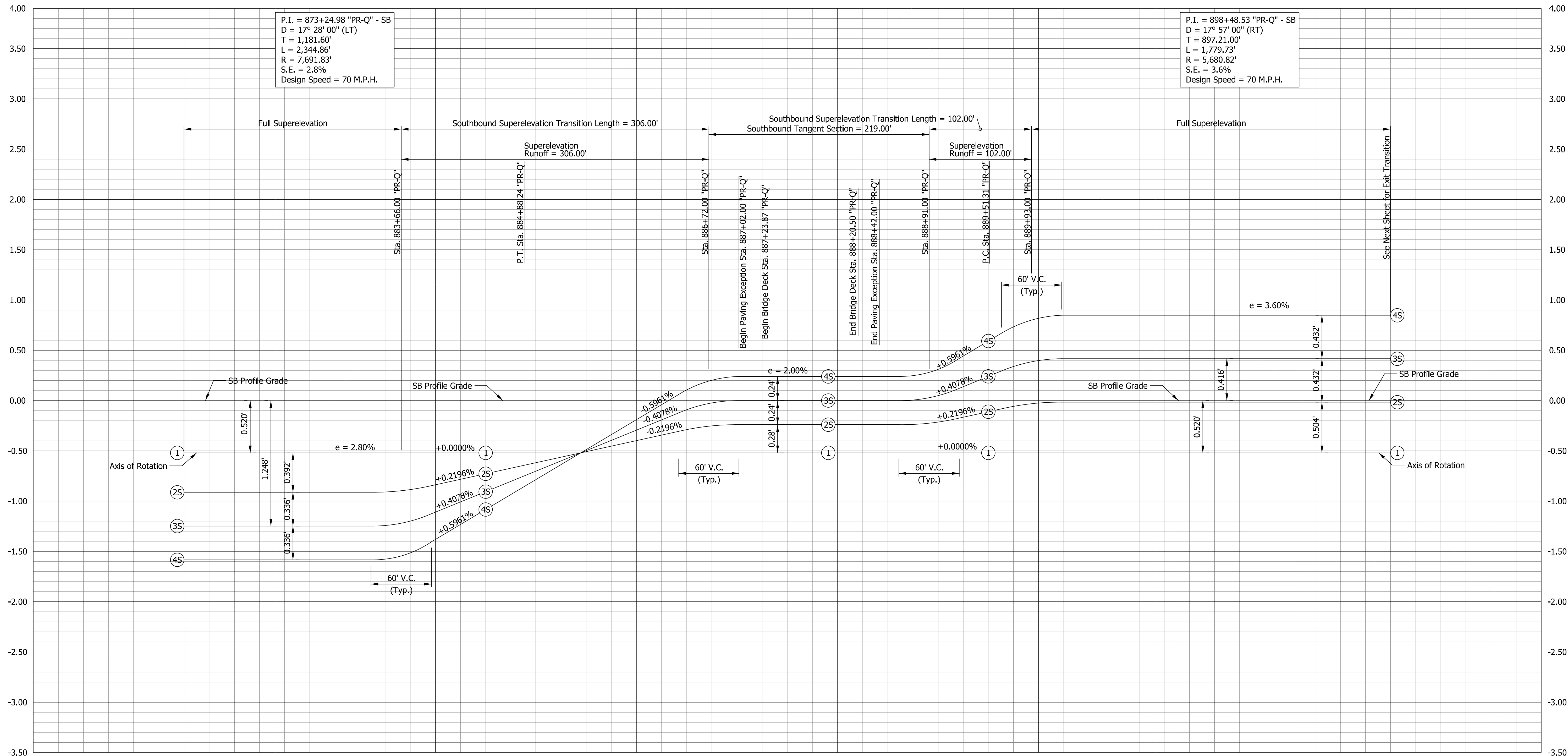

P.I. = 873+24.98 "PR-Q" - SB
 D = 17° 28' 00" (LT)
 T = 1,181.60'
 L = 2,344.86'
 R = 7,691.83'
 S.E. = 2.8%
 Design Speed = 70 M.P.H.

P.I. = 898+48.53 "PR-Q" - SB
 D = 17° 57' 00" (RT)
 T = 897.21.00'
 L = 1,779.73'
 R = 5,680.82'
 S.E. = 3.6%
 Design Speed = 70 M.P.H.

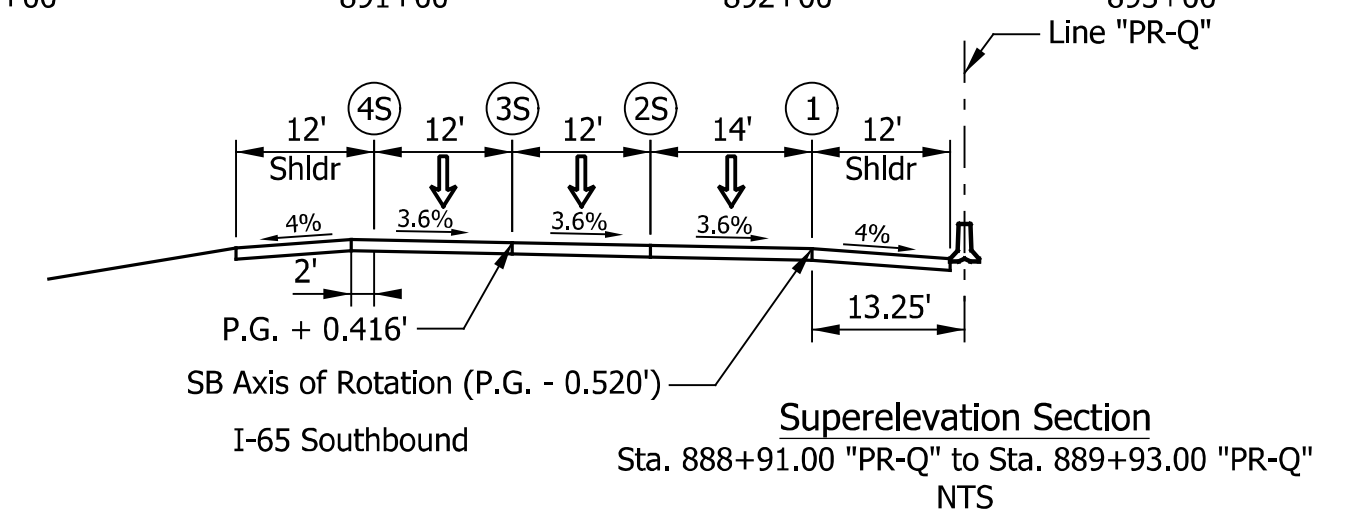
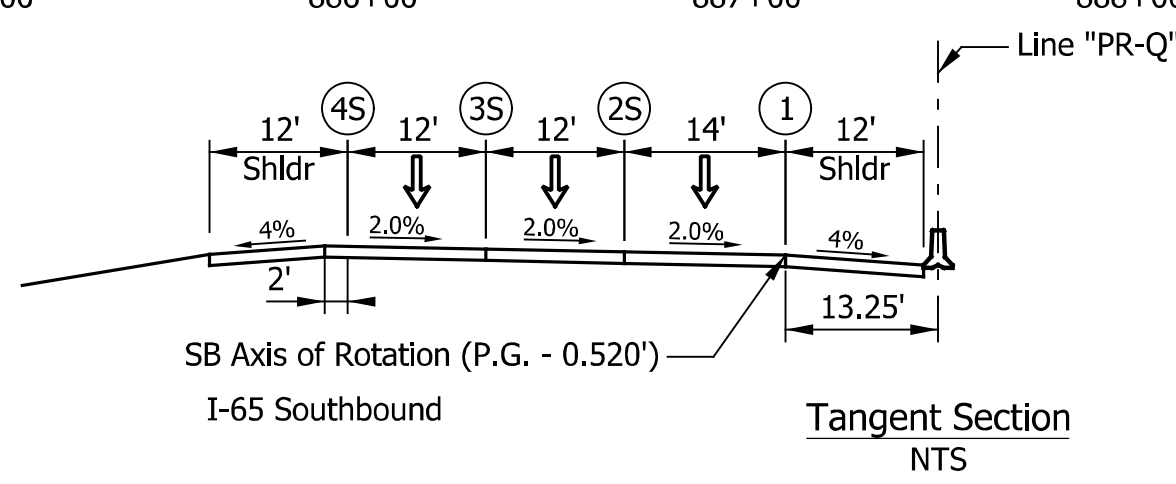
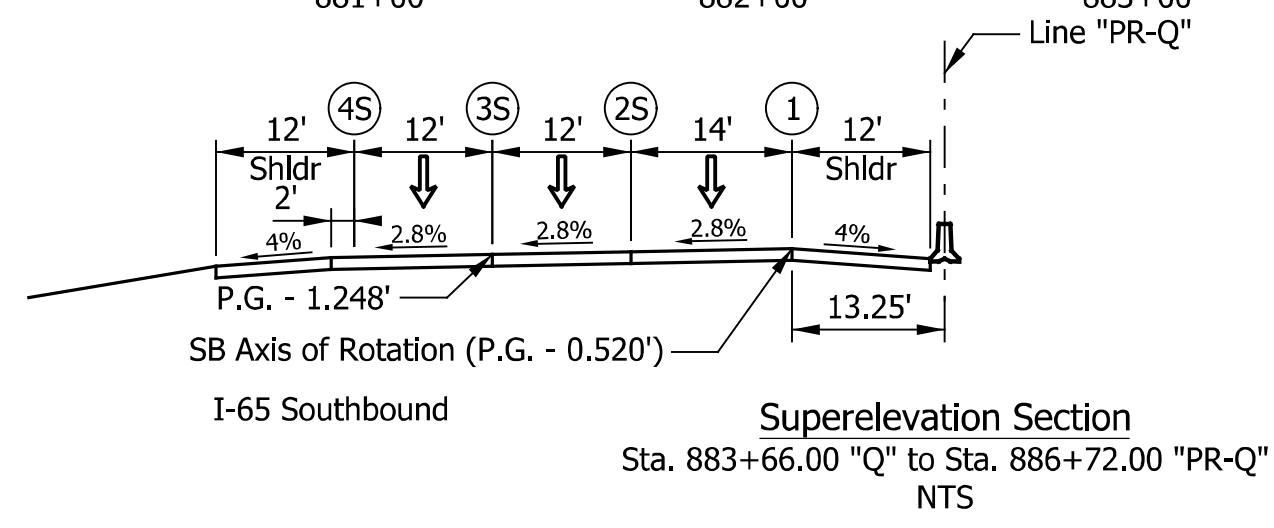

DATE	REVISION

FOR INFORMATION ONLY

RECOMMENDED FOR APPROVAL	DESIGN ENGINEER	DATE
DESIGNED: ZLM	DRAWN: ZLM	
CHECKED: CDH	CHECKED: PKW	

INDIANA
 DEPARTMENT OF TRANSPORTATION
 SUPERELEVATION TRANSITION DIAGRAM
 LINE "PR-Q"

HORIZONTAL SCALE	BRIDGE FILE
1" = 50'	I65-024-04229 CNBL & CSBL
VERTICAL SCALE	DESIGNATION
1" = 0.5'	2001604 & 2001605
SURVEY BOOK	SHEETS
ELECTRONIC	11 of 17
CONTRACT	PROJECT
R-41529	1700135

I:\indiana\etc\etc\indiana\shades\bl

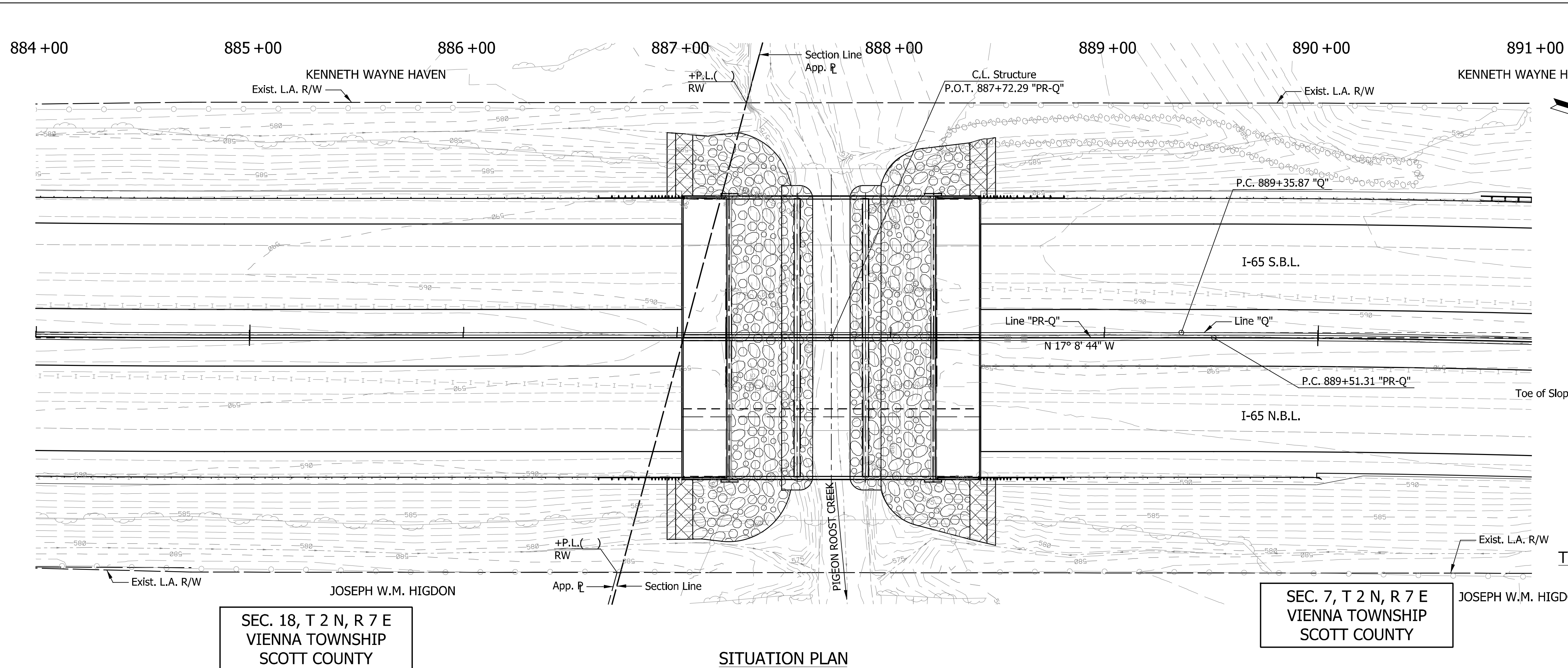

SEC. 18, T 2 N, R 7 E
VIENNA TOWNSHIP
SCOTT COUNTY

SEC. 7, T 2 N, R 7 E
VIENNA TOWNSHIP
SCOTT COUNTY

SITUATION PLAN
Scale: 1" = 30'-0", Contour Interval 1'-0"

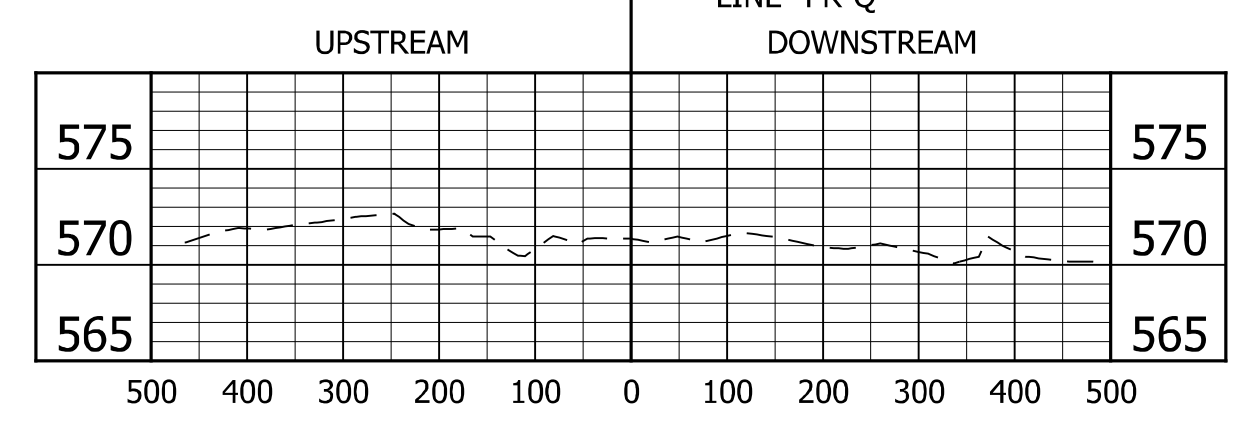
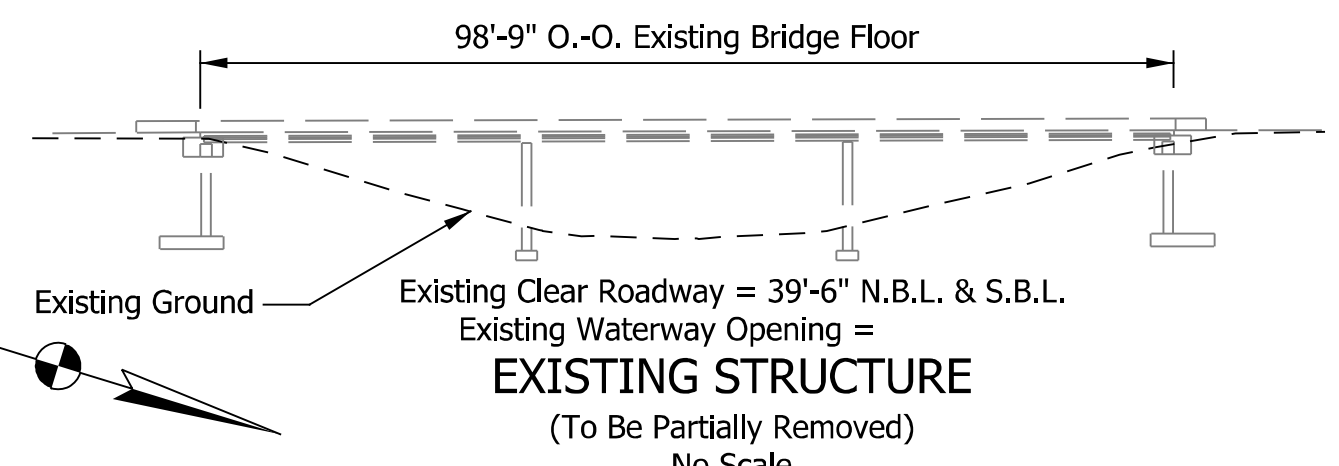

EXISTING STREAM PROFILE
Scales: 1" = 200'-0" Horizontal, 1" = 10'-0" Vertical

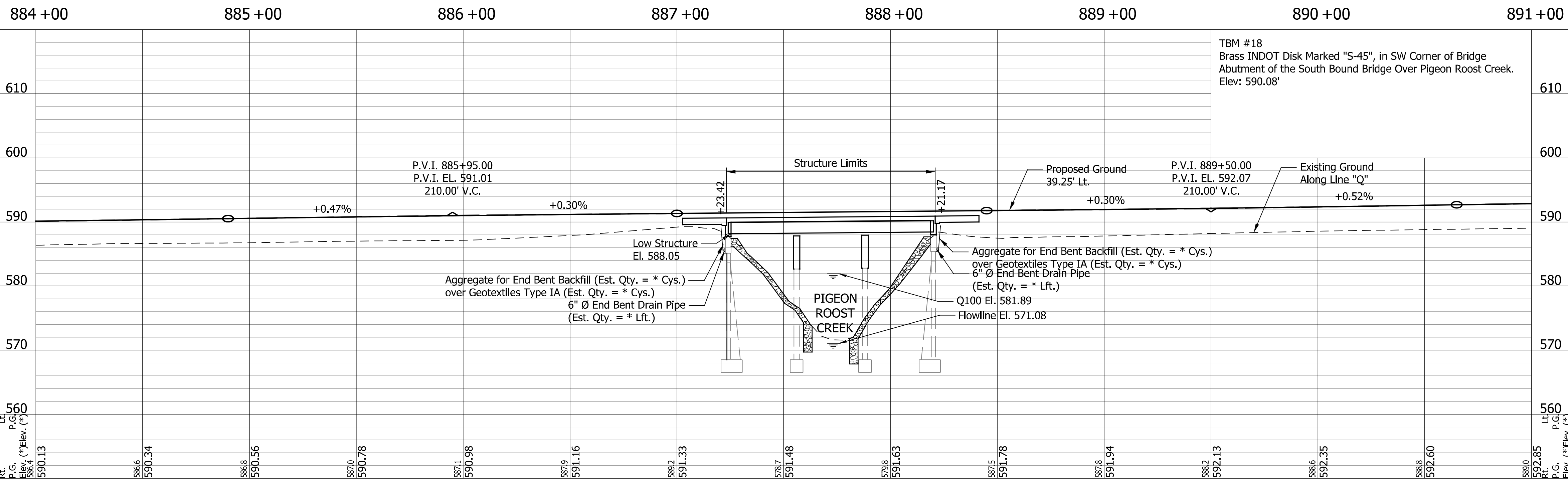
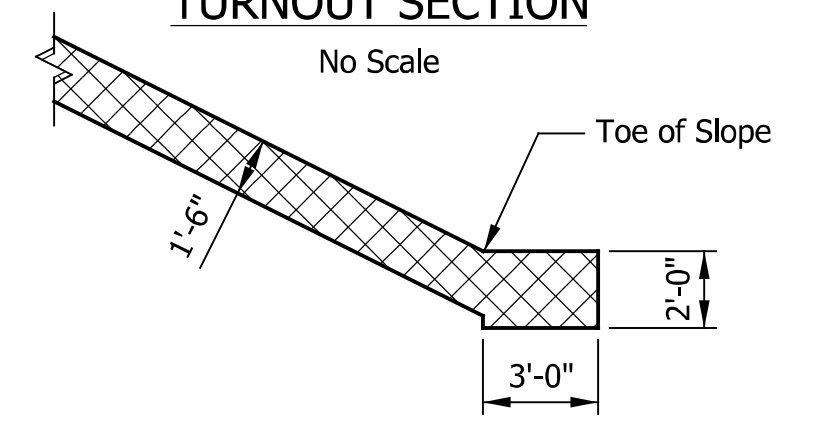
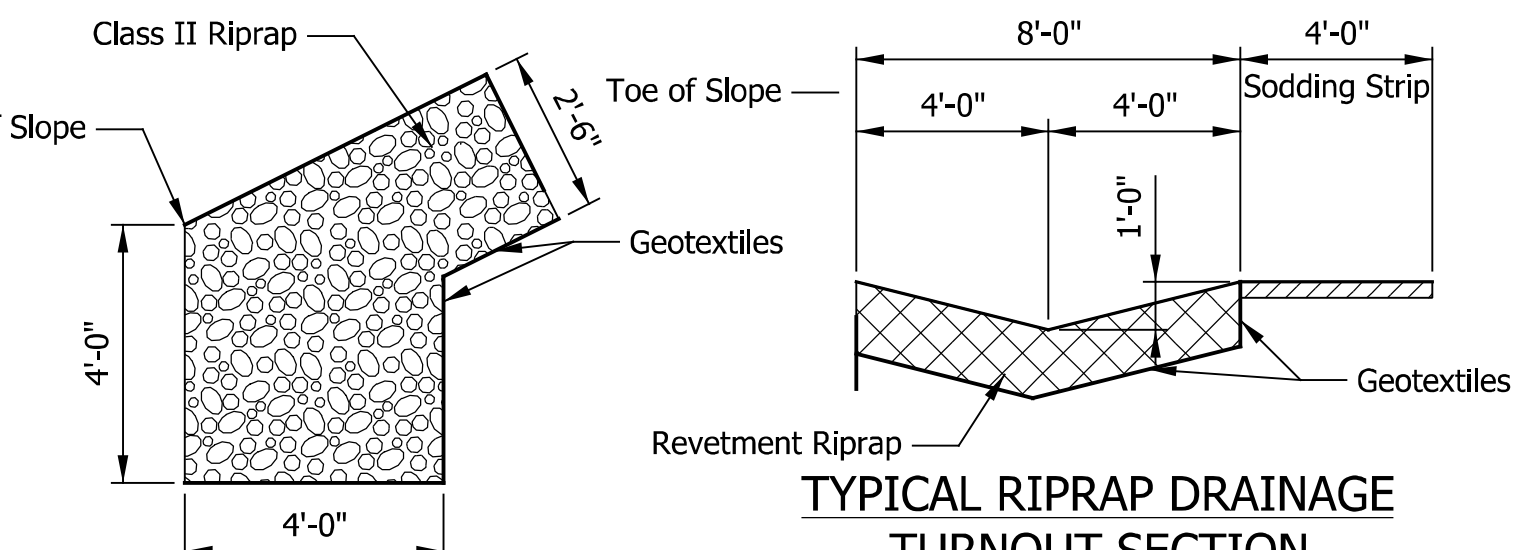

PROFILE ON PROPOSED C ROADWAY
Scales: 1" = 30'-0" Horizontal, 1" = 10'-0" Vertical

HYDRAULIC & SCOUR DATA

Drainage Area	= 8.95	Sq. Mi.
Discharge (Q100)	= 4000	Cfs.
Q100 Elevation	= 581.89	Ft.
Freeboard Provided (Above El. 581.89)	= 6.16	Ft.
Scour Velocity @ Q100	= 12.77	Ft./Sec.
Contraction Scour Depth	= 4.83	Ft.
Total Scour Depth	= 10.83	Ft.
Low Scour Elevation	= 560.25	Ft.

NOTES:

All R/W on this sheet is described from Line "Q".

Cross-Hatched areas indicate limits of 18" Revetment Riprap over Geotextiles. (Est. Qty. = * Tons of Revetment Riprap over * Sys. of Geotextiles)

Hatched areas indicate limits of 4' wide sodding strip. (Est. Qty. = * Sys.)

Indicates limits of Class II Riprap over Geotextiles. (Est. Qty. = * Tons of Class II Riprap over * Sys. of Geotextiles)

For Guardrail limits and side ditch grades, see Road Plan and Profile Sheet.

For Profile, additional alignment references, benchmarks, and topo references, see Road Plans.

TWIN CONTINUOUS COMPOSITE PRESTRESSED CONCRETE BOX BEAM BRIDGE
3 SPAN: 31'-9", 32'-0", 31'-9" SKEW: SQUARE CLEAR ROADWAY: 63'-6 1/2"
I-65 N.B.L. & S.B.L. OVER PIGEON ROOST CREEK
SCOTT COUNTY

RECOMMENDED FOR APPROVAL	DESIGN ENGINEER		DATE	INDIANA DEPARTMENT OF TRANSPORTATION	HORIZONTAL SCALE	BRIDGE FILE
	DESIGNED: DJB		DRAWN: KRW		AS NOTED	I65-024-04229 CNBL & CSBL
CHECKED: RTA	CHECKED: RTA			LAYOUT	VERTICAL SCALE	DESIGNATION
					AS NOTED	2001604 & 2001605
					SURVEY BOOK	SHEETS
					ELECTRONIC	12 of 17
					CONTRACT	PROJECT
					R-41529	1700135

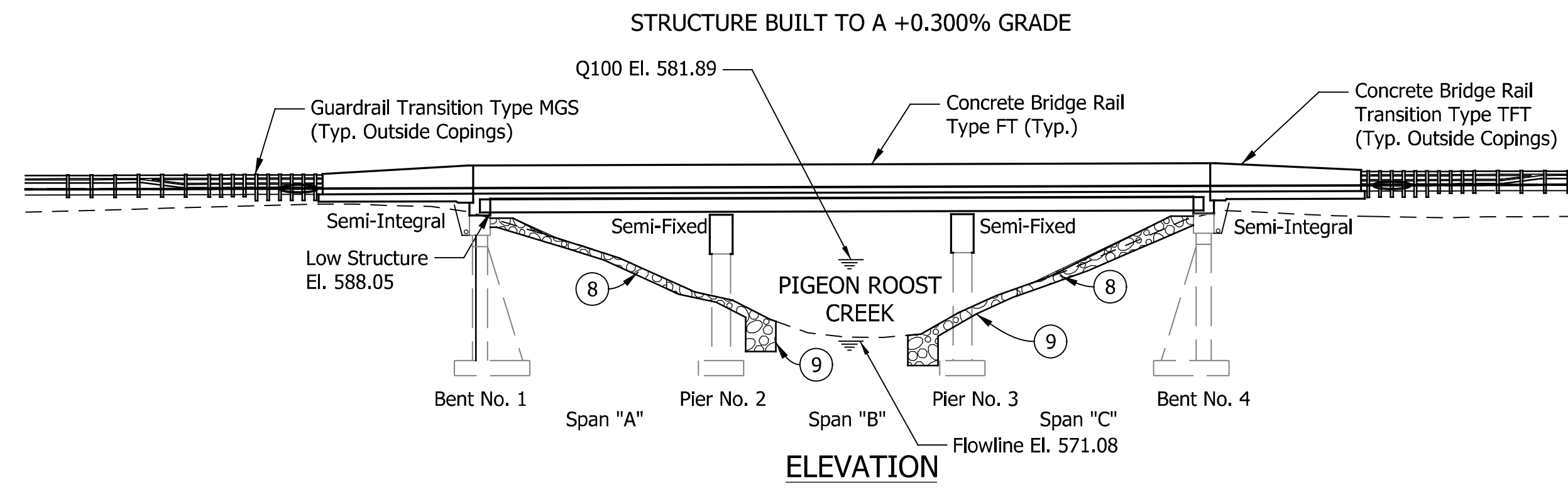

GENERAL NOTES

- Reinforcing steel covering to be 2½" in the top and 1" minimum in the bottom of floor slabs, 3" in the footings except the bottom steel which shall be 4", and 2" in all other parts, unless noted.
- DESIGN DATA**
- LIVE LOAD:** Beams & Deck designed for HL-93 loading in accordance with the AASHTO LRFD Bridge Design Specifications, Ninth Edition. Substructure checked for HS20-44 & military loading with impact and distribution of loads in accordance with AASHTO Standard Specifications for Highway Bridges, Seventeenth Edition, 2002.
- DEAD LOAD:** Actual Weight plus 35 Lbs./Sft. for future wearing surface and 15 Lbs./Sft. for permanent metal deck forms.
- FLOOR SLAB:** Designed for 16,000 Lbs. wheel load impact with a structural depth of 7½".
- UNIT STRESSES:** Reinforcing Steel, Fy = 60,000 psi
Concrete Class B, f'c = 3,000 psi
Concrete Class A, f'c = 3,500 psi
Concrete Class C, f'c = 4,000 psi

LEGEND

- 1 Remove The Existing Deck, Exist. Concrete Box Beams, and Bridge Railing. Install New Concrete Box Beams, Construct New Bridge Deck, and Concrete Bridge Rail Type FT.
- 2 Remove Existing Wingwalls And Mudwalls Down To The Cap. Convert End Bent To Semi-Integral, Widen As Needed, And Construct New Wing Walls.
- 3 Widen Interior Piers For New Beam Lines.
- 4 Remove Existing Bridge Approaches and Construct New Full Width R.C. Bridge Approach.
- 5 Surface Seal Exposed Surfaces of Superstructure.
- 6 Remove Existing Bridge Rail Transitions and Guardrail Transitions. Construct New Concrete Bridge Rail Transitions, Type TFT. Install New MGS Guardrail Transitions.
- 7 Construct New Turnout and Sodding Strip.
- 8 Construct New Spill Slope.
- 9 Place Class II Riprap around Piers.

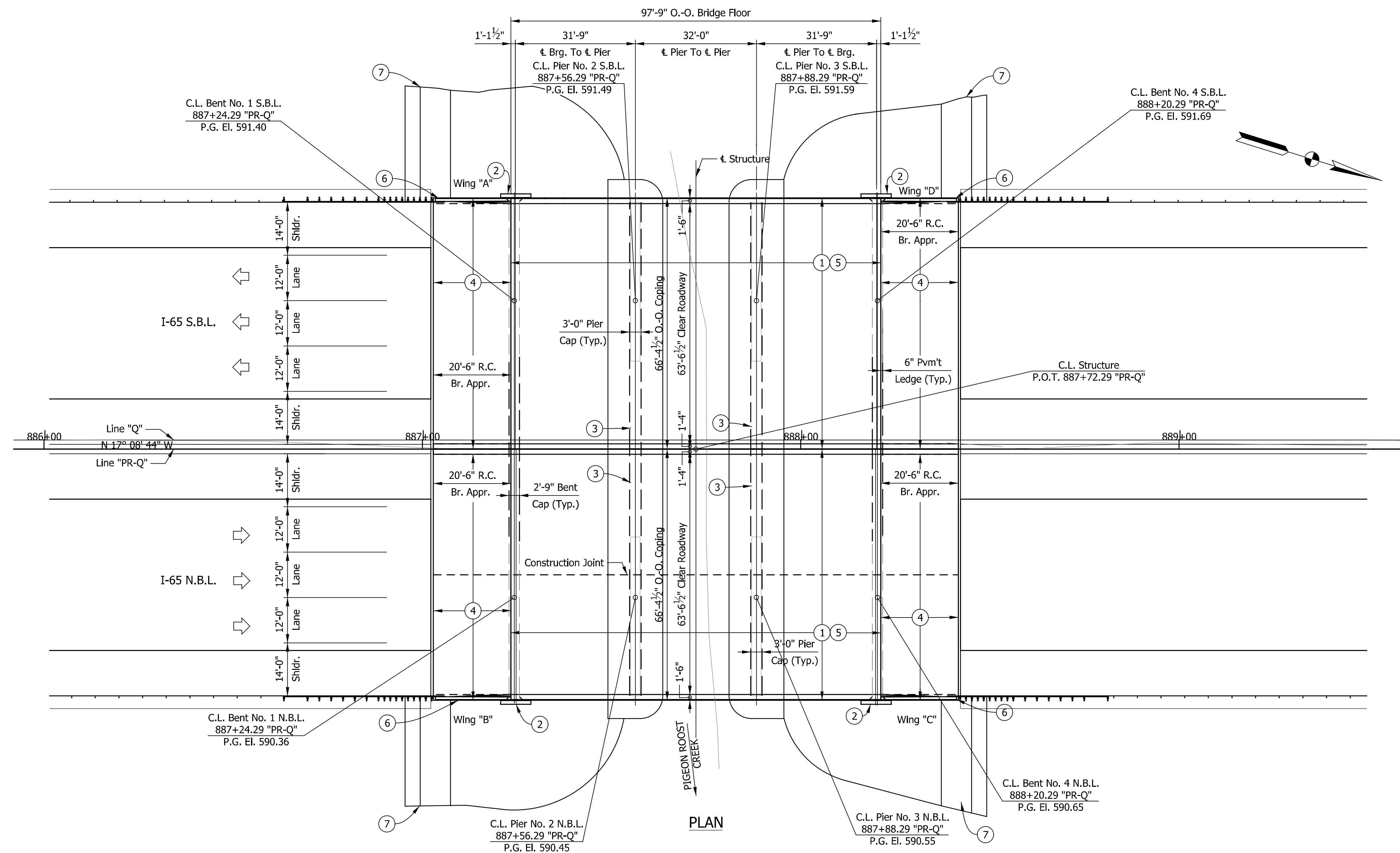

**TWIN CONTINUOUS COMPOSITE PRESTRESSED
CONCRETE BOX BEAM BRIDGE**

3 SPAN: 31'-9", 32'-0", 31'-9" SKEW: SQUARE CLEAR ROADWAY: 63'-6½"
I-65 N.B.L. & S.B.L. OVER PIGEON ROOST CREEK
SCOTT COUNTY

RECOMMENDED FOR APPROVAL	DESIGN ENGINEER	DATE
DESIGNED: DJB	DRAWN: KRW	
CHECKED: RTA	CHECKED: RTA	

**INDIANA
DEPARTMENT OF TRANSPORTATION**

GENERAL PLAN

HORIZONTAL SCALE	BRIDGE FILE
1/16" = 1'-0"	I65-024-04229 CNBL & CSBL
VERTICAL SCALE	DESIGNATION
1/16" = 1'-0"	2001604 & 2001605
SURVEY BOOK	SHEETS
ELECTRONIC	13 of 17
CONTRACT	PROJECT
R-41529	1700135

Indiana State Dept. of Transportation

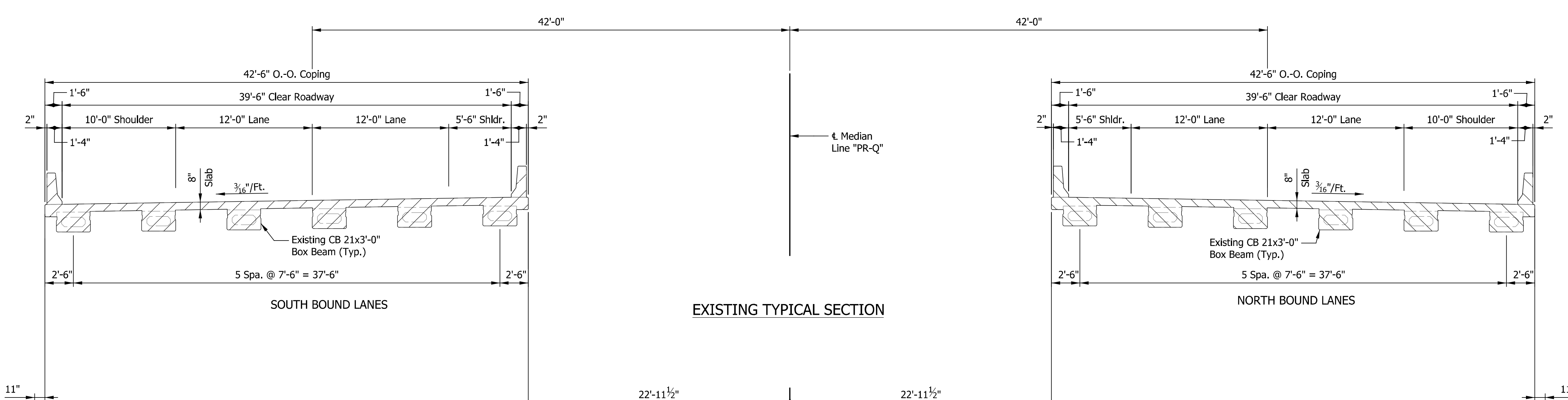

EXISTING TYPICAL SECTION

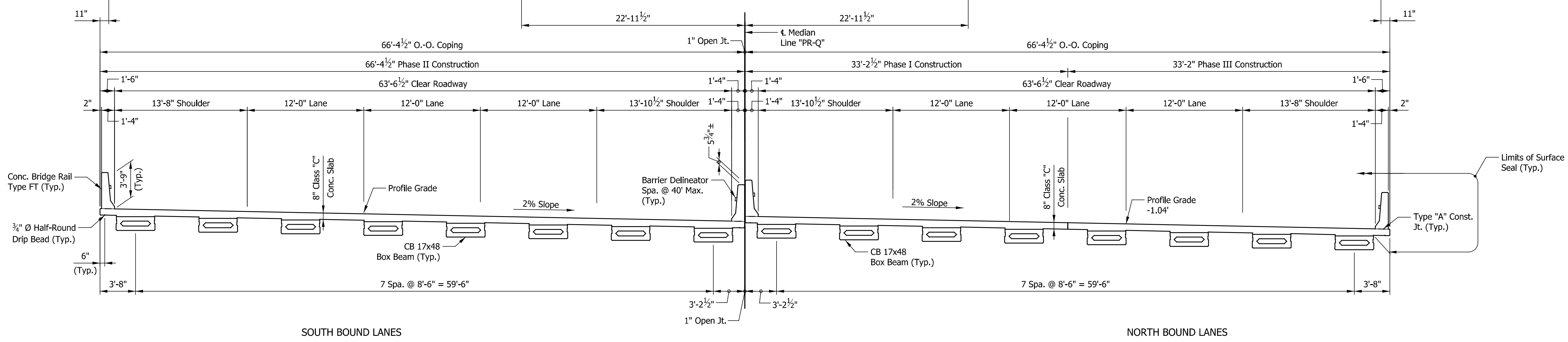

PROPOSED TYPICAL SECTION

TWIN CONTINUOUS COMPOSITE PRESTRESSED CONCRETE BOX BEAM BRIDGE
 3 SPAN: 31'-9", 32'-0", 31'-9" SKEW: SQUARE CLEAR ROADWAY: 63'-6 1/2"
 I-65 N.B.L. & S.B.L. OVER PIGEON ROOST CREEK
 SCOTT COUNTY

RECOMMENDED FOR APPROVAL	DESIGN ENGINEER	DATE
DESIGNED: DJB	DRAWN: KRW	
CHECKED: RTA	CHECKED: RTA	

INDIANA
 DEPARTMENT OF TRANSPORTATION
 GENERAL PLAN

HORIZONTAL SCALE	BRIDGE FILE
3/16" = 1'-0"	I65-024-04229 CNBL & CSBL
VERTICAL SCALE	DESIGNATION
3/16" = 1'-0"	2001604 & 2001605
SURVEY BOOK	SHEETS
ELECTRONIC	14 of 17
CONTRACT	PROJECT
R-41529	1700135

I:\indiana\projects\indiana\shades.tbl

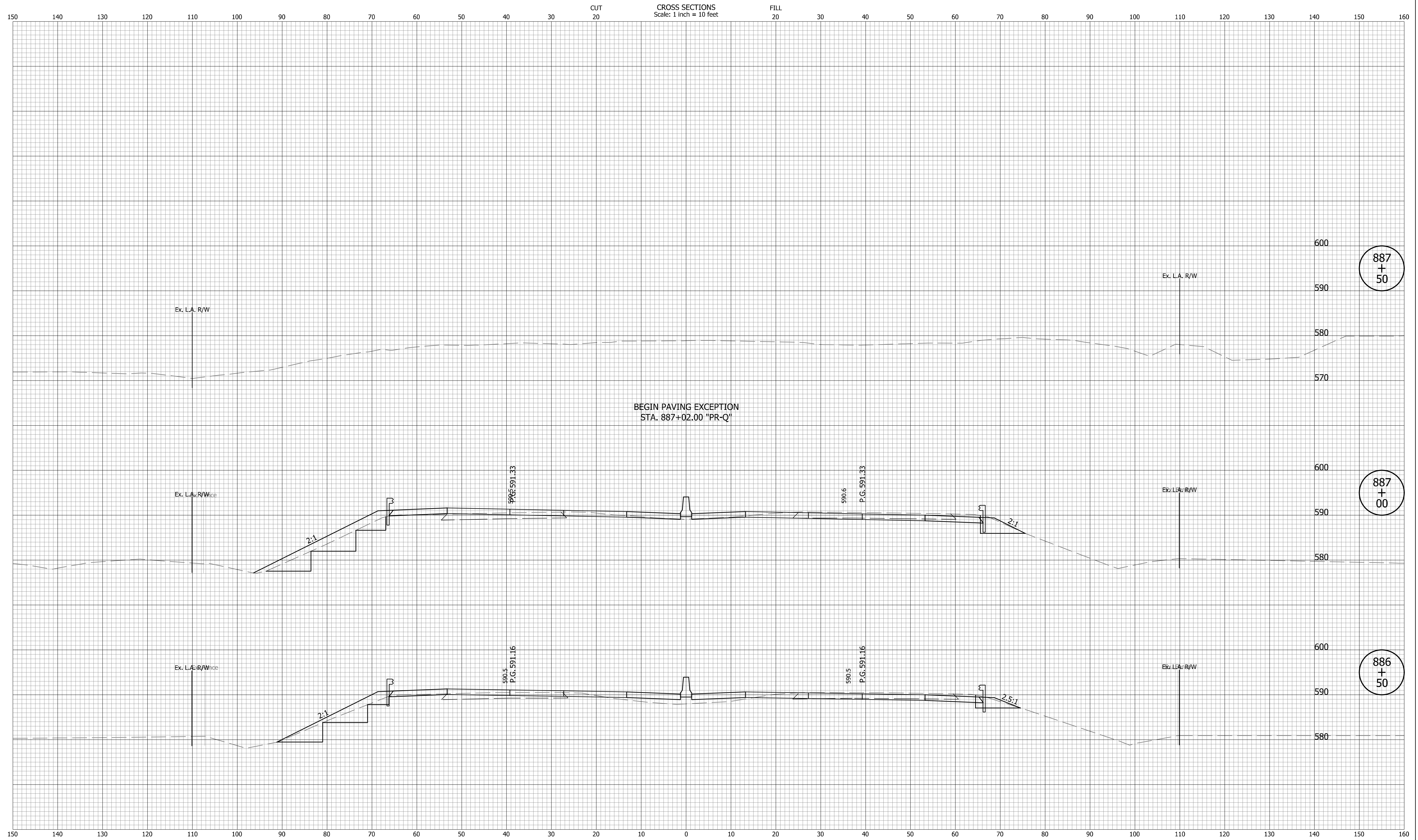

887
+
50

887
+
00

886
+
50

DATE	REVISION

FOR INFORMATION ONLY

RECOMMENDED FOR APPROVAL	DESIGN ENGINEER	MM/DD/20YY
DESIGNED: ZLM	DRAWN: BAD	DATE
CHECKED: CDH	CHECKED: PKW	

INDIANA
DEPARTMENT OF TRANSPORTATION

CROSS SECTIONS
LINE "PR-Q"

HORIZONTAL SCALE	BRIDGE FILE
1" = 10'	I65-024-04229 CNBL & CSBL
VERTICAL SCALE	DESIGNATION
1" = 10'	2001604 & 2001605
SURVEY BOOK	SHEETS
ELECTRONIC	16 of 17
CONTRACT	PROJECT
R-41529	1700135

